



pearson
ferrier®



16 ST. ANNES STREET
Bury, BL9 6LP
£150,000

16 ST. ANNES STREET

Property at a glance

- IDEAL FIRST TIME BUY
- POPULAR CHESHAM AREA OF BURY
- CLOSE TO CLARENCE PARK & BURY LIDO
- NO ONWARD CHAIN
- GOOD SELECTION OF SHOPS & SCHOOLS
- LARGE REAR YARD AREA

A mid terraced property located a short walk from Clarence Park and Bury Lido in the popular Chesham area of Bury. The property comprises two double bedrooms, family bathroom, lounge, kitchen/diner and vestibule. There is a garden to the front and a good sized yard to the rear. The property is located on a quiet side street with good public transport links and access to both Bury centre and motorway links. Viewings are essential to appreciate the location and standard of accommodation on offer.

Tenure - Leasehold balance of 999 years

EPC - D

Council Tax - A





GROUND FLOOR
348 sq.ft. (32.4 sq.m.) approx.

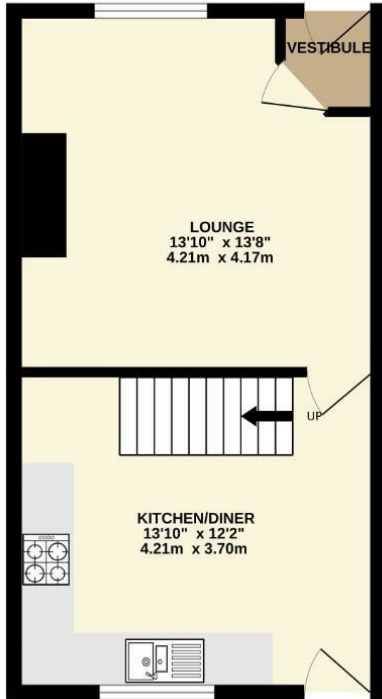

1ST FLOOR
350 sq.ft. (32.5 sq.m.) approx.

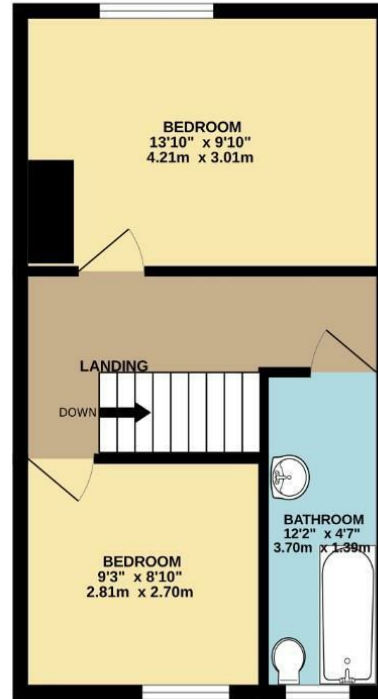

TOTAL FLOOR AREA: 698 sq.ft. (64.8 sq.m.) approx.

Whilst every attempt has been made to ensure the accuracy of the floorplan contained here, measurements of doors, windows, rooms and any other items are approximate and no responsibility is taken for any error, omission or mis-statement. This plan is for illustrative purposes only and should be used as such by any prospective purchaser. The services, systems and appliances shown have not been tested and no guarantee as to their operability or efficiency can be given.
Made with Metropix 92024

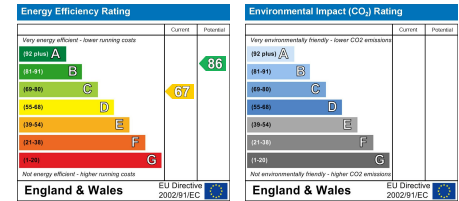

Bury Office
435/7 Walmsley Road, Bury, Lancashire, BL9 5EU
Telephone: 0161 764 4440
Fax: #
Email: bury@pearsonferrier.co.uk

www.pearsonferrier.co.uk



All statements contained in these particulars are for indicative purposes only and are made without responsibility on the part of Pearson Ferrier and the vendors of this property and are not to be relied on as statements or representations of fact. Potential purchasers should satisfy themselves by inspection or otherwise as to the accuracy of such details contained in these particulars.