

FOR SALE

Gwynfa, 3 Greenfields, Pontesbury, Shrewsbury, SY5 0RX

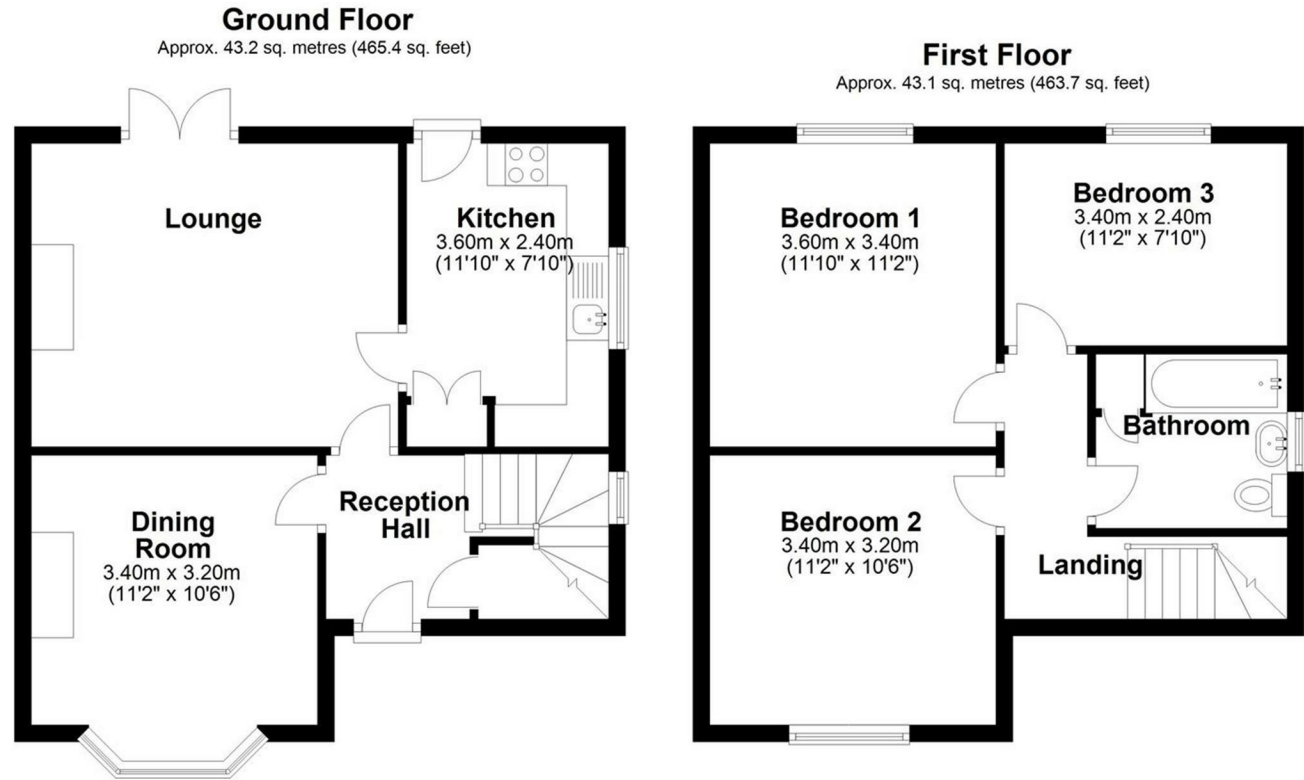

Total area: approx. 86.3 sq. metres (929.1 sq. feet)
3 Greenfields

FOR SALE

Offers in the region of £310,000

Gwynfa, 3 Greenfields, Pontesbury, Shrewsbury, SY5 0RX

Property to sell? We would be delighted to provide you with a free no obligation market assessment of your existing property. Please contact your local Halls office to make an appointment. **Mortgage/financial advice.** We are able to recommend a completely independent financial advisor,

who is authorised and regulated by the FCA. Details can be provided upon request. **Do you require a surveyor?** We are able to recommend a completely independent chartered surveyor. Details can be provided upon request.

Energy Performance Rating

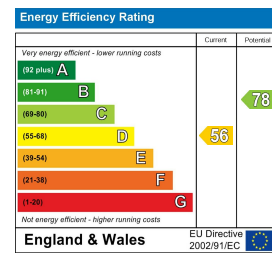

A beautifully presented and highly desirable mature semi detached house, providing well proportioned rooms and set with delightful large gardens in this popular rural village.



01743 236 444

Shrewsbury Sales
2 Barker Street, Shrewsbury, Shropshire, SY1 1QJ
E: shrewsbury@hallsgb.com



IMPORTANT NOTICE. Halls Holdings Ltd and any joint agents for themselves, and for the Vendor of the property whose Agents they are, give notice that: (i) These particulars are produced in good faith, are set out as a general guide only and do not constitute any part of a contract (ii) No person in the employment of or any agent of or consultant to Halls Holdings has any authority to make or give any representation or warranty whatsoever in relation to this property (iii) Measurements, areas and distances are approximate, Floor plans and photographs are for guidance purposes only (photographs are taken with a wide angled / zoom lenses) and dimensions shapes and precise locations may differ (iv) It must not be assumed that the property has all the required planning or building regulation consents. Halls Holdings, Bowmen Way, Shrewsbury, Shropshire SY4 3DR. Registered in England 06597073.

MILEAGES: Shrewsbury 8.3 miles and Telford 21.5 miles. All distances are approximate.



2 Reception Room/s



3 Bedroom/s



1 Bath/Shower Room/s



- Popular rural village
- Beautifully presented
- Attractively appointed
- Well proportioned rooms
- Large gardens
- Driveway parking

DESCRIPTION

3 Greenfields is a highly desirable and beautifully presented mature semi-detached house, which provides rooms of pleasing dimensions throughout. The ground floor offers two versatile reception rooms and the kitchen which has a stable style door out to the rear gardens. To the first floor, there are three bedrooms served by the bathroom which has a white suite. Outside, there is a generous driveway parking tarmac area. The gardens are a most attractive feature and particularly generous to the rear offering large flowing lawns, patio seating areas and abundantly stocked shrubbery beds and borders. There is also a useful range of outbuildings.

ACCOMMODATION

COVERED PORCH

With quarry tiled floor. Part glazed panelled entrance door into:

ENTRANCE HALL

With quarry tiled floor. Built in under stair storage cupboard. Staircase rising to first floor.

DINING ROOM

With exposed pine boarded flooring. Attractive feature fireplace with inset tiling. Picture rail. Bay window.

LOUNGE

With feature fireplace with open grate. Picture rail. Twin glazed French doors leading out to a generous sun terrace with lovely gardens beyond.

KITCHEN

With quarry tiled floor. Providing an extensive range of attractive eye and base level units comprising cupboards and drawers. A generous work surface area over and incorporating a one and a half bowl sink unit and drainer with mixer tap over. Part tiled walls and tiled splash. Integral electric oven and grill with 4 ring gas hob unit over and fitted filter hood. Integral fridge. Ceiling downlights. Additional built in pantry style cupboards and part glazed stable style UPVC access door to rear garden.

FIRST FLOOR LANDING

With access to loft space.

BEDROOM 1

With picture rail. Window with attractive aspect.

BEDROOM 2

With ceiling rose. Lovely view over garden.

BEDROOM 3

With exposed pine boarded floor. Picture rail. Views over rear garden.

BATHROOM

Providing a white suite comprising low level WC, wash hand basin set in vanity unit with storage cupboards under. Panelled bath with mains fed shower over. Built in airing/linen cupboard.

OUTSIDE

The property is approached over a tarmac driveway which provides generous parking to the front and also extends down the side of the property with room for additional vehicles.

THE GARDENS

To the front the gardens offer neatly maintained lawns. A timber side access gate leads through to the rear where the majority of the gardens can be found. Sitting adjacent to the rear of the living room and kitchen is a flagged entertaining area, with adjoining blue bricked pathway, which gives access to a range of outbuildings which include:

- * Garden WC - with blue brick flooring and low level WC
- * Utility - with space and plumbing for washing machine. Space for tumble dryer. Fitted worktop. Eye level storage cupboards.
- * Garden Store - with power and light points.

The majority of the gardens are then laid to large flowing lawns flanked by established hedgerows and well stocked shrubbery beds and borders containing a number of different specimen plants and trees. A generous timber and felt summer house can be found with a nature pond positioned beyond. A central concrete pathway leads to the top section of garden where a further variety of trees can be found together with raised vegetable/fruit growing beds.

GENERAL REMARKS

FIXTURES AND FITTINGS

Only those items described in these particulars are included in the sale.

SERVICES

Mains water, electricity, gas and drainage are understood to be connected. None of these services have been tested.

TENURE

Freehold. Purchasers must confirm via their solicitor.

COUNCIL TAX

The property is currently showing as Council Tax Band C. Please confirm the council tax details via Shropshire Council on 0345 6789002 or visit www.gov.uk/council-tax-bands.

VIEWINGS

Halls, 2 Barker Street, Shrewsbury, Shropshire SY1 1QJ. Tel: 01743 236444. Email: shrewsbury@hallsgb.com