

**NOTES**

This drawing is the copyright of Quattro Design Architects Ltd and should not be reproduced in whole or in part without written permission. Only figured dimensions to be used for construction. Check all dimensions on site. Any discrepancies are to be reported to the Architect as soon as possible.

**REVISIONS**

REV. DATE - DRAWN - CHECKED: NOTES

-: 24.09.21- JLP - CC:  
Drawing created.  
A: 28.02.22 - JLP - CC:  
Proposed building position and massing amended to follow existing building line.

**Schedule of Accommodation:**

- 1no. 1B2P Flat @ 42 sqm
- 1no. 1B2P Flat @ 51 sqm
- 4no. 2B3P Flat @ 63 sqm
- 2no. 2B4P Flat @ 70 sqm
- 1no. 2B4P Flat @ 61 sqm

Total : 9 Units

**Key:**

- Site Boundary
- Road
- Shared Surface
- Paving
- Grass
- Close board timber fencing 1800mm
- Close board timber fencing 900mm

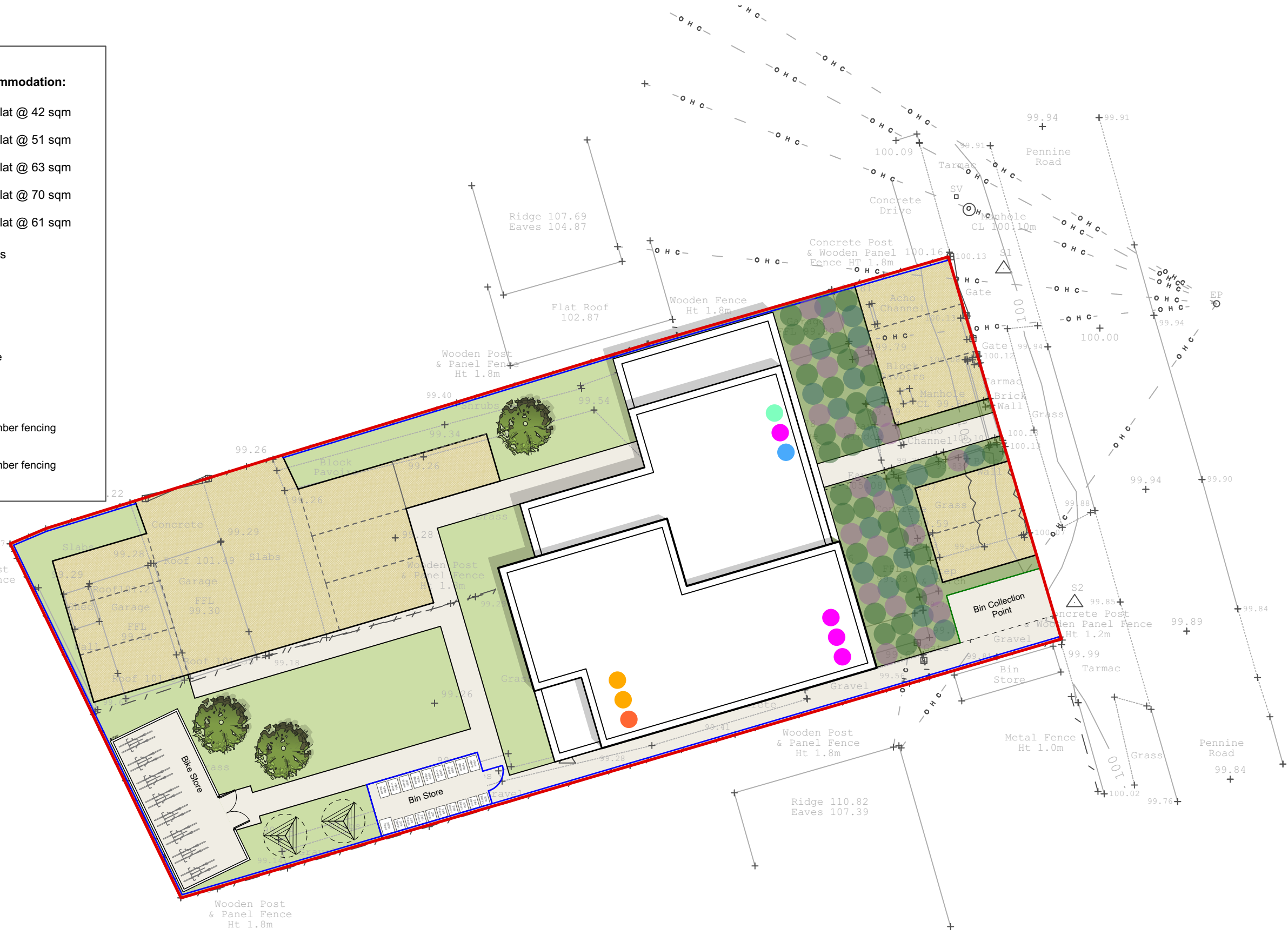

**DRAWING TITLE**

Proposed Site Layout

**PROJECT**

76-78 Pennine Road,  
Cheltenham

**CLIENT**

SR Developments

**SCALE** 1:200@A3  
**DATE** Sep 2021



**DRAWING NO.** 6624-P-10  
**REV** A

