



27a New Street, Salisbury



A comfortable, charming and fully renovated 2 bedroom maisonette in the city centre with a communal courtyard and views of the Cathedral.

27A New Street,
Salisbury, SP1 2PH

PCM
£1,200 PCM



Set in a period Grade II listed building, the flat is accessed through an attractive communal courtyard and staircase/landing with private entrance.

Features

- 2 bedrooms
- Cathedral views
- Modern shower room
- City centre
- Communal courtyard
- Well presented
- Fully renovated
- Integrated appliances

Tenancy & Restrictions

To be let unfurnished on an Assured Shorthold Tenancy (minimum term of 12 months, thereafter on a monthly basis). No smokers or sharers.

EPC Rating

E (42)

Outgoings

Council Tax: Wiltshire £2350.54 (2025/26) Band C

Size

745.00 sq ft

The property has been fully renovated, opening into the brand new comfortable kitchen, equipped with integrated appliances and larder, and the hallway which flows into the spacious sitting room looking out over the bustling New Street, benefitting from an abundance of built-in storage. Upstairs hosts the two generous double bedrooms and modern shower room, with the rear windows providing an outstanding view of the Cathedral overlooking the courtyard.

This first and second floor flat forms part of a large period property set in an attractive row of historic buildings backing on to The Close's curtain wall, and is located right in the heart of the cathedral city of Salisbury. New Street is a vibrant street with a variety of pubs, restaurants and independent shops, being a stone's throw from the city centre and a short walk from Salisbury's excellent range of cultural, education and shopping amenities. This is also within walking distance of the mainline train station to London Waterloo (approximately 90 minutes).



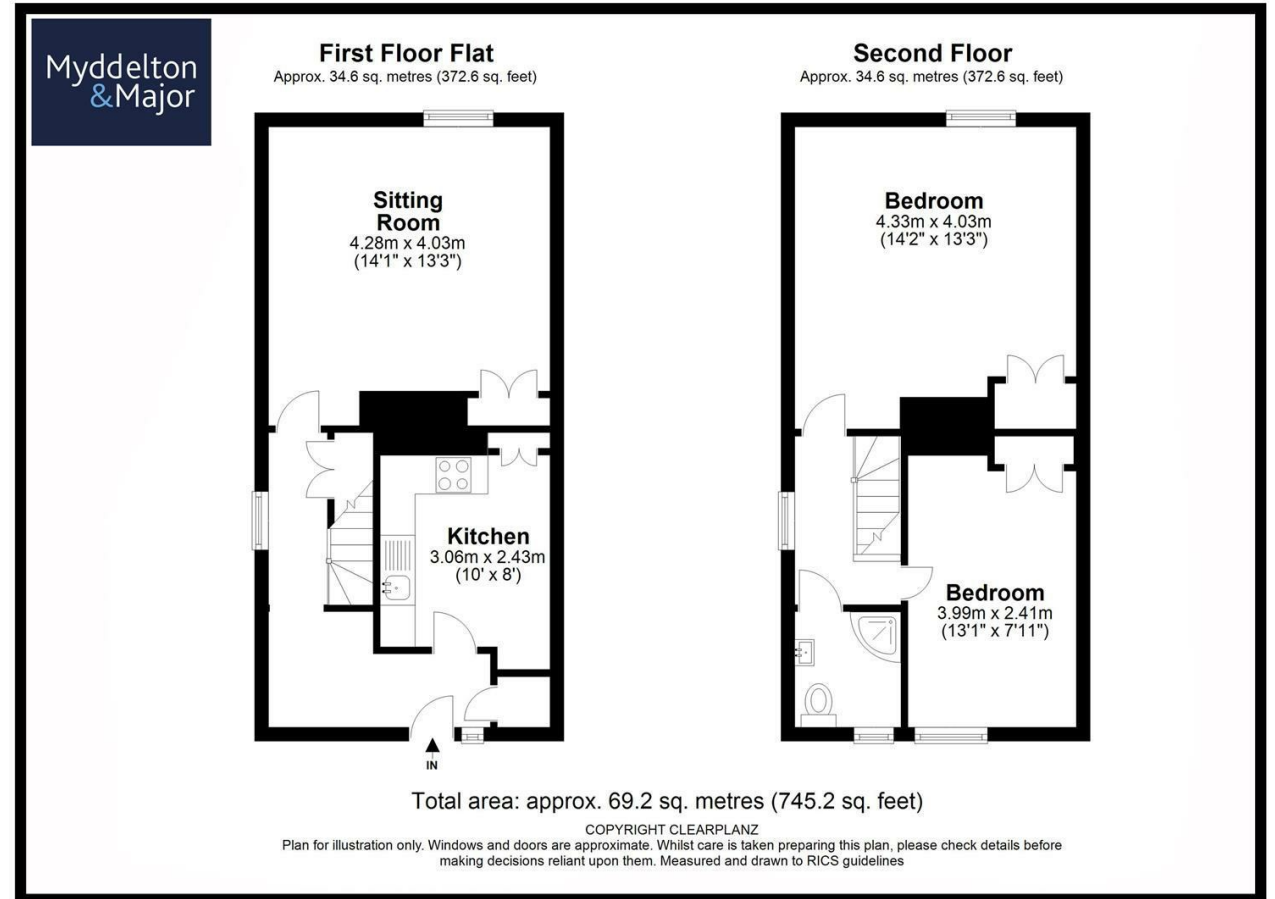
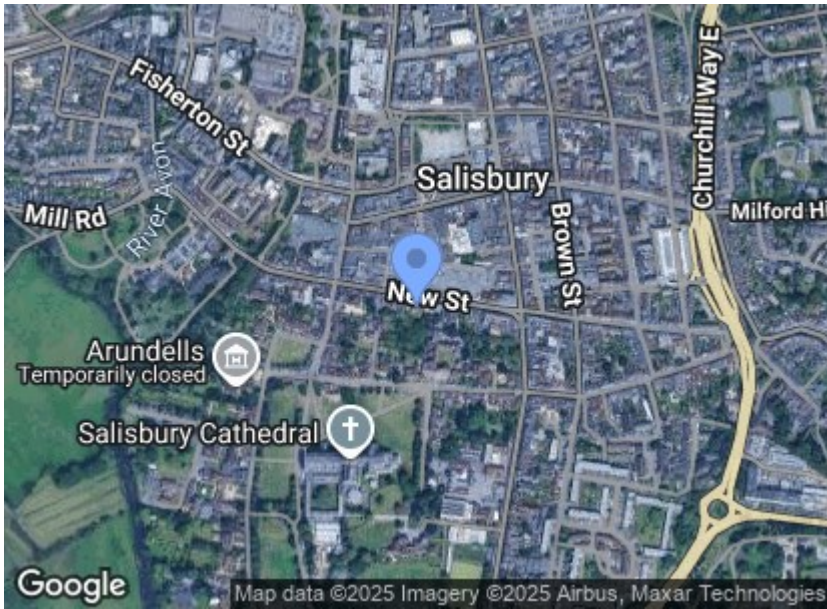

Disclaimer Notice Myddelton & Major and their clients give notice that:- i) they have no authority to make or give any representations or warranties in relation to the property, ii) these particulars do not form part of any offer or contract and must not be relied upon as statements or representations of fact. iii) any areas, measurements or distances are approximate. The text, photographs and plans are for guidance only and are not necessarily comprehensive. It should not be assumed that the property has all the necessary planning, Building Regulation or other consents, and, any services, equipment or facilities have not been tested by the agent. iv) the purchaser must satisfy themselves by inspection or otherwise.