



Flat 3, Willetts Court, Salisbury





## A modern and stylish two bedroom maisonette within easy reach of the city centre.

Flat 3 Willetts Court,  
Salisbury, SP2 7HX

PCM  
£1,250 PCM



A recently converted former office building creating a stylish, light and comfortable two bedroom first floor maisonette, with good quality fixtures and fittings, private parking, close to the city centre.

The flexible accommodation is well laid out with a ground floor entrance hall with stairs to the first floor landing, off which are two double bedrooms, a bathroom and open-plan kitchen/living room. within a private front driveway is allocated parking for one vehicle and an electric charging point.

### Features

- Recently converted
- Two bedrooms
- Car parking space
- Walking distance to mainline station
- Integrated appliances
- Electric car charging point
- Open-plan kitchen/living room
- Private courtyard

### Tenancy & Restrictions

To be let unfurnished on an Assured Shorthold Tenancy (minimum term of 12 months, thereafter on a monthly basis). No smokers or sharers.

### Outgoings

Council Tax: Wiltshire £2056.73 (2025/26) Band B

### EPC Rating

E (51)

### Size

642 sq ft

Nursery Road is a level walk from Salisbury city centre which boasts a wide range of retail, recreational and cultural amenities, including a well-thought of Playhouse and twice-weekly charter market, with a plethora of restaurants, shopping, and leisure facilities. There are a number of primary and secondary schools, both private and state, including boys and girls grammar schools.

Salisbury has excellent road links to London, Southampton and Bournemouth, and provides direct trains to London Waterloo from Salisbury mainline railway station (journey time approximately 90 minutes).





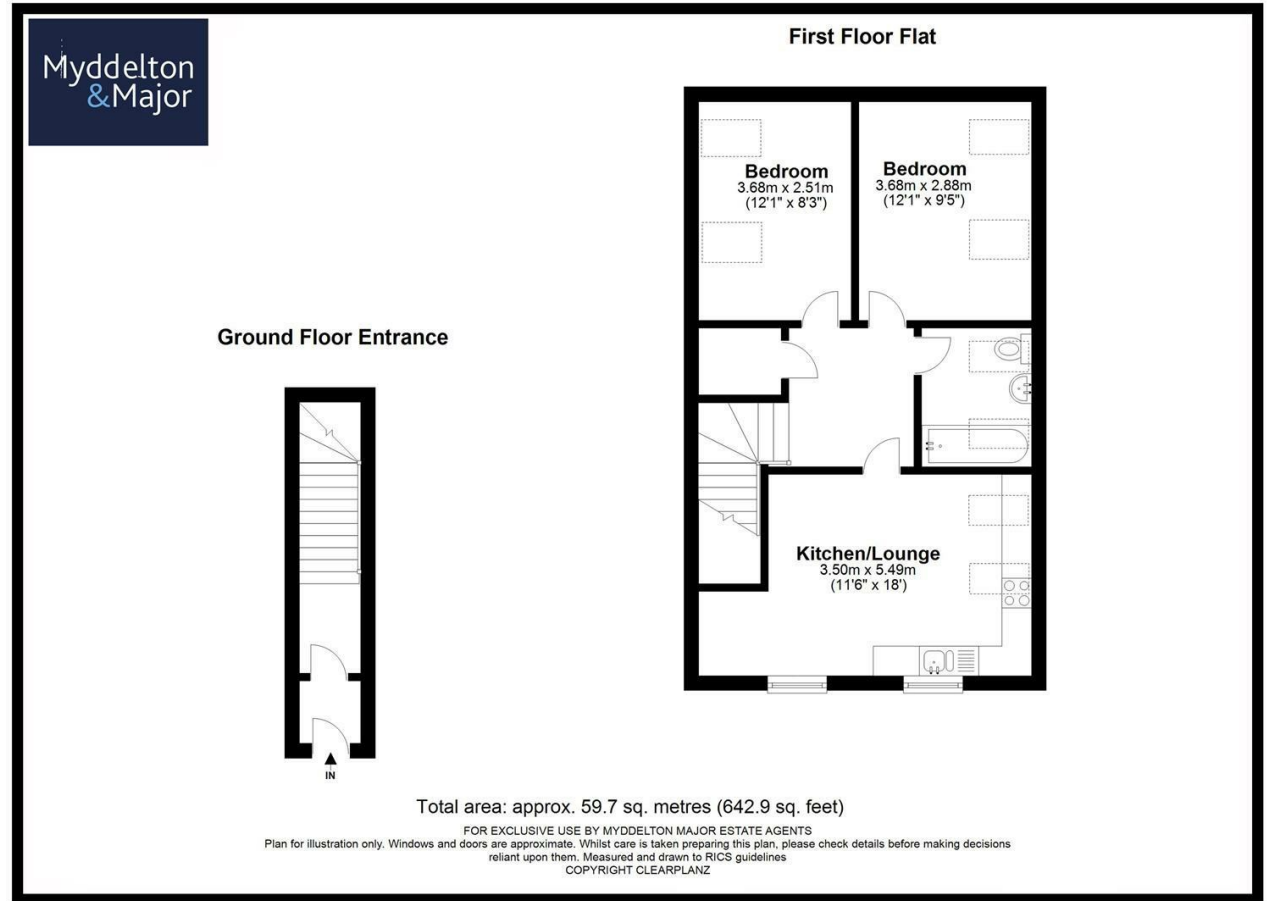

**Disclaimer Notice** Myddelton & Major and their clients give notice that:- i) they have no authority to make or give any representations or warranties in relation to the property, ii) these particulars do not form part of any offer or contract and must not be relied upon as statements or representations of fact. iii) any areas, measurements or distances are approximate. The text, photographs and plans are for guidance only and are not necessarily comprehensive. It should not be assumed that the property has all the necessary planning, Building Regulation or other consents, and, any services, equipment or facilities have not been tested by the agent. iv) the purchaser must satisfy themselves by inspection or otherwise.