

Canberra Way, Balderstone OL11 2EL

Offers invited in excess of £115,000



Adamsons Barton Kendal are pleased to present this two-bedroom first floor apartment, located within a popular residential development on Canberra Way, Balderstone. Ideally situated close to Rochdale town centre and within easy reach of popular bus routes, the property offers convenient access to local amenities, transport links and commuter routes, making it an excellent choice for a range of buyers.

**Head Office - 122 Yorkshire Street
ROCHDALE
Lancashire
OL16 1LA**

Tel : (01706) 653214

The apartment briefly comprises a welcoming entrance hallway leading to a spacious open-plan kitchen and living area, featuring a fitted kitchen and Juliet balcony that allows plenty of natural light. The accommodation includes a master bedroom with fitted wardrobes and en-suite shower room, a further double bedroom, and a family bathroom complete with bath, overhead shower, wash basin and WC. Early viewing is highly recommended, as this attractive apartment would be ideal for first-time buyers or investors alike.

THE ACCOMMODATION COMPRISES:

(Measurements are approximate to the nearest 0.1m and for guidance only and they should not be relied upon for the fitting of carpets or the placement of furniture). No checks have been made on any fixtures and fittings or services where connected (water, electricity, gas and drainage) heating appliances or any other electrical or mechanical equipment in this property).

Ground Floor

Lounge - 4.0 x 3.2 metres

Kitchen - 4.5 x 2.2 metres

Bathroom - 1.7 x 2.2 metres

Master Bedroom - 3.5 x 3.4 metres

En Suite - 1.8 x 1.4 metres

Bedroom 2 - 3.4 x 2.4 metres





ADDITIONAL INFORMATION

Council Tax Band - B

Energy Performance Cert - TBC

Tenure - TBC

GROUND FLOOR
726 sq.ft. (67.4 sq.m.) approx.

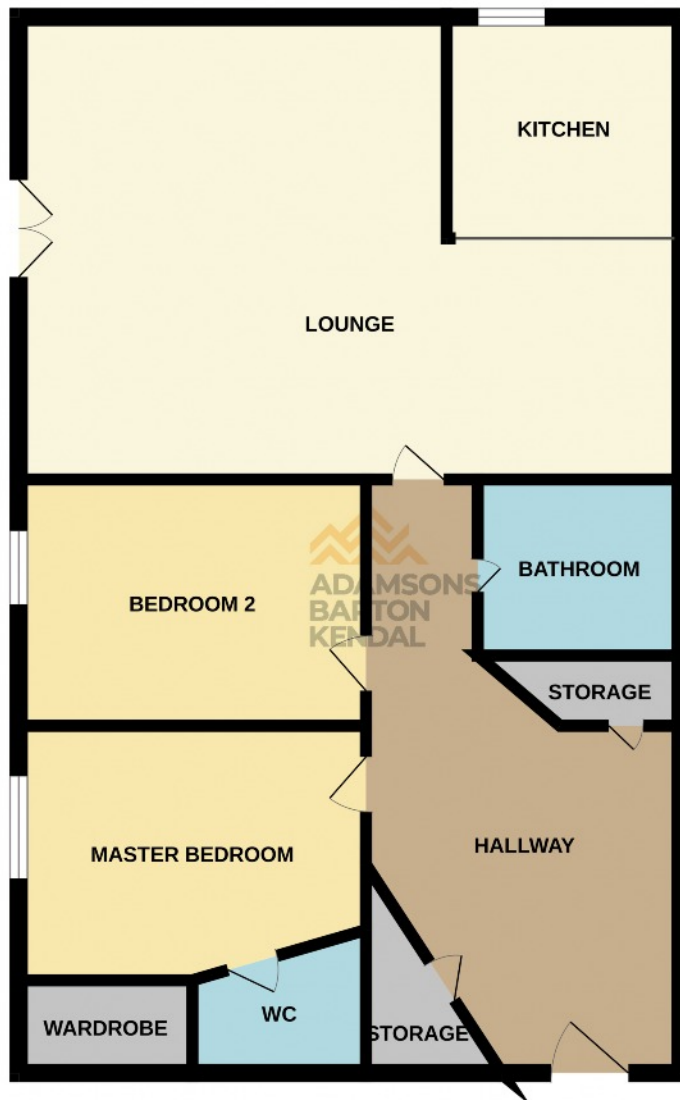

TOTAL FLOOR AREA : 726 sq.ft. (67.4 sq.m.) approx.

Whilst every attempt has been made to ensure the accuracy of the floorplan contained here, measurements of doors, windows, rooms and any other items are approximate and no responsibility is taken for any error, omission or mis-statement. This plan is for illustrative purposes only and should be used as such by any prospective purchaser. The services, systems and appliances shown have not been tested and no guarantee as to their operability or efficiency can be given.
Made with Metropix ©2026

w - abkproperty.co.uk

e - sales@abkproperty.co.uk

Adamsons Barton Kendal for themselves and for the vendors or lessors of this property whose agents they are, give notice that (i) the particulars are set out as a general outline only for the guidance of intending purchasers or lessees, and do not constitute, nor constitute part of an offer or contract; (ii) all descriptions, dimensions, references to condition and necessary permission for use and occupation, and other details are given without responsibility and any intending purchasers or tenants should not rely on them as statements or representations of fact but must satisfy themselves by inspection or otherwise as to the correctness of each of them; (iii) no person in the employment of Adamsons Barton Kendal has any authority to make or give any representations or warranty in relation to this property.

Due to a change in the legislation as from 1st March 2004 we are required to check your identification. This is a legal requirement and applies to all Estate Agents: (i) proceeding to market any property; and (ii) should you make an offer on one of our properties and this offer becomes acceptable, before we can instruct Solicitors to proceed with the transaction. Suitable identification can be: Current signed Passport; New style Driving Licence with photograph; Inland Revenue Tax notification