



Ending Rake, Healey  
Rochdale OL12 8RP  
OFFERS INVITED IN EXCESS OF £350,000



**ADAMSONS BARTON KENDAL** are delighted to introduce Ending Rake, an exceptionally well presented family home, positioned on a private road directly opposite the picturesque Healey Dell Nature Reserve. This delightful detached cottage is full of charm and character, while benefiting from modern upgrades throughout. Once two separate homes, the property has been carefully converted into a spacious residence featuring four double bedrooms, including a master with en-suite.

Perfectly positioned with easy access to both Rochdale and Rossendale, and within close reach of excellent schools and local amenities in Whitworth, this home is ideally suited for families seeking both tranquility and convenience.

The accommodation briefly comprises: an inviting entrance hallway, a stunning fitted kitchen/breakfast room with a central island, integrated appliances, and under floor heating, a useful utility and storage room, a generous dining area, and a bright, welcoming lounge. Upstairs, you'll find four spacious double bedrooms, a stylish en-suite to the master, and a brand-new, contemporary family bathroom. The entire property has been finished to an exceptional standard with high quality fixtures & fittings throughout and is ready for immediate occupancy.

Outside, the home features a double garage with an electric door providing ample off-road parking, as well as a unique rooftop garden and terrace—perfect for outdoor entertaining—accessed via steps to the side of the garage, although there is potential for the addition of an external door from the master bedroom.

**Ending Rake, Healey, Rochdale OL12 8RP**





Ending Rake, Healey, Rochdale OL12 8RP





Ending Rake, Healey, Rochdale OL12 8RP





Ending Rake, Healey, Rochdale OL12 8RP



# VIEWING STRICTLY BY APPOINTMENT WITH SOLE AGENTS ADAMSONS BARTON KENDAL

GROUND FLOOR  
1130 sq.ft. (105.0 sq.m.) approx.



1ST FLOOR  
774 sq.ft. (71.9 sq.m.) approx.

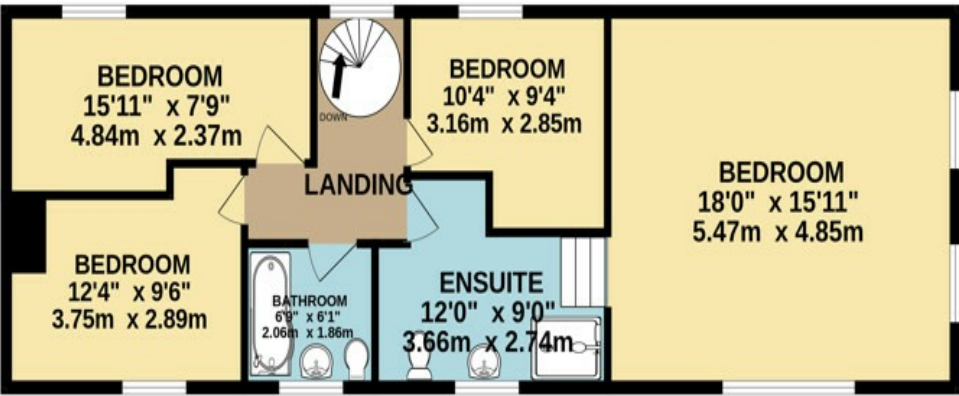

Score	Energy rating	Current	Potential
92+	A		
81-91	B		
69-80	C		72 C
55-68	D		
39-54	E	47 E	
21-38	F		
1-20	G		

TOTAL FLOOR AREA : 1904 sq.ft. (176.9 sq.m.) approx.

Whilst every attempt has been made to ensure the accuracy of the floorplan contained here, measurements of doors, windows, rooms and any other items are approximate and no responsibility is taken for any error, omission or mis-statement. This plan is for illustrative purposes only and should be used as such by any prospective purchaser. The services, systems and appliances shown have not been tested and no guarantee as to their operability or efficiency can be given.

Made with Metropix ©2025

w - [abkproperty.co.uk](http://abkproperty.co.uk) e - [sales@abkproperty.co.uk](mailto:sales@abkproperty.co.uk)

Adamsons Barton Kendal for themselves and for the vendors or lessors of this property whose agents they are, give notice that (i) the particulars are set out as a general outline only for the guidance of intending purchasers or lessees, and do not constitute, nor constitute part of an offer or contract; (ii) all descriptions, dimensions, references to condition and necessary permission for use and occupation, and other details are given without responsibility and any intending purchasers or tenants should not rely on them as statements or representations of fact but must satisfy themselves by inspection or otherwise as to the correctness of each of them; (iii) no person in the employment of Adamsons Barton Kendal has any authority to make or give any representations or warranty in relation to this property.

Due to a change in the legislation as from 1<sup>st</sup> March 2004 we are required to check your identification. This is a legal requirement and applies to all Estate Agents: (i) proceeding to market any property; and (ii) should you make an offer on one of our properties and this offer becomes acceptable, before we can instruct Solicitors to proceed with the transaction. Suitable identification can be: Current signed Passport; New style Driving Licence with photograph; Inland Revenue Tax notification