



## 31 The Meadows, South Cave, Brough, HU15 2HR

£199,950

- Part Furnished
- Spacious Lounge Diner
- Modern Bathroom suite with shower over bath
- Immaculate Semi Detached House
- Kitchen with appliances
- Off Street Parking
- Contemporary feel throughout
- Two Double Bedrooms
- Easily Maintained Garden

**Ground Floor**  
Approx. 34.5 sq. metres (371.1 sq. feet)

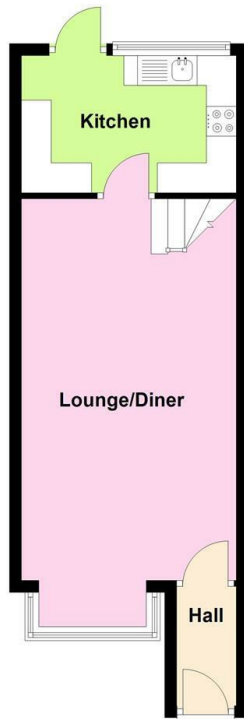

**First Floor**  
Approx. 30.4 sq. metres (327.6 sq. feet)

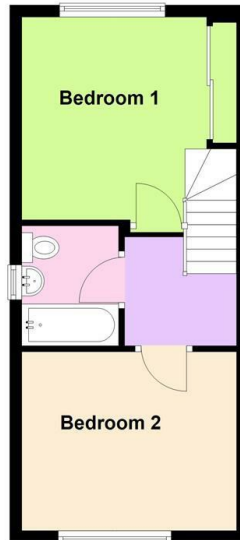

Total area: approx. 64.9 sq. metres (698.7 sq. feet)

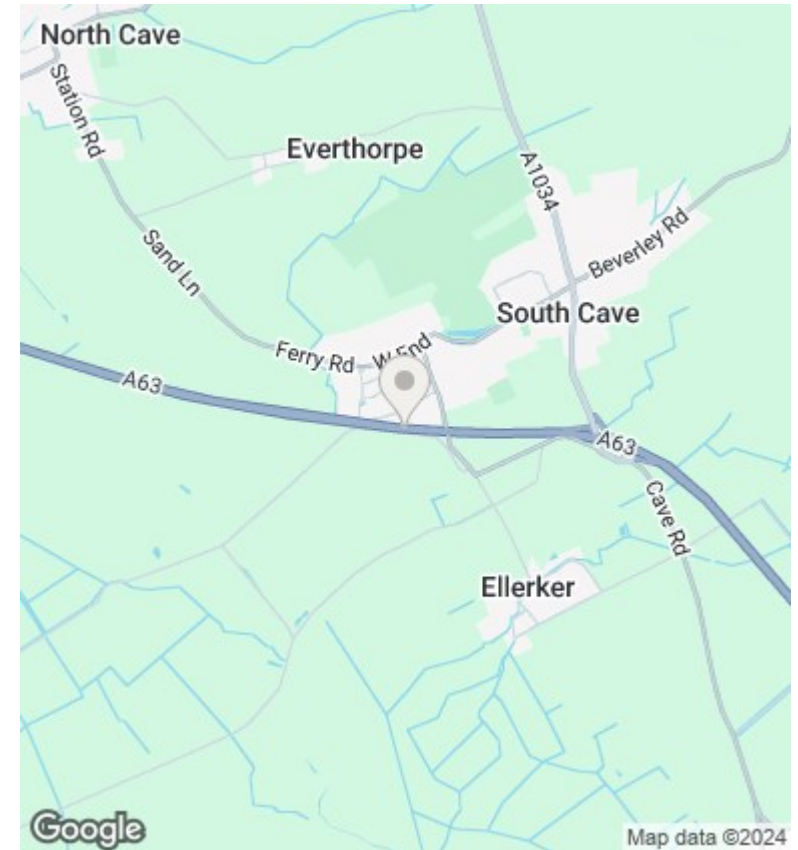

## Directions

## Viewings

Viewings by arrangement only.  
Call 01482307007 to make an appointment.

## Council Tax Band

B

## EPC Rating:

D

Energy Efficiency Rating		Current	Potential
<i>Very energy efficient - lower running costs</i>			
(92 plus) <b>A</b>			<b>84</b>
(81-91) <b>B</b>			
(69-80) <b>C</b>			
(55-68) <b>D</b>		<b>62</b>	
(39-54) <b>E</b>			
(21-38) <b>F</b>			
(1-20) <b>G</b>			
<i>Not energy efficient - higher running costs</i>			
<b>England &amp; Wales</b>		EU Directive 2002/91/EC	