



94 Richmond Road, Hessle, East Yorkshire, HU13 9DN

Offers In The Region Of £129,950

- Mid-Terrace Property
- Spacious Lounge
- Council Tax Band A
- Ideal First Home
- Two Bedrooms
- Contemporary Bathroom Suite
- EPC rating C
- Modern Dining Kitchen
- Rear Enclosed Garden
- Newly Decorated

Ground Floor

Approx. 30.3 sq. metres (326.7 sq. feet)

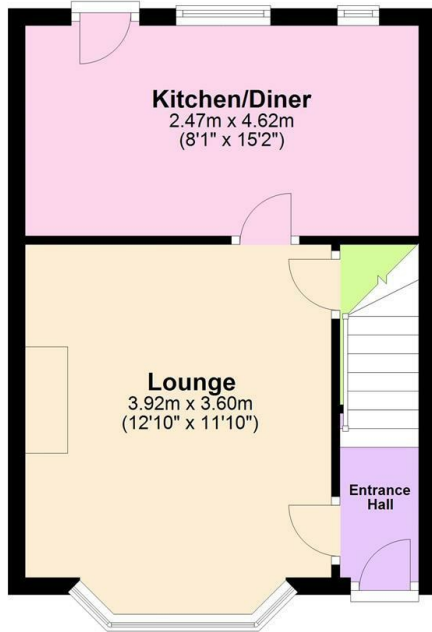

First Floor

Approx. 30.5 sq. metres (328.6 sq. feet)

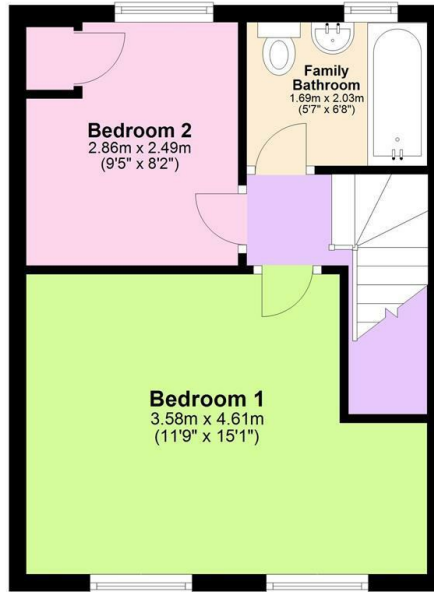

Total area: approx. 60.9 sq. metres (655.3 sq. feet)

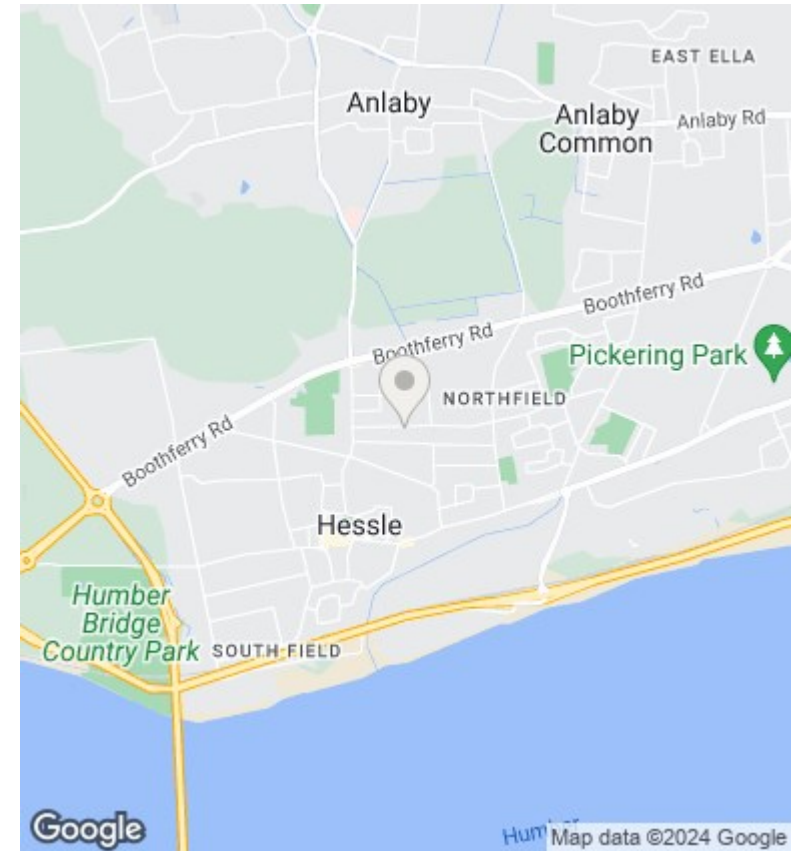

Directions

Viewings

Viewings by arrangement only.
Call 01482307007 to make an appointment.

Council Tax Band

B

EPC Rating:

C

Energy Efficiency Rating		Current	Potential
Very energy efficient - lower running costs			
(92 plus)	A		91
(81-91)	B		
(69-80)	C	71	
(55-68)	D		
(39-54)	E		
(21-38)	F		
(1-20)	G		
Not energy efficient - higher running costs			
England & Wales		EU Directive 2002/91/EC	