



11 Hodgkins Mews, Stanmore

£600,000 Freehold

3 Good Size Bedrooms • 2 Bathrooms (1 En Suite) • Downstairs W/C • 2 Underground Parking Spaces • Short Walk to Stanmore Broadway & Stanmore Station • Council Tax Band: F • Estate Charge Approx: £600.00 per annum • Potential Rental Income Approx. £1900 - £2,000 PCM

The property comprises of a large through lounge opening to a sunny conservatory, fully fitted kitchen, guest cloakroom, master bedroom with en suite, family bathroom as well as two allocated underground parking spaces.

Council Tax band: F

Tenure: Freehold



- 3 Good Size Bedrooms
- 2 Bathrooms (1 En Suite)
- Downstairs W/C
- 2 Underground Parking Spaces
- Short Walk to Stanmore Broadway & Stanmore Station
- Council Tax Band: F
- Estate Charge Approx: £600.00 per annum
- Potential Rental Income Approx. £1900 - £2,000 PCM







GROUND FLOOR

RECEPTION ROOM	24'6 x 13'
KITCHEN	8'7 x 7'9

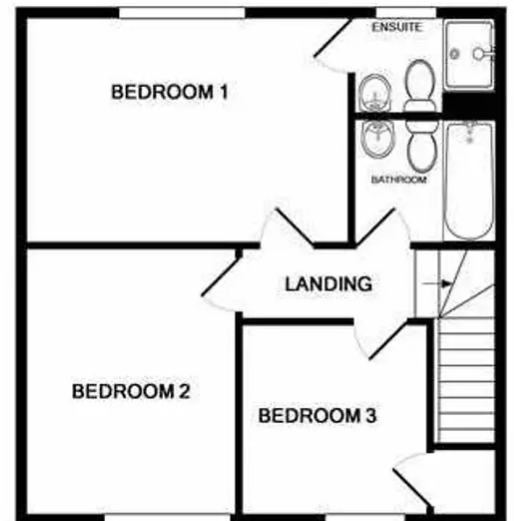

1ST FLOOR

BEDROOM 1	14'4 x 9'9
BEDROOM 2	11'9 x 10'2
BEDROOM 3	8'2 x 6'10
BATHROOM	5'7 x 5'7
EN SUITE	7' x 4'4

You can include any text here. The text can be modified upon generating your brochure.