



## 10 Fearnley Mill Drive

Colnebridge, Huddersfield, HD5 0RD

**£725 PCM**



\*\*\*2 BEDROOM 1ST FLOOR APARTMENT\*\*\*MODERN LIVING\*\*\*EXCELLENT TRANSPORT LINKS\*\*\*

Lovely 2 DOUBLE bedroom 1st floor apartment which has dedicated parking. This apartment comprises of; entrance hall, open plan living kitchen, 2 x bedrooms and bathroom. Located with easy access to Huddersfield and M62 motorway.\*\*\*\*\*Contact YORKSHIRE RESIDENTIAL 012924 501333 to arrange a viewing\*\*\*\*\*



Entrance Hall

Laminate wooden flooring and electric wall heater.

Living Kitchen

19'4" x 10' ext to 14'9"

Wall base and display units with integrated fridge freezer, auto washing machine, oven, hob, extractor hood. Laminated wooden flooring and electric wall heater.

Double Bedroom 1

8'8" ext to 10'5" x 14'11"

Laminate wooden flooring and electric wall heater.

Double Bedroom 2

Electric wall heater.

Bathroom

3 piece white suite comprising of a low flush wc, pedestal wash hand basis, panelled bath with shower over and screen. Complimentary tiled walls and heated towel rail.

Exterior

Dedicated parking space right outside the main entrance.

Area Map



Floor Plans

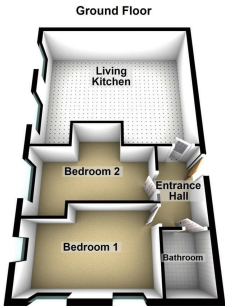

Energy Efficiency Graph

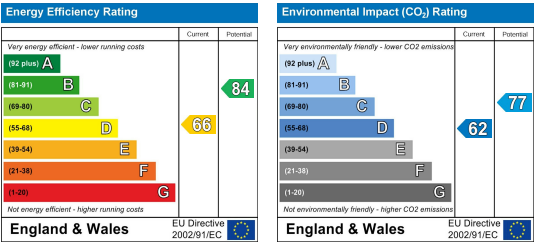

These particulars, whilst believed to be accurate are set out as a general outline only for guidance and do not constitute any part of an offer or contract. Intending purchasers should not rely on them as statements of representation of fact, but must satisfy themselves by inspection or otherwise as to their accuracy. No person in this firms employment has the authority to make or give any representation or warranty in respect of the property.