



Eaton Quarters, BN2

Guide Price £375,000 - £400,000

**ASTON**  
**VAUGHAN**



## INTRODUCING

# Eaton Quarters, BN2

2 Bedrooms | 1 Bathroom | 1 Reception Room  
664 Sq Ft | Newly Renovated Lower Ground Apartment

Tucked away off Kemptown Seafront, yet conveniently close to the amenities within the 'village' this two-bedroom apartment is ideally located to enjoy everything this vibrant coastal city has to offer. Formed from the entire lower ground floor of an elegant Victorian townhouse, it bears the generous proportions of the era with high ceilings and wide bay sash windows. Having recently undergone extensive renovations, it has been brought back to its former glory, reinstating period features and renewing the workings of the building to ensure it lasts for many more years to come. The interior design is immaculate, where only the finest fittings and finishes have been used to create versatile and stylish spaces for relaxation and entertaining in style, leading out to a sweet and sunny courtyard garden.

The entire building has been converted and renovated in recent months with the exterior being a fine indicator for the quality finish to be found inside. Classically Victorian, its architectural features sit picked out in white against a sage façade, bathed in natural light from the west.

This property benefits from its own street entrance due to its lower ground floor position down a few stone steps. Stepping inside, it feels immediately light and airy with natural light streaming in along the corridor from the open plan living room and from the principal bedroom to the left. It is clearly a beautifully renovated property, using light calico and stone tones for the walls, paired with pale engineered oak floors and white woodwork features. This classic palette ideally suits all styles of furnishing and works together with the warmer metallic accents found within the wall sockets and fittings within the kitchen and bathroom.





ASTON  
VAUGHAN

ASTON  
VAUGHAN

A generous double, the principal bedroom also feels peaceful looking out to the front courtyard while remaining private from the street. Wall panelling has been reinstated for character, and even with a king size bed, the carpeted floor space is not compromised.

Nearby, the bathroom has a modern take on a period scheme using marbled brick wall tiles around a traditional rainfall shower and a marble topped washstand and basin. Gold accents bring modern style to the space to include a contemporary towel rail.

At the end of the hall, the open plan living room and kitchen are naturally light and airy with sliding patio doors opening to the courtyard garden which becomes a wonderful extension of the home during the warmer seasons. There is ample space, both inside and out, for formal dining and relaxed seating, alongside the kitchen which comes fitted with integrated appliances, so you can move straight in with relative ease. Once again, wall panelling has been added and the immaculate aesthetic continues in here.

Bedroom two sits peacefully at the far end of the flat with two windows looking out to the garden creating a lovely backdrop to the space. It is another double room, ideal as a bedroom or as a tranquil study or office for one or two people working from home.











**Vendor's Comments:**

"These are magnificent buildings with an air of grandeur and a sense of occasion which few others bring. It has been a real joy to breathe new life into these apartments to ensure their heritage and character remains to be enjoyed for many more years."

**Education:**

Primary: Queens Park Primary School, St Luke's Primary

Secondary: Varndean and Dorothy Stringer, Cardinal Newman RC

Private: Brighton College and Prep, Montessori School

During the 19th century, Brighton's coastline was transformed from a quiet fishing village, to one of the most fashionable and wealthy towns in the country. From the early 1820s and throughout the Victorian era, these uniquely beautiful townhouses began lining the seafront and now 200 years later they remain just as popular.

The relaxed café culture of Kemp Town Village is just moments around the corner from these apartments which are within walking distance of The Amex Business Centre, Law Courts and the RSC Hospital as well as the historic heart of the city. Brighton Station is 25 minutes on foot or a short bus ride away with its fast service to Gatwick and London, and there's not waiting list for this parking zone. They would make hugely successful rental properties for investors, or would appeal to down sizers and professionals looking to live the quintessential Brighton lifestyle by the sea (which is visible at the bottom of the road).



## Eaton Place

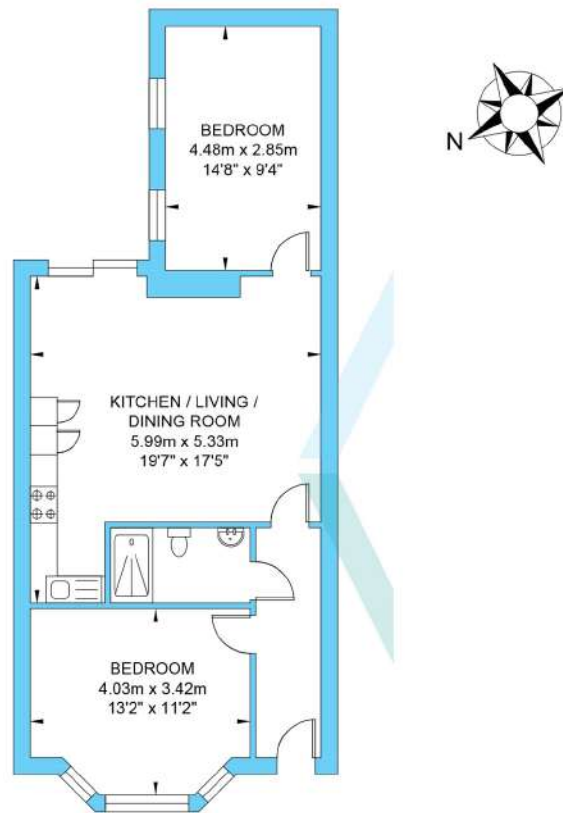

Lower Ground Floor Flat  
Approximate Floor Area  
664.56 sq ft

