

JOHNSONS & PARTNERS

Estate and Letting Agency



67 HORWOOD DRIVE, GEDLING

NOTTINGHAM, NG4 4NF

£1,150 PER MONTH



67 HORWOOD DRIVE

GEDLING, NOTTINGHAM, NG4 4NF

£1,150 PER MONTH



2 BEDROOM SEMI DETACHED | POPULAR DEVELOPMENT | AVAILABLE IMMEDIATELY |

A two bedroom, modern semi-detached residence. The property offers stylish accommodation with the added benefits of a wide range of amenities all close at hand. Schools are easily accessible, for children of all ages, there are an excellent range of shops, public transport links including two rail stations together with a mix of pubs bars and restaurants, with a variety of recreational facilities too, something for everyone.

In brief, the double glazed and centrally heated accommodation comprises reception hallway, WC, lounge and kitchen to complete the ground floor. From the first floor landing there are two bedrooms and a bathroom. To the outside there is a low maintenance garden to the rear.

Viewing is most strongly recommended in order to fully appreciate not only the accommodation but also the lovely location. Contact us now to book your personal viewing appointment.

T: 0115 855 6622

Entrance Hallway

Kitchen

Living Room

WC

First Floor Landing

Bedroom One

Bedroom Two

Bathroom

Deposits

The successful applicant will be required to pay a holding deposit equivalent to 1 weeks rent before referencing.

Prior to move in, we will require a deposit equivalent to 5 weeks rent along with the first months rent. Any holding deposit will be deducted from these amounts.

Viewings

Please contact the office to make an appointment to view. We often, in times of high demand, offer block viewings and therefore you will have an allocated time of between 10 and 15 minutes within the block time. In these cases we respectfully ask people to be prompt so as not to miss their time slot and let the office know if they will be delayed.

Agents Disclaimer

Disclaimer -

Council Tax Band Rating - Gedling Council – Tax Band B

This information was obtained through the directgov website. Johnsons and Partners offer no guarantee as to the accuracy of this information, we advise you to make further checks to confirm you are satisfied before

entering into any agreement to purchase.

The vendor has advised the following:

Property Tenure is Freehold

Agents Disclaimer: Johnsons and Partners, their clients and employees
1: Are not authorised to make or give any representations or warranties in relation to the property either here or elsewhere, either on their own behalf or on behalf of their client or otherwise. They assume no responsibility for any statement that may be made in these particulars. These particulars do not form part of any offer or contract and must not be relied upon as statements or representations of fact. 2: Any areas, measurements or distances are approximate. The text, photographs and plans are for guidance only and are not necessarily comprehensive. It should not be assumed that the property has all necessary planning, building regulation or other consents and Johnsons and Partners have not tested any services, equipment or facilities. Purchasers must make further investigations and inspections before entering into any agreement.

Purchaser information -The Money Laundering, Terrorist Financing and Transfer of Funds (Information on the Payer) Regulations 2017(MLR 2017) came into force on 26 June 2017. Johnsons and Partners require any successful purchasers proceeding with a property to provide two forms of identification i.e. passport or photocard driving license and a recent utility bill or bank statement. We are also required to obtain proof of funds and provide evidence of where the funds originated from. This evidence will be required prior to Johnsons and Partners removing a property from the market and instructing solicitors for your purchase.

Third Party Referral Arrangements – Johnsons and Partners have established professional relationships with third-party suppliers for the provision of services to Clients. As remuneration for this professional relationship, the agent receives referral commission from the third-party companies. Details are available upon request.



Road Map

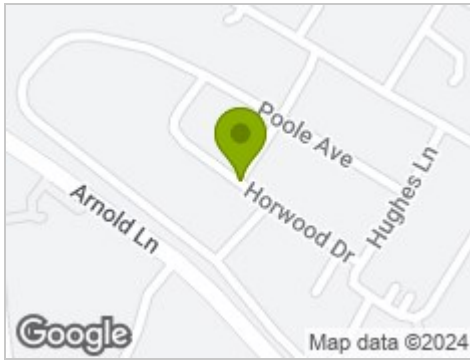

Hybrid Map



Terrain Map

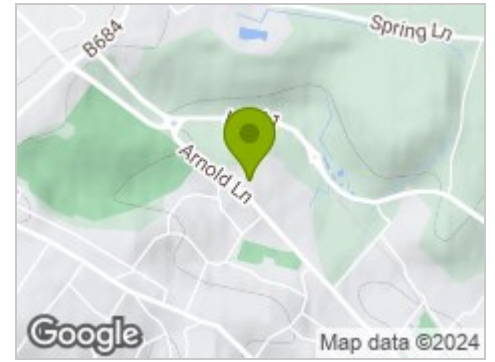

Floor Plan

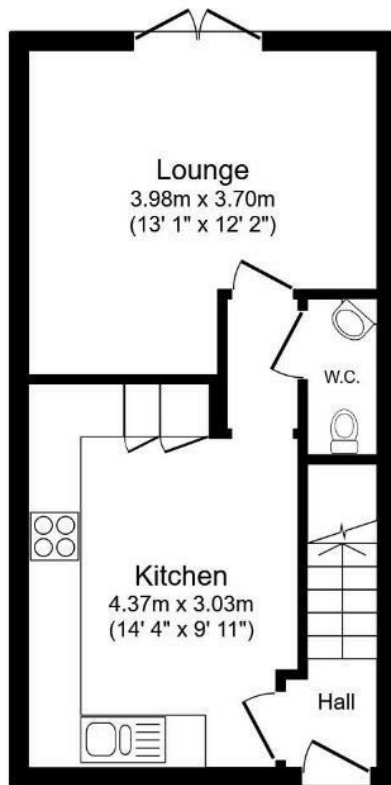

Ground Floor

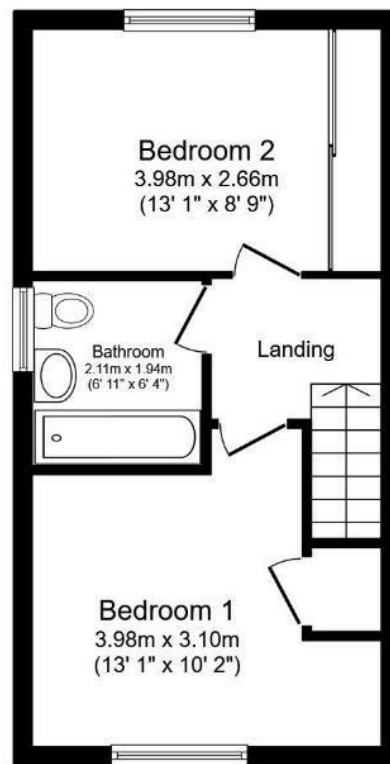

First Floor

Total floor area 65.0 sq.m. (700 sq.ft.) approx

Viewing

Please contact our Gedling Office on 0115 855 6622 if you wish to arrange a viewing appointment for this property or require further information.

Energy Efficiency Graph

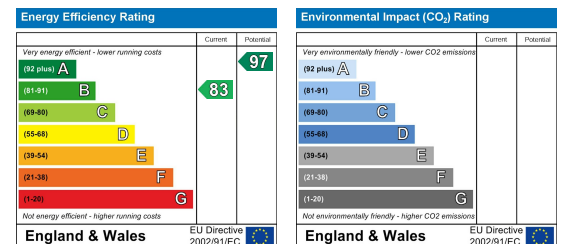

These particulars, whilst believed to be accurate are set out as a general outline only for guidance and do not constitute any part of an offer or contract. Intending purchasers should not rely on them as statements of representation of fact, but must satisfy themselves by inspection or otherwise as to their accuracy. No person in this firm's employment has the authority to make or give any representation or warranty in respect of the property.