

JOHNSONS & PARTNERS

Estate and Letting Agency



279 GREENWOOD ROAD, CARLTON

NOTTINGHAM, NG4 1AP

GUIDE PRICE £280,000

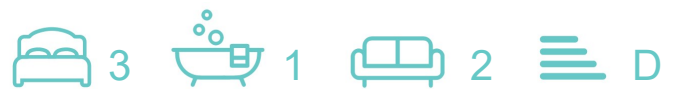

279 GREENWOOD ROAD

CARLTON, NOTTINGHAM, NG4 1AP

GUIDE PRICE £280,000



Guide Price £280,000 - £290,000 -

A modern detached, three bedroom property with accommodation over two floors. The property is in a popular location, with amenities just a short commute, including shops, schools, regular bus service and recreational facilities with more besides, for the whole family to enjoy.

The double glazed and centrally heated accommodation comprises reception hallway, lounge, separate dining room, conservatory, modern fitted kitchen with high gloss, white cupboards and a shower room completes the ground floor. On the first floor, there are two bedrooms and a separate WC. To the outside the property has a front garden and driveway with a covered car port and lean-to, and at the rear is a lovely, low maintenance, private garden.

To fully appreciate both the accommodation and the great location of this detached home, we most strongly recommend an internal viewing. Contact us now to book your personal viewing appointment.

Entrance Hallway

Living Room

15'4" x 10'6" (4.69 x 3.22)

Dining Room

11'10" x 9'2" (3.61 x 2.81)

Kitchen

11'10" x 8'9" (3.61 x 2.69)

Bathroom

6'0" x 5'7" (1.85 x 1.71)

Conservatory

7'10" x 9'1" (2.41 x 2.77)

Bedroom One

11'11" x 10'6" (3.64 x 3.22)

First Floor Landing

Bedroom Two

13'2" (max) x 11'7" (4.02 (max) x 3.55)

Bedroom Three

10'8" (max) x 8'8" (3.26 (max) x 2.66)

WC

Outside

Car Port

20'1" x 8'9" (6.14 x 2.67)

Garage

17'7" x 8'9" (5.37 x 2.67)

Agents Disclaimer

Disclaimer -

Council Tax Band Rating - Gedling Council – Tax Band C

This information was obtained through the directgov website. Johnsons and Partners offer no guarantee as to the accuracy of this information, we advise you to make further checks to confirm you are satisfied before entering into any agreement to purchase.

The vendor has advised the following:

Property Tenure is Freehold

Agents Disclaimer: Johnsons and Partners, their clients and employees 1: Are not authorised to make or give any representations or warranties in relation to the property either here or elsewhere, either on their own behalf or on behalf of their client or otherwise. They assume no responsibility for any statement that may be made in these particulars. These particulars do not form part of any offer or contract and must not be relied upon as statements or representations of fact. 2: Any areas, measurements or distances are approximate. The text, photographs and plans are for guidance only and are not necessarily comprehensive. It should not be assumed that the property has all necessary planning, building regulation or other consents and Johnsons and Partners have not tested any services, equipment or facilities. Purchasers must make further investigations and inspections before entering into any agreement.

Purchaser information -The Money Laundering, Terrorist Financing and Transfer of Funds (Information on the Payer) Regulations 2017(MLR 2017) came into force on 26 June 2017. Johnsons and Partners require any successful purchasers proceeding with a property to provide two forms of identification i.e. passport or photocard driving license and a recent utility bill or bank statement. We are also required to obtain proof of funds and provide evidence of where the funds originated from. This evidence will be required prior to Johnsons and Partners removing a property from the market and instructing solicitors for your purchase.

Third Party Referral Arrangements – Johnsons and Partners have established professional relationships with third-party suppliers for the provision of services to Clients. As remuneration for this professional relationship, the agent receives referral commission from the third-party companies. Details are available upon request.



Road Map

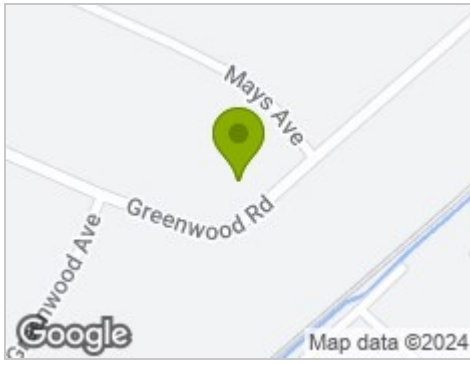

Hybrid Map



Terrain Map



Floor Plan

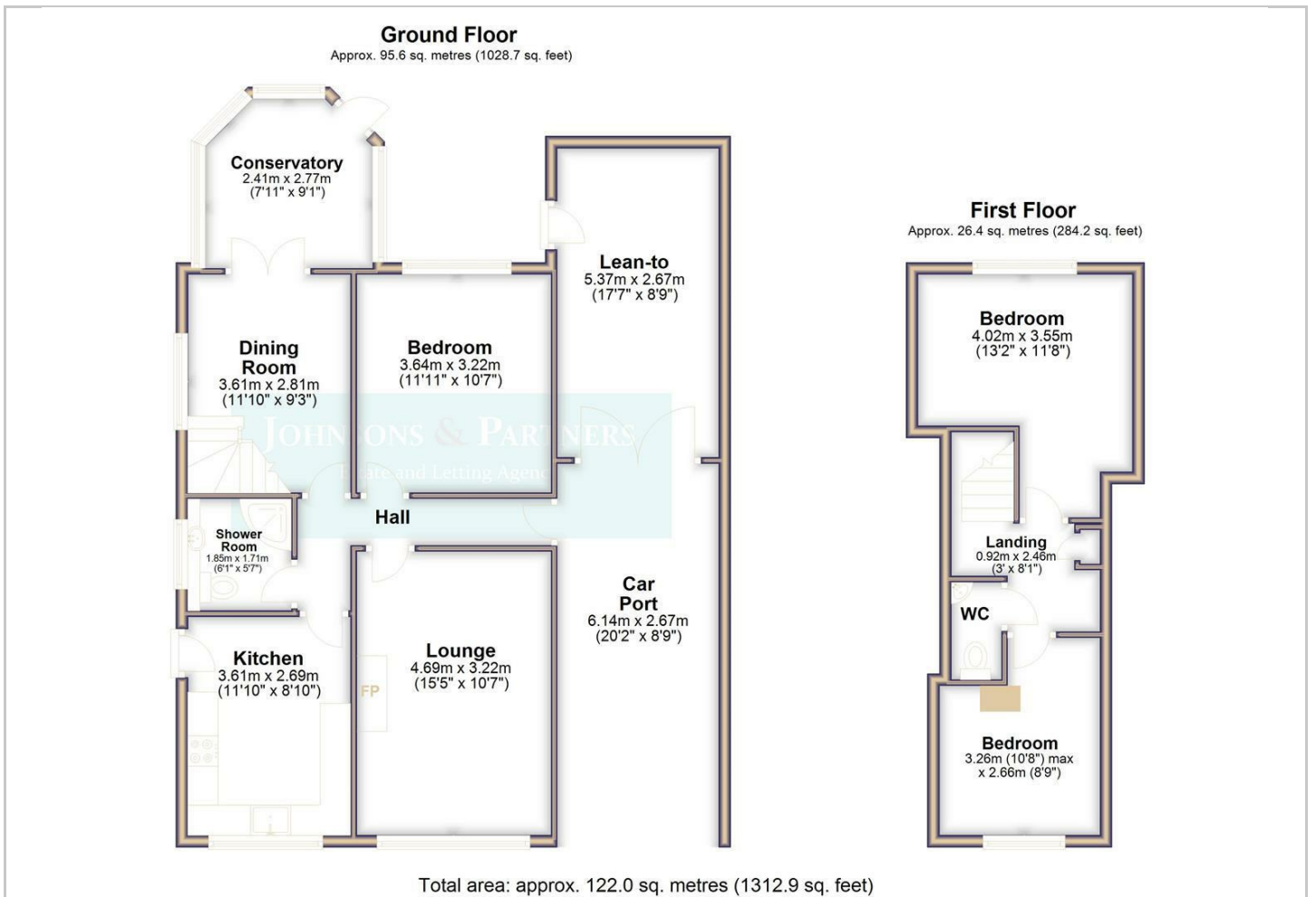

Viewing

Please contact our Gedling Office on 0115 855 6622 if you wish to arrange a viewing appointment for this property or require further information.

Energy Efficiency Graph

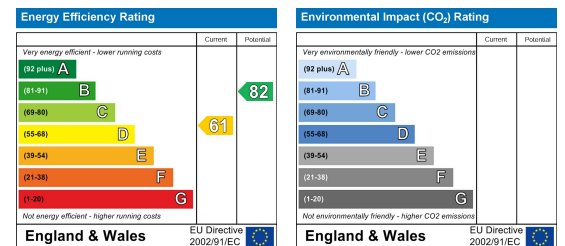

These particulars, whilst believed to be accurate are set out as a general outline only for guidance and do not constitute any part of an offer or contract. Intending purchasers should not rely on them as statements of representation of fact, but must satisfy themselves by inspection or otherwise as to their accuracy. No person in this firm's employment has the authority to make or give any representation or warranty in respect of the property.