

**MOXY**  
Property Consultants



- 3-BEDROOM SEMI DETACHED HOME
- POPULAR LOCATION
- OPEN PLAN LIVING
- 3-TIERED GARDEN

97 Crestway, Chatham, Kent, ME5 0BD

Asking Price Of £235,000

What a great opportunity to own and custom renovate this 3-bedroom Semi detached house in a popular location for convenience, schools, and amenities. From its large driveway to it's two-tiered garden and open plan living room, this home would make an ideal first-time home. This property has a lot of potential and would make an ideal investment.





Ground Floor  
Floor Area: 39.1 m<sup>2</sup> ... 421 ft<sup>2</sup>

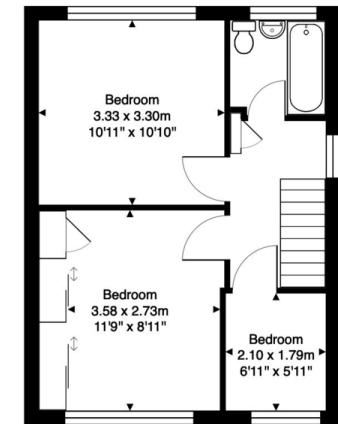

First Floor  
Floor Area: 35.9 m<sup>2</sup> ... 387 ft<sup>2</sup>



## Energy Efficiency Rating

Very energy efficient - lower running costs

(92 plus) A

(81-91) B

(69-80) C

(55-68) D

(39-54) E

(21-38) F

(1-20) G

Not energy efficient - higher running costs

Current Potential

	87
68	

4 Marina Point East, The  
Quays, Dock Head Road,  
Chatham, ME4 4ZH

moxypropertyconsultants.com  
01634 326 036  
team@moxypropertyconsultants.com

Agents Note: Whilst every care has been taken to prepare these particulars, they are for guidance purposes only. All measurements are approximate and for general guidance purposes only and whilst every care has been taken to ensure their accuracy, they should not be relied upon and potential buyers/tenants are advised to recheck the measurements.