

MOXY
Property Consultants



- THREE BEDROOMS
- END OF TERRACE
- LIVING ROOM
- KITCHEN

151 Willow Road, Dartford, DA1 2QP

Asking Price Of £279,000

LOCATION LOCATION LOCATION! Set just a mile away from Dartford Grammar School, Leisure Centre, Science and Technology College, Priory Shopping Centre and Dartford Central Park, this three bedroom home is perfectly positioned for not only convenience but also an optimum lifestyle. This family home has the benefit of a front garden leading to a brick porch. This takes you into the ground floor where there is a living room, separate kitchen and bathroom. The first floor provides 3 good size bedrooms and W.C, which we believe to be a great addition to the property. This end of terrace



GROUND FLOOR
371 sq.ft. (34.4 sq.m.) approx.

1ST FLOOR
361 sq.ft. (33.5 sq.m.) approx.

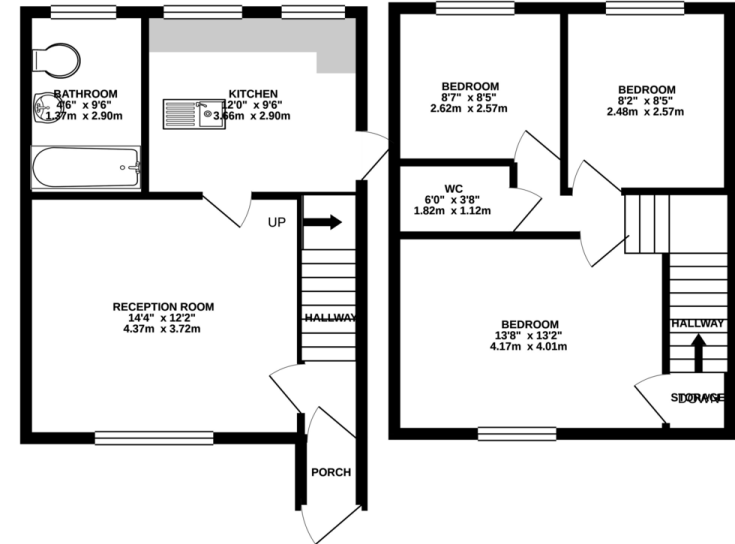

TOTAL FLOOR AREA: 731 sq.ft. (67.9 sq.m.) approx.

Whilst every attempt has been made to ensure the accuracy of the floorplan contained here, measurements of doors, windows, rooms and any other items are approximate and no responsibility is taken for any error, omission or mis-statement. This plan is for illustrative purposes only and should be used as such by any prospective purchaser. The services, systems and appliances shown have not been tested and no guarantee as to their operability or efficiency can be given.
Made with Metropix ©2020

Energy Efficiency Rating

Very energy efficient - lower running costs

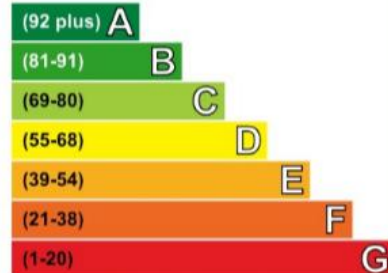

| Current | Potential |
|---------|-----------|
| 68 | 86 |

4 Marina Point East, The
Quays, Dock Head Road,
Chatham, ME4 4ZH

moxypropertyconsultants.com
01634 326 036
team@moxypropertyconsultants.com

Agents Note: Whilst every care has been taken to prepare these particulars, they are for guidance purposes only. All measurements are approximate and for general guidance purposes only and whilst every care has been taken to ensure their accuracy, they should not be relied upon and potential buyers/tenants are advised to recheck the measurements.