

# 25 Green Lane

Northwood • Middlesex • HA6 2UZ

PCM: £2,700 PCM



coopers  
est 1986

Positioned only moments for the centre of Northwood this unique ground floor period conversion apartment offers spacious accommodation filled with natural light. The property boasts character throughout with beautiful high ceilings and large bay windows. The property also benefits with off-street parking and secluded rear garden and patio area.

Northwood provides a range of shopping facilities, a Waitrose supermarket, restaurants and the Metropolitan Line Station providing access to Baker Street and the city beyond. The area has a range of both private and state schools. Places of worship and recreational facilities are also well catered for in the surrounding area and major motorway links to M25 and M1 are nearby.

Offered Unfurnished and Available in November

Local authority: London Borough of Hillingdon  
Council tax: Band F

Luxury apartment

Ground floor

Two spacious bedrooms

Close to Northwood HQ

Walking distance to Northwood station

Stylish kitchen

Gas central heating

Wooden flooring throughout

Unfurnished

Available in November

**Available Date**

5th December 2025



APPROX. GROSS INTERNAL FLOOR AREA 1496 SQ FT 138.9 SQ METRES

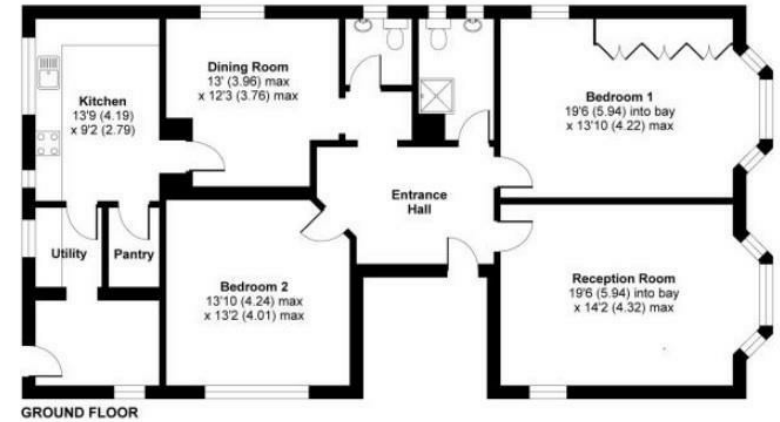

"For illustrative purposes only - not to scale. The position and size of doors, windows, appliances and other features are approximate only."

Whilst every attempt has been made to ensure the accuracy of the floor plan contained here, measurements of doors, windows and rooms are approximate and no responsibility is taken for any error, omission or misstatement. These plans are for representation purposes only as defined by RICS Code of Measuring Practice and should be used as such by any prospective purchaser. Specifically no guarantee is given on the total square footage of the property if quoted on this plan. Any figure given is for initial guidance only and should not be relied on as a basis of valuation.



**coopers**  
est 1986

**0208 017 6000**

**18 Bridge Street, Pinner,  
Middlesex, HA5 3JF**

[pinner@coopersresidential.co.uk](mailto:pinner@coopersresidential.co.uk)

**CoopersResidential.co.uk**

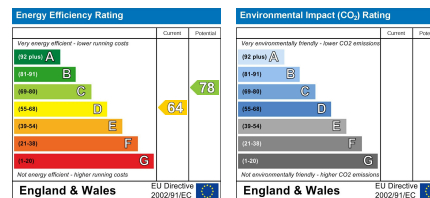

Important Notice: These particulars, whilst believed to be accurate are set out as a general outline only for guidance and do not constitute any part of an offer or contract. Intending purchasers should not rely on them as statements or representation of fact, but must satisfy themselves by inspection or otherwise has the authority to make or give any representation or warranty in respect of the property.