

Clearview House

Northwood • Middlesex • HA6 1BX

PCM: £1,400 PCM



coopers
est 1986

A BRAND NEW and IMMACULATELY PRESENTED ONE BEDROOM apartment built by the RENOWNED Clearview Homes. PERFECTLY LOCATED within WALKING DISTANCE to Northwood Tube Station and High Street, this property briefly comprises; secure entrance, SPACIOUS OPEN PLAN LOUNGE, modern fitted kitchen with white goods, double bedroom with FITTED WARDROBES and a tiled family bathroom. Other benefits include; phone entry system and double glazing.

Available in August and offered unfurnished.

Local Authority: London borough of Hillingdon
Council Tax: Band C

Ground floor

Close to Northwood HQ

Modern bathroom

Large bedroom

Walking distance to Northwood Station

Wooden flooring

Video entry system

High specification

Unfurnished

Available in August

Available Date

9th August 2024

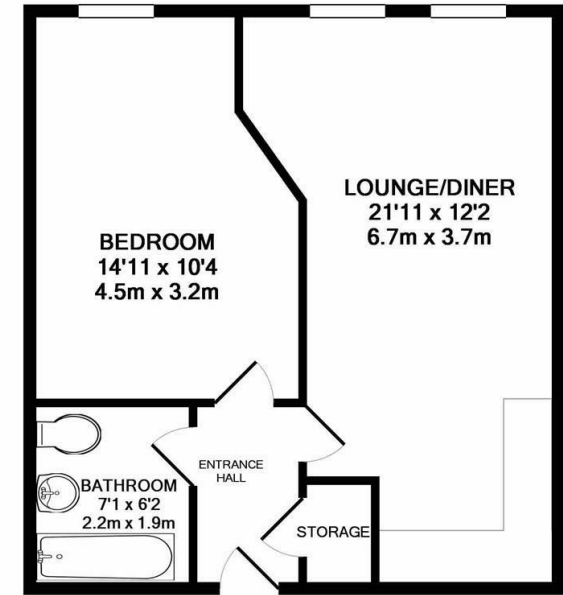

TOTAL APPROX. FLOOR AREA 441 SQ.FT. (40.9 SQ.M.)

Whilst every attempt has been made to ensure the accuracy of the floor plan contained here, measurements of doors, windows, rooms and any other items are approximate and no responsibility is taken for any error, omission, or mis-statement. This plan is for illustrative purposes only and should be used as such by any prospective purchaser. The services, systems and appliances shown have not been tested and no guarantee as to their operability or efficiency can be given
Made with Metropix ©2019



coopers
est 1986

0208 017 6000

**18 Bridge Street, Pinner,
Middlesex, HA5 3JF**

pinner@coopersresidential.co.uk

CoopersResidential.co.uk

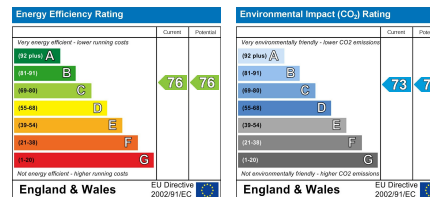

Important Notice: These particulars, whilst believed to be accurate are set out as a general outline only for guidance and do not constitute any part of an offer or contract. Intending purchasers should not rely on them as statements or representation of fact, but must satisfy themselves by inspection or otherwise has the authority to make or give any representation or warranty in respect of the property.