



FLEXIAGENT

Market Leading, Independent Estate Agents



Southport New Road

Banks, PR9 8DF

£20,000

Flexi-Agent are proud to present this beautiful two bedroom park home to the open market. Located in the family friendly Riverside park, it is close to the beautiful Southport seafront, with great amenities close by, and on the site are plenty of bars & cafes, swimming pool & splash park, steam room & sauna, adventure park & more.

The property briefly comprises of a spacious lounge, full of natural light with floor to ceiling length windows and sliding doors and an open plan dining with fitted kitchen. Along the hall there are two bedrooms, one with a double bed and an en-suite shower room, and a shared bathroom.

Externally, there is ample private parking with space for two cars.

There is no tv license or council tax and the property must be vacated for two weeks of the year.

Site fees TBC, the current vendor has paid until Jan 2026.

Viewings available upon request.

Viewing

Please contact our Flexi Agent Southport Office on 01704 889455 if you wish to arrange a viewing appointment for this property or require further information.



Floor Plan

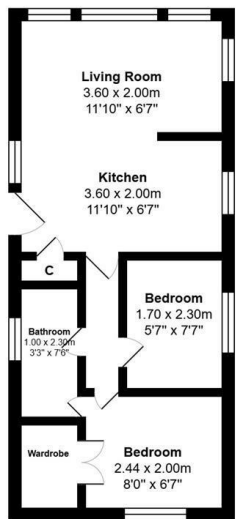

Total Area: 31.6 m² ... 340 ft²
All measurements are approximate and for display purposes only

Area Map



Energy Efficiency Graph

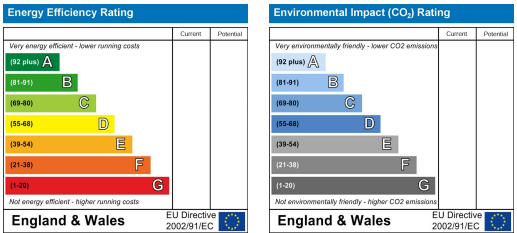

These particulars, whilst believed to be accurate are set out as a general outline only for guidance and do not constitute any part of an offer or contract. Intending purchasers should not rely on them as statements of representation of fact, but must satisfy themselves by inspection or otherwise as to their accuracy. No person in this firms employment has the authority to make or give any representation or warranty in respect of the property.