



FLEXIAGENT

Market Leading, Independent Estate Agents



Bath Street North

Southport, PR9 0DJ

Offers In Excess Of £100,000

Flexi Agent are delighted to present this two bedroom second floor apartment to the open market. Located a short walk from Southport town centre offering a plethora of cafes, bars, shops & amenities, as well as close to the Promenade offering views of Marine Lake.

The property briefly comprises of; hallway with storage, two bedrooms, spacious lounge, kitchen & three piece bathroom.

Externally the property offers communal garden & off street parking.

Viewings available upon request.

Leasehold
Service charge approx. £100 per month
EPC C
Council tax band: B

- Two bedrooms
- Second floor apartment
- Circa 510 sqft
- Spacious lounge
- Three piece bathroom
- Town centre location
- Communal garden
- Off street parking available
- Leasehold
- Viewings available upon request

Betty Anne Court
89-91 Bath Street North

Viewing

Please contact our Flexi Agent Southport Office on 01704 889455 if you wish to arrange a viewing appointment for this property or require further information.



Floor Plan

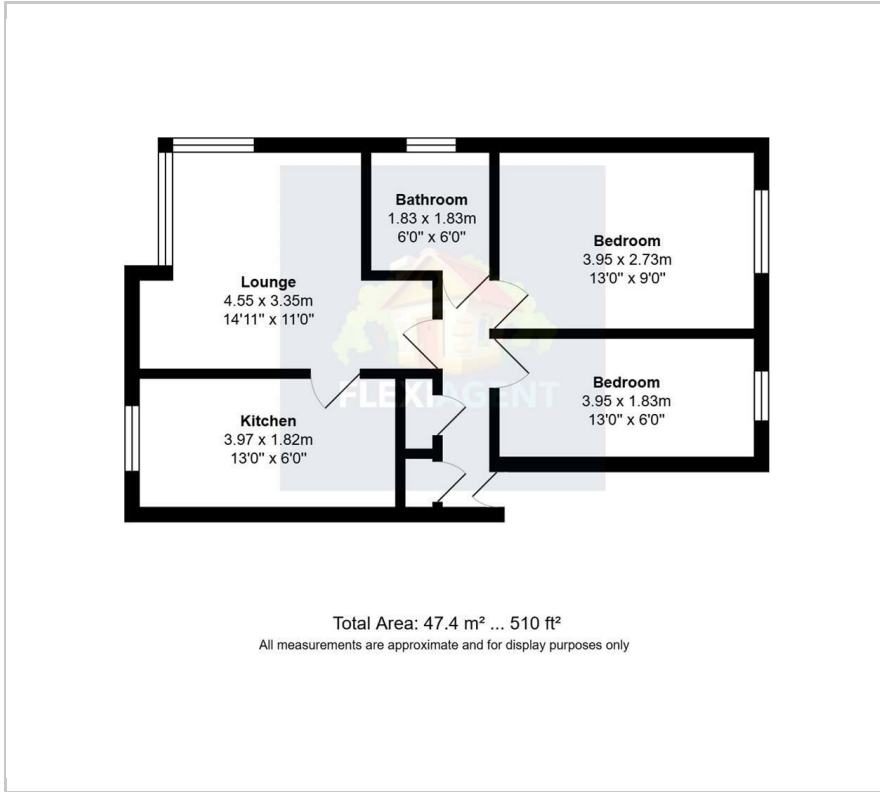

Area Map

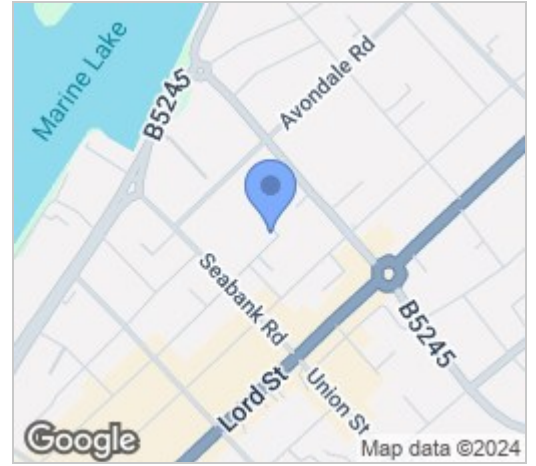

Energy Efficiency Graph

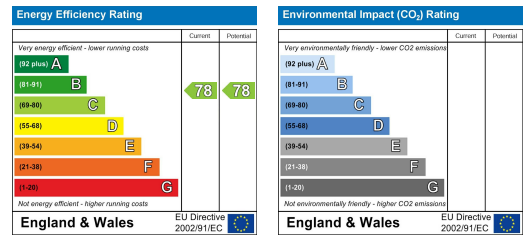

These particulars, whilst believed to be accurate are set out as a general outline only for guidance and do not constitute any part of an offer or contract. Intending purchasers should not rely on them as statements of representation of fact, but must satisfy themselves by inspection or otherwise as to their accuracy. No person in this firm's employment has the authority to make or give any representation or warranty in respect of the property.