



FLEXIAGENT

Market Leading, Independent Estate Agents



Linaker Street

Southport, PR8 5DF

Asking Price £165,000

Flexi-Agent are delighted to present this lovely two bedroom semi detached property to the open market. Located in this sought after area of Southport, it is surrounded by a wealth of local amenities, has easy access to local transport links & is a stones throw from Southport town centre & Birkdale village.

The property briefly comprises of entrance vestibule & hallway, bright lounge with central wood burner, dining room beautifully presented with wood burner as well, ample kitchen finished to a modern standard.

To the first floor, there are two spacious bedrooms full of natural light & family sized bathroom finished to a high standard.

Externally, there is a lovely front garden with side access to the rear sun catching garden which is both patio & laid to lawn, with quaint decked area.

NO CHAIN.

Viewings available upon request.

Viewing

Please contact our Flexi Agent Southport Office on 01704 889455 if you wish to arrange a viewing appointment for this property or require further information.

- NO CHAIN
- Two bedrooms
- End terrace
- Spacious throughout
- Sought after Southport location
- Ideal investment opportunity
- Stones throw from Birkdale village
- Ample sun catching rear garden
- Perfect for first time buyers
- Viewings available upon request



Floor Plan

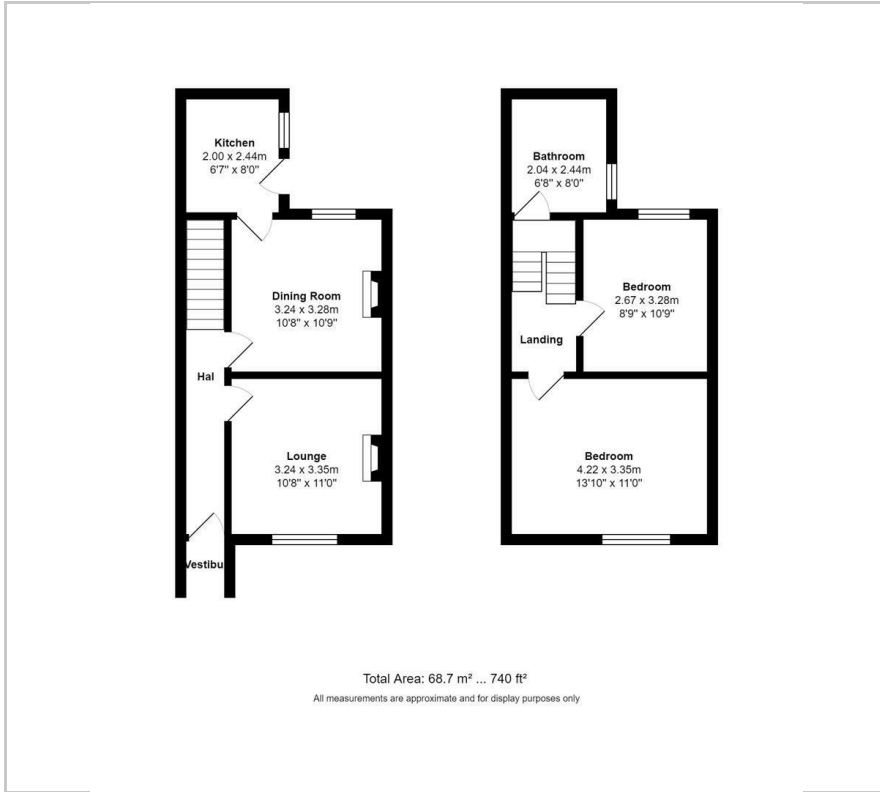

Area Map



Energy Efficiency Graph

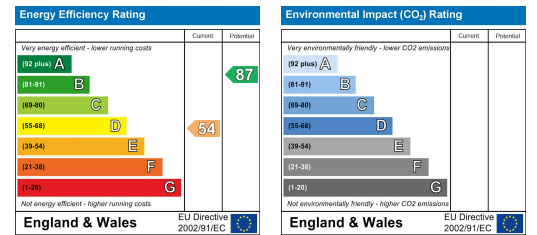

These particulars, whilst believed to be accurate are set out as a general outline only for guidance and do not constitute any part of an offer or contract. Intending purchasers should not rely on them as statements of representation of fact, but must satisfy themselves by inspection or otherwise as to their accuracy. No person in this firm's employment has the authority to make or give any representation or warranty in respect of the property.