



FLEXIAGENT

Market Leading, Independent Estate Agents



Moss Road

Southport, PR8 4JA

Offers Over £150,000

Flexi-Agent are delighted to promote this two bedroom bungalow to the open market. This property does require modernisation & would be an ideal investment property or first time buyers project. Located close to several shops, supermarkets and restaurants and has easy access in and out of Southport Town Centre, Birkdale & Melos Cop retail park. Available for purchase with NO ONWARDS CHAIN.

The property briefly comprises of; spacious lounge, two bedrooms, shower room, dining room leading to rear & kitchen.

To the front offers driveway parking, to the rear offers decking seating entertainment area leading to a long North Westerly facing sun catching garden area.

Viewings available upon request.

Freehold
NO CHAIN
Council tax band B
EPC E

Viewing

Please contact our Flexi Agent Southport Office on 01704 889455 if you wish to arrange a viewing appointment for this property or require further information.

- Two bedrooms
- Semi detached bungalow, circa 750 sqft
- Ideal investment or first time buyers project
- Spacious lounge
- Nicely presented kitchen
- Shower room
- NO CHAIN
- Front driveway parking
- Spacious North Westerly sun catching garden & decked rear seating area
- Viewings available upon request



2



1



1



E

Floor Plan

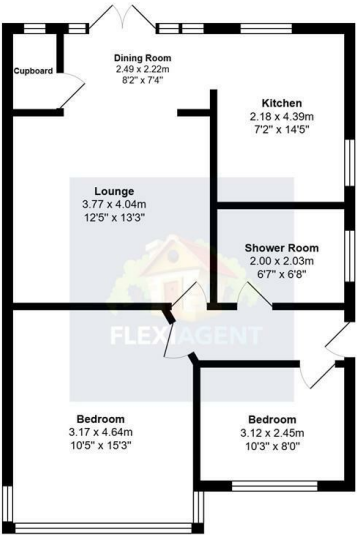

Total Area: 69.7 m² ... 750 ft²
All measurements are approximate and for display purposes only

Area Map



Energy Efficiency Graph

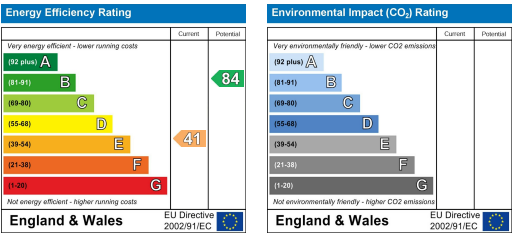

These particulars, whilst believed to be accurate are set out as a general outline only for guidance and do not constitute any part of an offer or contract. Intending purchasers should not rely on them as statements of representation of fact, but must satisfy themselves by inspection or otherwise as to their accuracy. No person in this firms employment has the authority to make or give any representation or warranty in respect of the property.