



# FLEXIAGENT

Market Leading, Independent Estate Agents



## Moss Road

Southport, PR8 4HZ

### Offers In Excess Of £150,000

Flexi-Agent is proud to present this three-bedroom semi-detached property to the open sales market. The property is located in the desirable area of Halsall, surrounded by stunning countryside views. It offers easy access to both Birkdale Village and Kew Retail Park, which provide a wide range of local bars, restaurants, shops, and other amenities.

The accommodation briefly comprises: Entrance porch and hallway, living room, second reception room, a good sized kitchen, conservatory and downstairs bathroom and WC.

To the first floor three well proportioned double bedrooms.

Externally the property benefits from ample driveway parking, garage and a generous sun catching garden with a brick built outhouse.

Early inspection of this property is strongly recommended to fully appreciate the accommodation on offer.

EPC D  
Council Tax Band C  
Freehold.

Viewing is available immediately by appointment.

### Viewing

Please contact our Flexi Agent Southport Office on 01704 889455 if you wish to arrange a viewing appointment for this property or require further information.



3



1



2



D

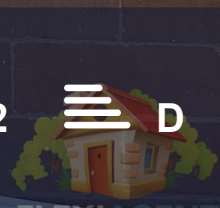



Floor Plan

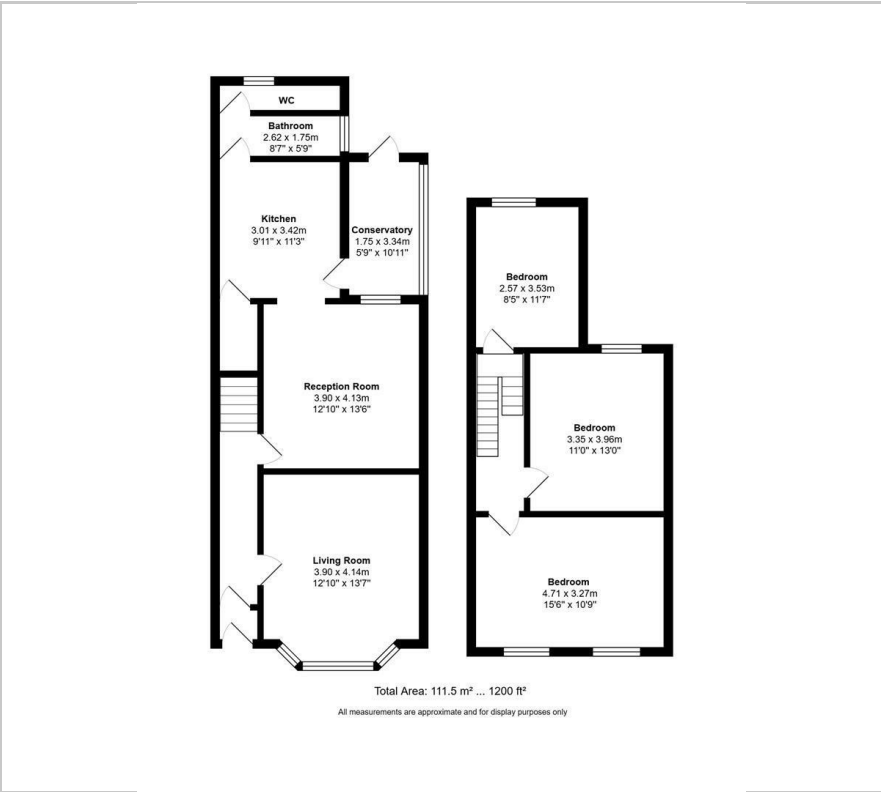

Area Map

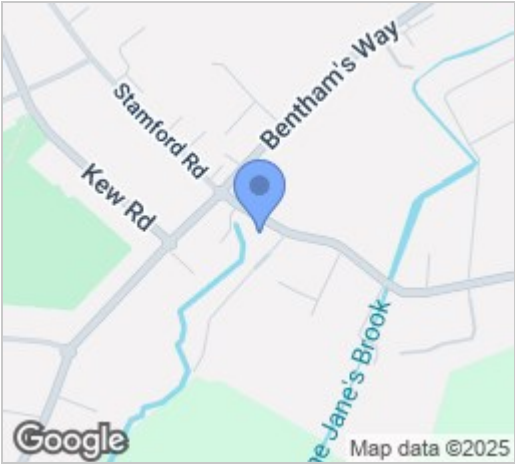

Energy Efficiency Graph

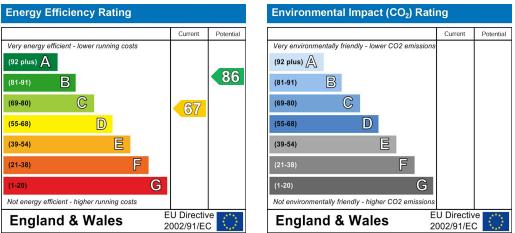

These particulars, whilst believed to be accurate are set out as a general outline only for guidance and do not constitute any part of an offer or contract. Intending purchasers should not rely on them as statements of representation of fact, but must satisfy themselves by inspection or otherwise as to their accuracy. No person in this firms employment has the authority to make or give any representation or warranty in respect of the property.