



FLEXIAGENT

Market Leading, Independent Estate Agents



Park Road

Southport, PR9 9JU

Offers In Excess Of £50,000

Flexi Agent are proud to present this one double bedroom, ground floor apartment to the open sales market. The property is located on Park Road in Southport next to the picturesque Hesketh Park. It is a stones throw from Southport Town Centre and Churchtown village which has a variety of bars, shops, cafes, restaurants and local amenities. Additionally Southport Golf Links and Marine Lake are within walking distance. Available to residents 60 years and over.

The apartment briefly comprises a communal entrance to the building, a private hallway, a storage cupboard for added convenience, a lounge with access to the communal gardens, a kitchen, one double bedroom and a modern three piece shower room.

Externally the property offers residents' parking and well kept communal gardens.

There is a range of communal facilities within the development including a laundry room, guest accommodation (subject to availability and booking fee) and a communal lounge.

Viewings available upon request.

EPC D
Council tax band A
Leasehold

Viewing

Please contact our Flexi Agent Southport Office on 01704 889455 if you wish to arrange a viewing appointment for this property or require further information.

- One double bedroom
- Ground floor apartment
- Circa 398 sqft
- Residents over 60+
- No onwards chain
- Lounge with garden access
- Modern three piece shower room
- Well kept communal gardens
- Off road parking available
- Viewings available upon request



1



1



1



D

Floor Plan

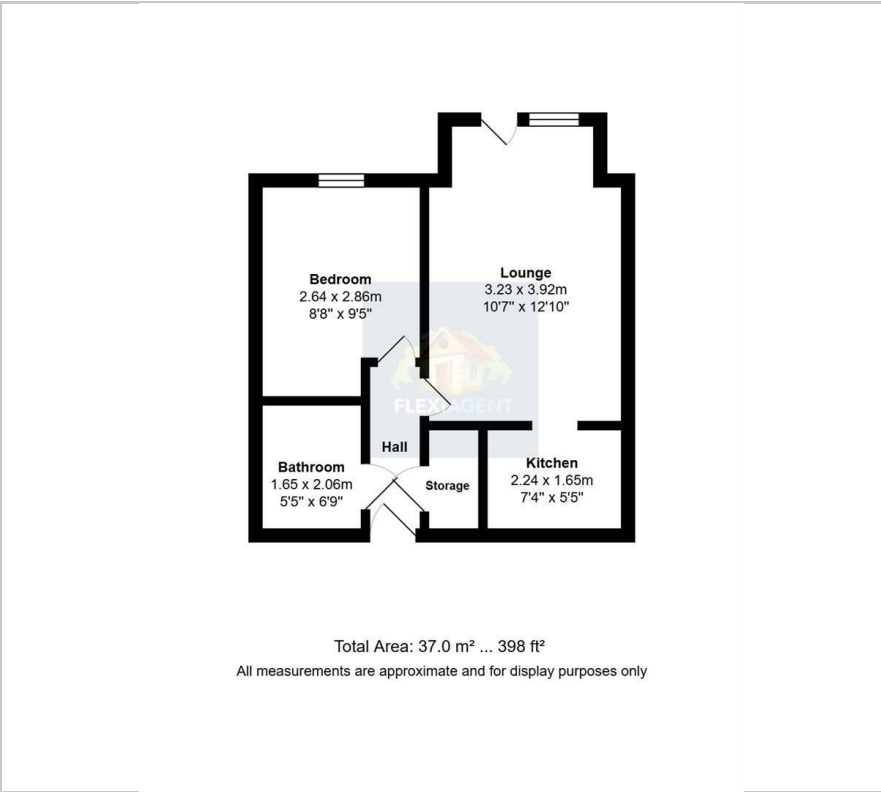

Area Map

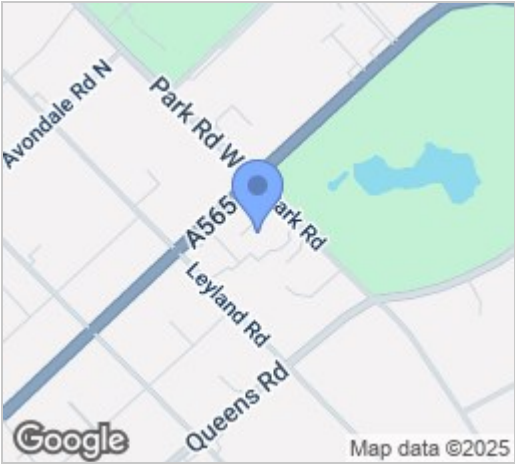

Energy Efficiency Graph

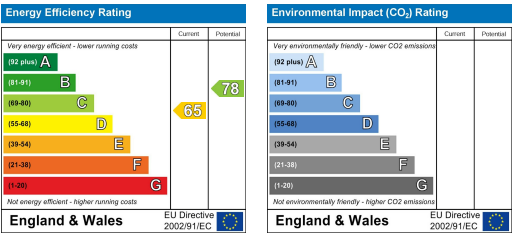

These particulars, whilst believed to be accurate are set out as a general outline only for guidance and do not constitute any part of an offer or contract. Intending purchasers should not rely on them as statements of representation of fact, but must satisfy themselves by inspection or otherwise as to their accuracy. No person in this firms employment has the authority to make or give any representation or warranty in respect of the property.