



FLEXIAGENT

Market Leading, Independent Estate Agents



Larkspur Close

Southport, PR8 6LS

£1,000 Per Month

Flexi-Agent is delighted to present this well presented two bedroom terraced property to the rental market. Situated in a highly sought-after residential location in the heart of Southport, the property is just a short distance from Southport Town Centre, offering an abundance of local amenities.

The property briefly comprises: Entrance hallway, living room, a good sized kitchen/diner with patio doors to the sun catching rear garden.

To the first floor two well proportioned bedrooms and a three piece bathroom.

Externally the property benefits from driveway parking and a sun catching rear garden.

Deposit £1153.84

Viewing

Please contact our Flexi Agent Southport Office on 01704 889455 if you wish to arrange a viewing appointment for this property or require further information.



2



1



1



Floor Plan

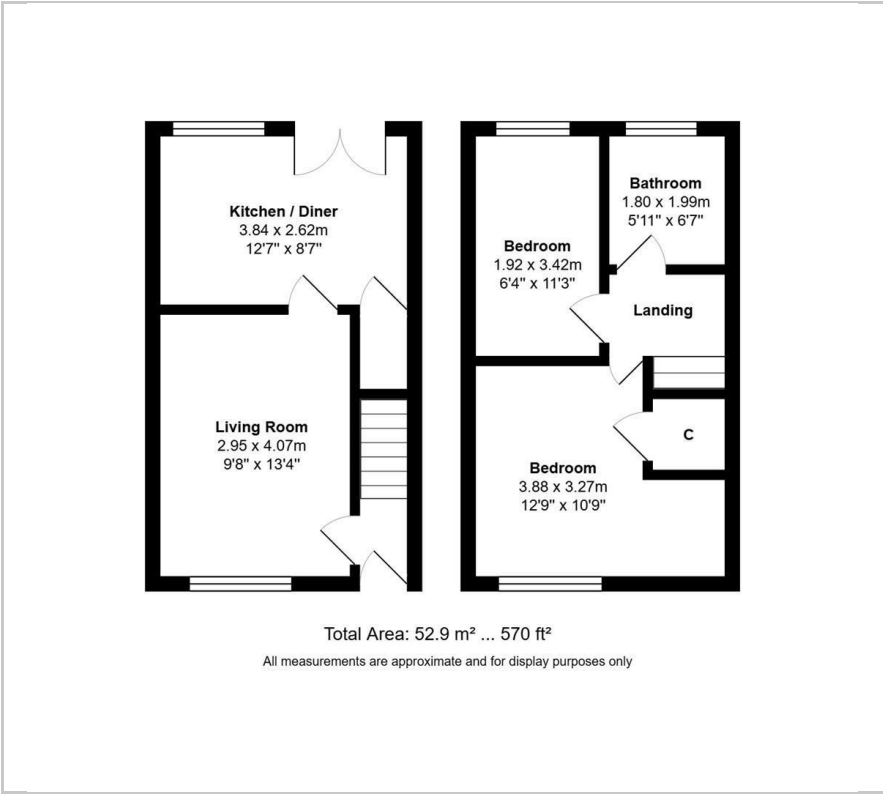

Area Map



Energy Efficiency Graph

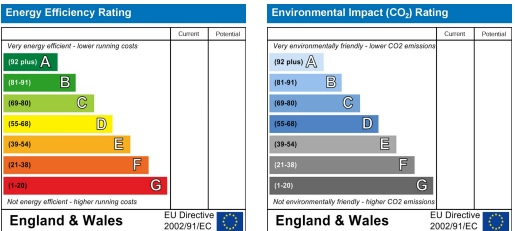

These particulars, whilst believed to be accurate are set out as a general outline only for guidance and do not constitute any part of an offer or contract. Intending purchasers should not rely on them as statements of representation of fact, but must satisfy themselves by inspection or otherwise as to their accuracy. No person in this firms employment has the authority to make or give any representation or warranty in respect of the property.