



FLEXIAGENT

Market Leading, Independent Estate Agents



Sussex Road

Southport, PR8 6DF

Offers In Excess Of £170,000

Flexi-Agent is delighted to present this well-presented and spacious three-bedroom semi-detached home, ideally located in a popular and family-friendly residential area. Perfect for first-time buyers or growing families, this property is offered with no onward chain, making for a smooth and hassle-free purchase.

The property briefly comprises; entrance porch, entrance hall, living room and an open plan kitchen diner with French doors opening to the rear garden. The first floor offers three well proportioned bedrooms to the first floor and a modern three piece family bathroom.

Externally the property boasts ample driveway parking to the front and a dual tiered, landscaped garden to the rear of the property. NO CHAIN.

Viewing is available immediately by appointment.

Freehold
EPC D
Council Tax B

Mobile coverage
EE

- Three bedroom semi-detached family home
- Open plan kitchen-diner
- Spacious living room
- Well proportioned bedrooms
- Modern three piece family bathroom
- Ample driveway parking
- Sun-catching rear garden
- In popular residential location
- NO CHAIN
- Viewing is available by appointment

Viewing

Please contact our Flexi Agent Southport Office on 01704 889455 if you wish to arrange a viewing appointment for this property or require further information.



Floor Plan

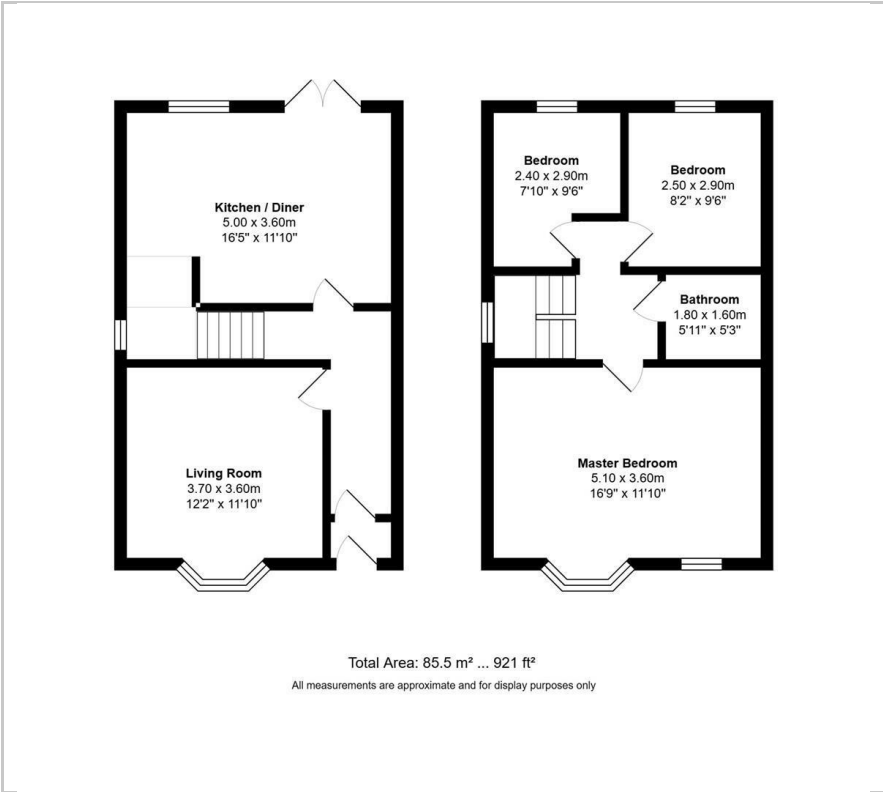

Area Map



Energy Efficiency Graph

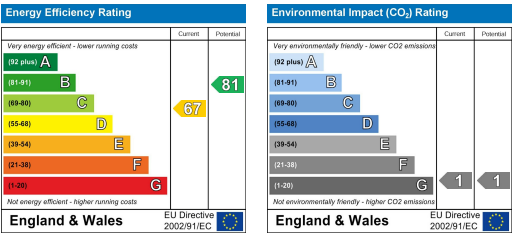

These particulars, whilst believed to be accurate are set out as a general outline only for guidance and do not constitute any part of an offer or contract. Intending purchasers should not rely on them as statements of representation of fact, but must satisfy themselves by inspection or otherwise as to their accuracy. No person in this firms employment has the authority to make or give any representation or warranty in respect of the property.