



FLEXIAGENT

Market Leading, Independent Estate Agents



Victoria Court

Southport, PR8 2DN

£800

Flexi-Agent are thrilled to present this beautifully appointed one bedroom ground-floor apartment, perfectly situated in the heart of Birkdale Village. The location offers an enviable array of amenities, including a variety of local shops, eateries, and bars, as well as excellent transport links that provide easy access to Southport town centre and beyond. Resident parking is also available.

The property briefly comprises: Entrance hallway and cloakroom, a spacious living room with access to the patio garden, kitchen, a well-proportioned double bedroom, bathroom and separate WC.

Externally the property benefits from off road parking and well maintained communal gardens.

The building has recently undergone the construction of a new roof and a new boiler was installed at the property on 1/2/2023.

Deposit £923

Viewing is available immediately by appointment.

Council Tax Band B
EPC D

Viewing

Please contact our Flexi Agent Southport Office on 01704 889455 if you wish to arrange a viewing appointment for this property or require further information.

- One bedroom
- Ground floor apartment, circa 678 sqft
- Cloak room
- Well portioned double bedroom
- Nicely presented kitchen
- Three piece bathroom
- Patio garden
- Communal gardens
- Off road parking
- Viewings available upon request



Floor Plan

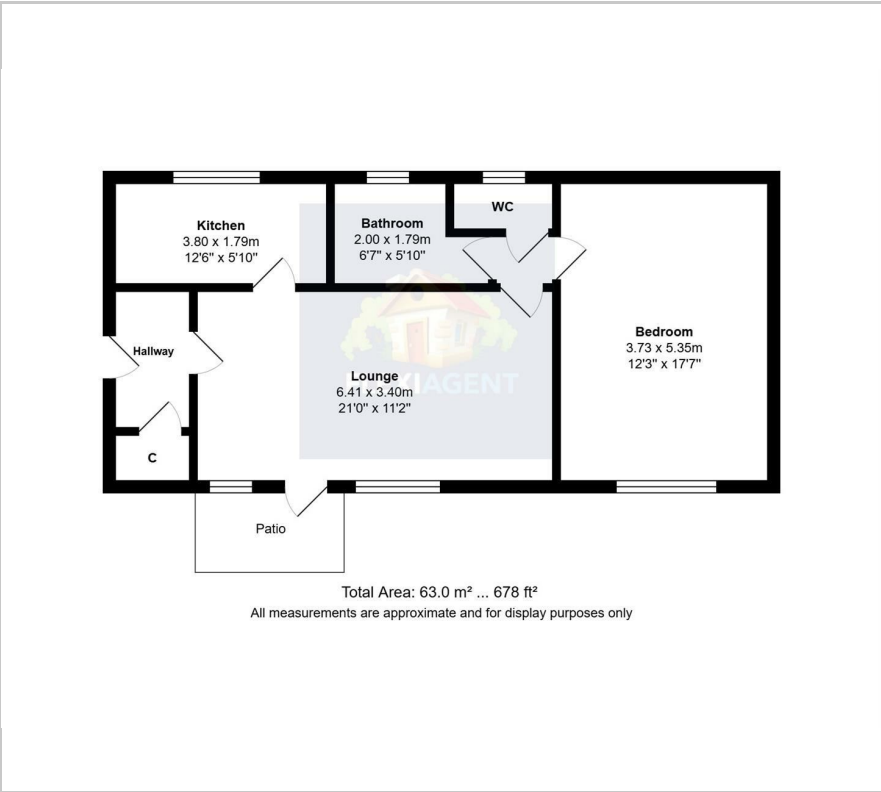

Area Map

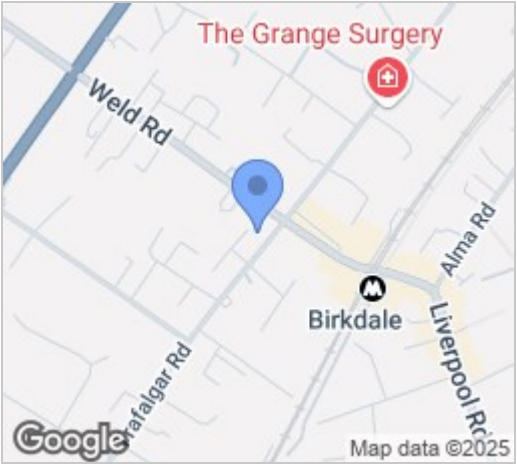

Energy Efficiency Graph

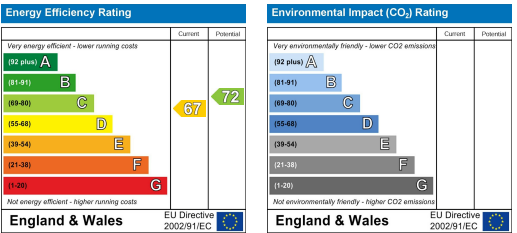

These particulars, whilst believed to be accurate are set out as a general outline only for guidance and do not constitute any part of an offer or contract. Intending purchasers should not rely on them as statements of representation of fact, but must satisfy themselves by inspection or otherwise as to their accuracy. No person in this firms employment has the authority to make or give any representation or warranty in respect of the property.