



FLEXIAGENT

Market Leading, Independent Estate Agents



Westbourne Road

Southport, PR8 2JU

Offers In Excess Of £615,000

Flexi Agent are delighted to present this beautiful THREE DOUBLE BEDROOM Detached Dorma Bungalow to the open market. Located a stones throw from the Ainsdale / Birkdale sandhills nature reserve, close proximity to the beach & short distance from Birkdale village offering a plethora of shops, cafes, and bars as well as easy transport links into Southport town centre or Liverpool.

This fabulous property has been updated to a high standard including a full rewire, updated plumbing, a new central heating system, a stunning new open-plan kitchen, shower rooms, double-glazed windows, internal doors, a feature staircase with glass panelling, new carpeting and flooring, interior decoration, new rainwater goods, composite decking, and a new roof for the garage and summerhouse.

The property briefly comprises: Entrance vestibule, hallway, front spacious living room, a ground floor double bedroom with dressing room, shower room, utility room, nicely presented kitchen diner leading to the rear lounge with double doors to the sun-catching rear garden.

The first floor briefly comprises of two double bedrooms, storage & shower room.

Externally the property offers front gated driveway parking, a sun-catching garden to the rear with a decked entertainment area & garden room and a detached double garage.

- Three double bedrooms
- Dorma detached bungalow, circa 2163 sqft
- Close to Birkdale village
- Front spacious living room
- Nicely presented kitchen diner
- Two Shower rooms
- Front gated driveway & detached double garage
- Rear sun catching garden & decked entertainment area
- Garden room
- Viewings available upon request

Viewing

Please contact our Flexi Agent Southport Office on 01704 889455 if you wish to arrange a viewing appointment for this property or require further information.



3



2



2



D

Floor Plan

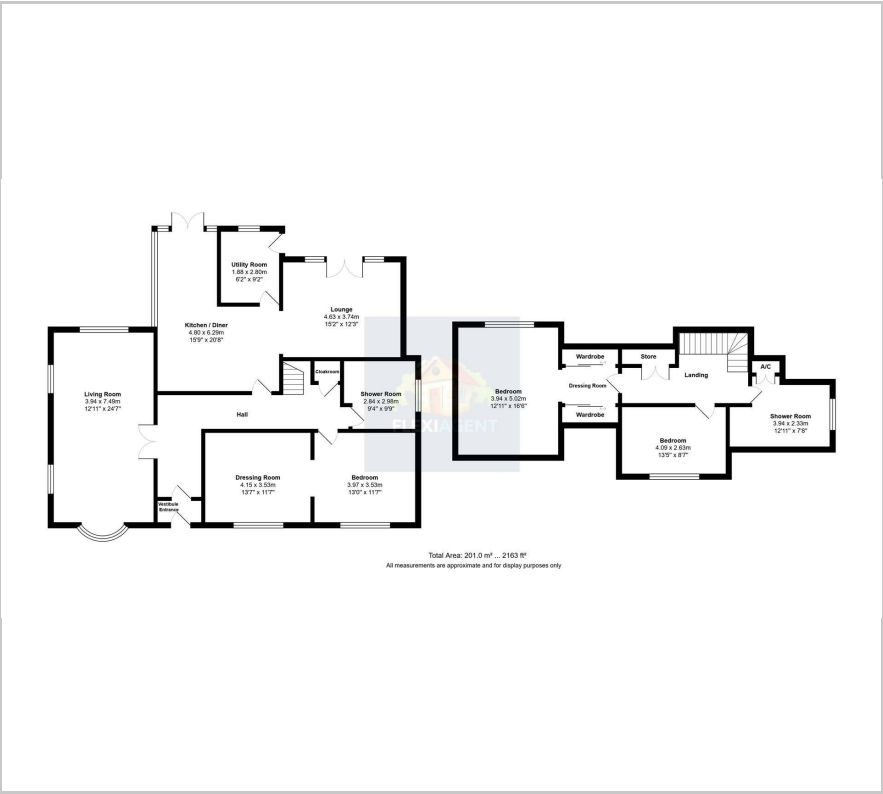

Area Map



Energy Efficiency Graph

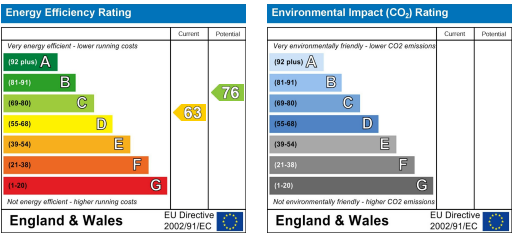

These particulars, whilst believed to be accurate are set out as a general outline only for guidance and do not constitute any part of an offer or contract. Intending purchasers should not rely on them as statements of representation of fact, but must satisfy themselves by inspection or otherwise as to their accuracy. No person in this firms employment has the authority to make or give any representation or warranty in respect of the property.