



FLEXIAGENT

Market Leading, Independent Estate Agents



Promenade

Southport, PR8 1SP

Offers In Excess Of £125,000

Flexi-Agent are delighted to present this two bedrooms ground floor apartment to the open market. Located on the Promenade of Southport Town Centre, the property is surrounded by a wealth of local amenities including several high-street shops, well-known restaurants and bars, popular attractions, within walking distance of Lord Street and the beach is only a short walk away. Available for purchase with NO ONWARDS CHAIN.

The property offers communal entrance into the building followed by communal seating area.

The apartment briefly comprises of; hallway, two bedrooms, storage / utility room with a further two storage spaces, open plan living / diner leading to nicely presented kitchen.

Externally the property offers one resident parking space.

Viewings available upon request.

NO CHAIN
Leasehold: 980 years remaining
EPC D
Council tax band: B

Viewing

Please contact our Flexi Agent Southport Office on 01704 889455 if you wish to arrange a viewing appointment for this property or require further information.

- Two bedrooms
- Ground floor apartment
- Circa 620 sqft
- Surrounded by a wealth of local amenities
- Open plan living / diner
- Nicely presented kitchen
- Three piece bathroom
- One resident parking space
- Short distance from Southport Beach
- Viewings available upon request



Floor Plan

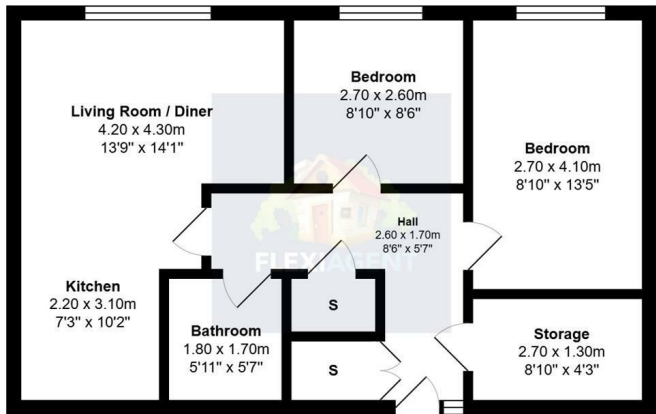

Total Area: 57.6 m² ... 620 ft²
All measurements are approximate and for display purposes only

Area Map



Energy Efficiency Graph

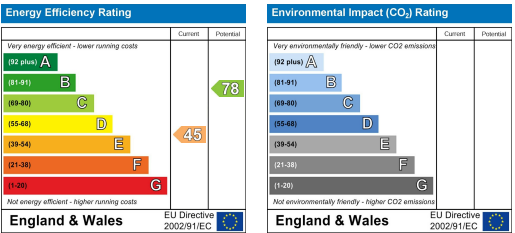

These particulars, whilst believed to be accurate are set out as a general outline only for guidance and do not constitute any part of an offer or contract. Intending purchasers should not rely on them as statements of representation of fact, but must satisfy themselves by inspection or otherwise as to their accuracy. No person in this firms employment has the authority to make or give any representation or warranty in respect of the property.