



FLEXIAGENT

Market Leading, Independent Estate Agents



Southport New Road

Southport, PR9 8DF

Offers In The Region Of £40,000

Flexi-Agent are proud to present this beautiful two bedroom park home to the open market. Located in the family friendly Riverside park, it is close to the beautiful Southport seafront, with great amenities close by, and on the site are plenty of bars & cafes, swimming pool & splash park, steam room & sauna, adventure park & more.

The property briefly comprises: A spacious open-plan living space with a dining area and a modern kitchen with integrated appliances two well-proportioned double bedrooms one with an ensuite and a modern bathroom.

Early inspection of this property is strongly recommended to fully appreciate the accommodation on offer.

Leasehold
Site fees £5980 per annum

Viewing is available immediately by appointment.

Viewing

Please contact our Flexi Agent Southport Office on 01704 889455 if you wish to arrange a viewing appointment for this property or require further information.

- Two bedroom park home,
- Ensuite
- Parking
- Open plan living
- Viewings available on request
- Integrated appliances
- Modern throughout
- Swimming pool on site
- Bar
- Sauna



Floor Plan

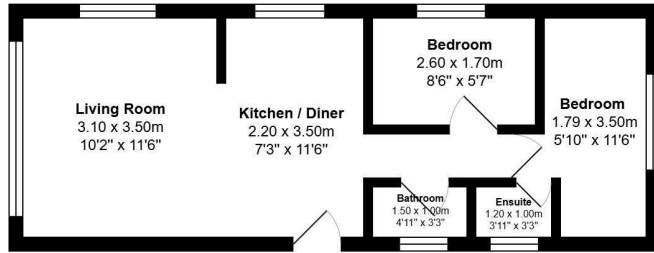

Total Area: 35.0 m² ... 377 ft²

All measurements are approximate and for display purposes only

Area Map

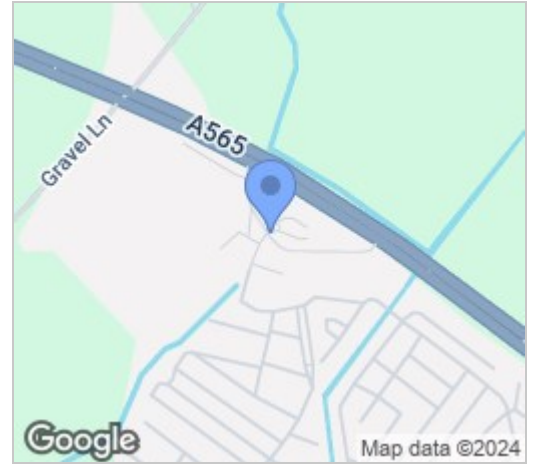

Energy Efficiency Graph

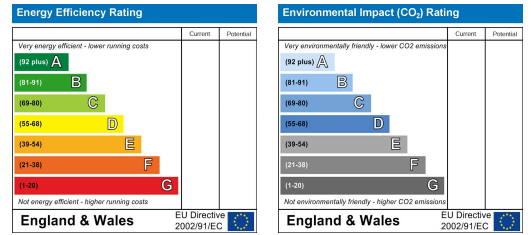

These particulars, whilst believed to be accurate are set out as a general outline only for guidance and do not constitute any part of an offer or contract. Intending purchasers should not rely on them as statements of representation of fact, but must satisfy themselves by inspection or otherwise as to their accuracy. No person in this firm's employment has the authority to make or give any representation or warranty in respect of the property.