



FLEXIAGENT

Market Leading, Independent Estate Agents



Poulton Road

Southport, PR9 7DB

Offers In Excess Of £190,000

Flexi-Agent are delighted to offer this fantastic two double bedroomed semi-detached family home. The property is situated in a sought after residential location nearby to a wealth of amenities, local schools and transport links.

This beautifully presented property would make an ideal first time buy and briefly comprises: Entrance hallway, Spacious lounge, dining room and a beautiful open plan modern kitchen with doors leading out to the rear gardens. To the first floor two double bedrooms and a fantastic family bathroom.

Externally the property benefits from ample driveway parking and generous sun catching rear gardens.

Early inspection of this property is strongly recommended to fully appreciate the accommodation on offer.

Council Tax Band B
EPC D
Freehold

Viewing is available immediately by appointment.

Viewing

Please contact our Flexi Agent Southport Office on 01704 889455 if you wish to arrange a viewing appointment for this property or require further information.

- Two bedrooms
- Two reception rooms
- Modern throughout
- Sought after location
- Generous gardens
- Driveway parking
- Family Bathroom
- Council Tax Band B
- Freehold
- Viewings available on request



Floor Plan

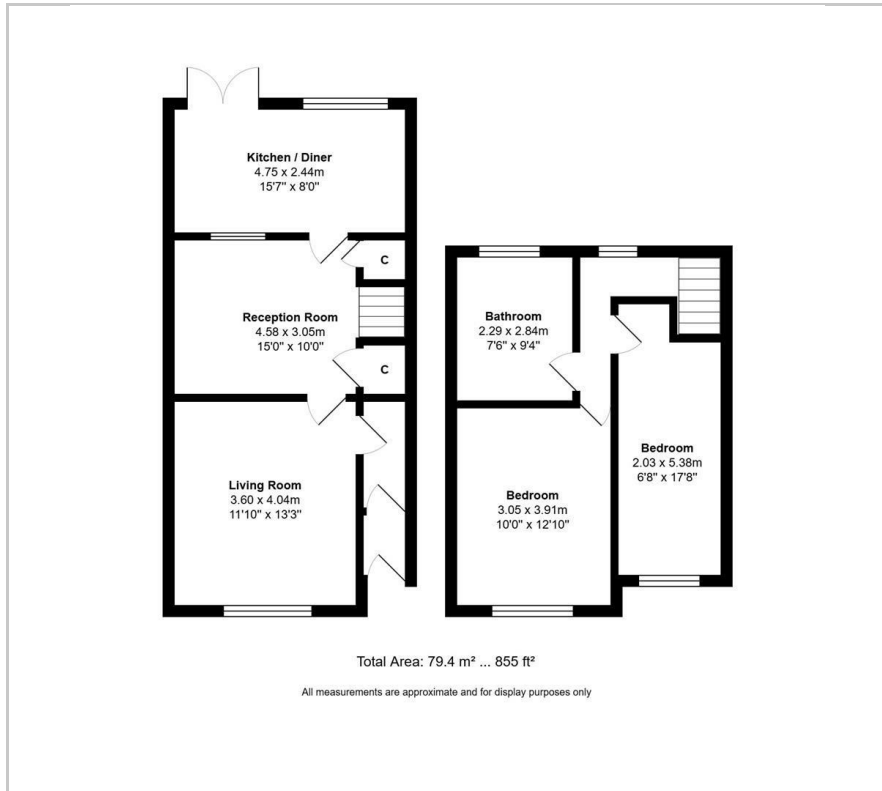

Area Map



Energy Efficiency Graph

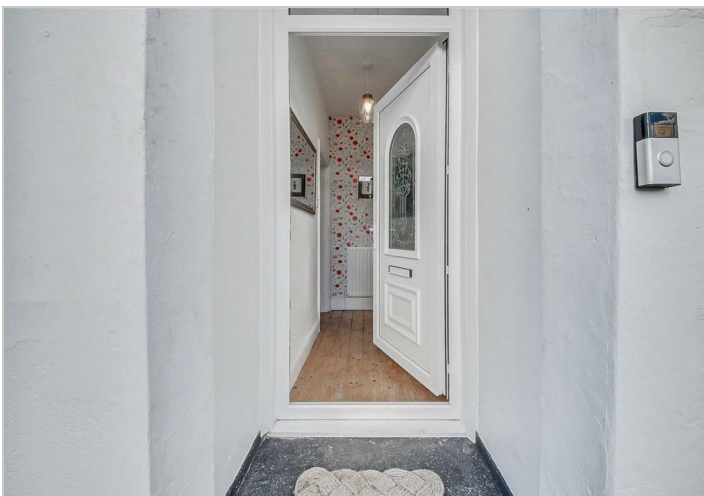
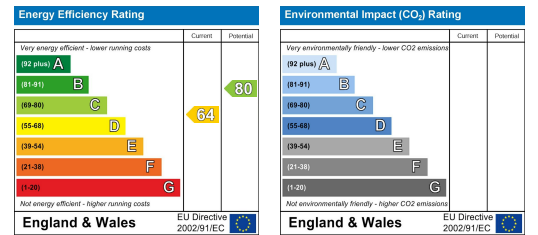

These particulars, whilst believed to be accurate are set out as a general outline only for guidance and do not constitute any part of an offer or contract. Intending purchasers should not rely on them as statements of representation of fact, but must satisfy themselves by inspection or otherwise as to their accuracy. No person in this firm's employment has the authority to make or give any representation or warranty in respect of the property.