



FLEXIAGENT

Market Leading, Independent Estate Agents



Liverpool Road

Southport, PR8 4DA

Offers In Excess Of £125,000

Flexi Agent are delighted to present this ONE DOUBLE BEDROOM duplex apartment to the open market. Positioned on the first & second floor of this recently refurbished block, close to Birkdale Village with a range of amenities, cafes, bars & shops as well as transport links into Southport town centre.

The property briefly comprises of; Communal entrance hall, double bedroom, stairs to the second floor, four piece bathroom & open plan kitchen and living room.

Externally the property offers communal parking to the front.

Viewings available upon request.

Leasehold: Details TBC
EPC C
Council tax band B

Viewing

Please contact our Flexi Agent Southport Office on 01704 889455 if you wish to arrange a viewing appointment for this property or require further information.

- One double bedroom
- Duplex apartment, circa 593 sqft
- Positioned on the first & second floor
- Downstairs lounge
- Open plan kitchen diner
- Four piece bathroom
- Communal parking to the front
- Recently refurbished block
- Close to Birkdale Village
- Viewings available upon request



Floor Plan

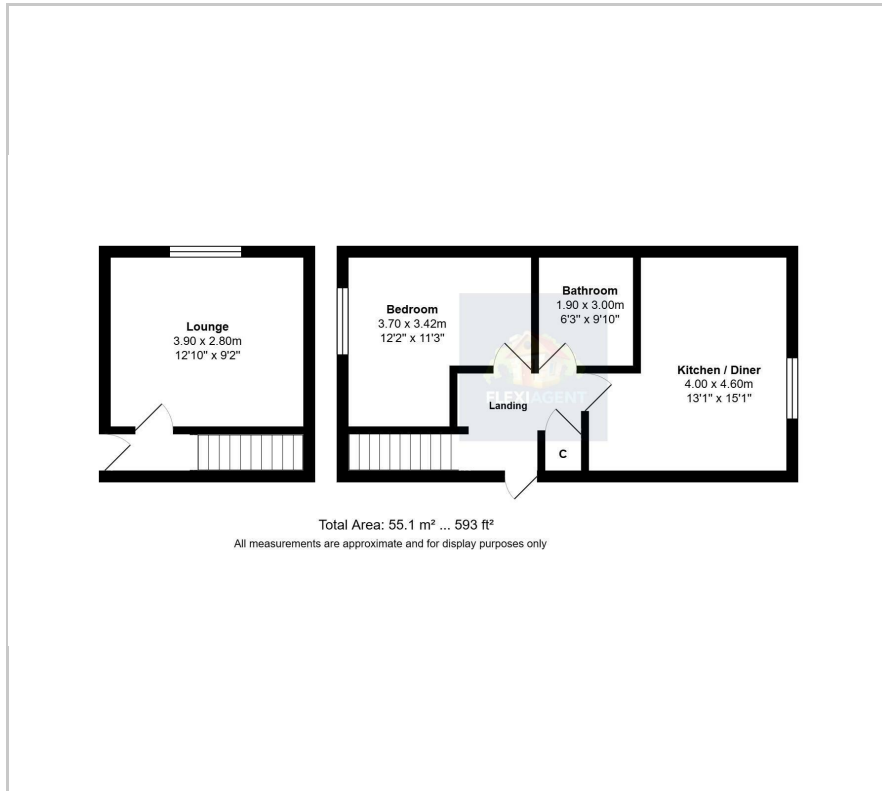

Area Map



Energy Efficiency Graph

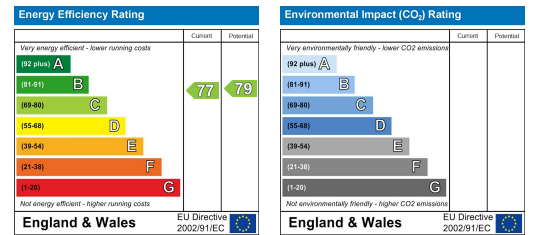

These particulars, whilst believed to be accurate are set out as a general outline only for guidance and do not constitute any part of an offer or contract. Intending purchasers should not rely on them as statements of representation of fact, but must satisfy themselves by inspection or otherwise as to their accuracy. No person in this firm's employment has the authority to make or give any representation or warranty in respect of the property.