



Tinsley Avenue

Southport, PR8 6HT

£280,000

Flexi-Agent are delighted to present this three bedrooms bungalow to the open market. Located near Meols Cop retail park offering a range of amenities & shops, as well as great local schools & transport links into Southport town centre. Available for purchase with NO ONWARDS CHAIN.

The property briefly comprises of; entrance porch, spacious living room, shower room, nicely presented kitchen, three bedrooms & access to garage.

Externally the property offers front drive parking & garage, to the rear offers a sun catching garden & garden shed.

Viewings available upon request.

Freehold
NO CHAIN
EPC: C
Council tax band: D

Viewing

Please contact our Flexi-Agent Southport Lettings Office on 01704 889455 if you wish to arrange a viewing appointment for this property or require further information.

- Three bedrooms
- Detached bungalow, circa 1094 sqft
- NO CHAIN
- Spacious front living room
- Shower room
- Nicely presented kitchen
- Front drive & garage
- Rear sun catching garden
- Close to Meols Cop retail park
- Viewings available upon request



Floor Plan

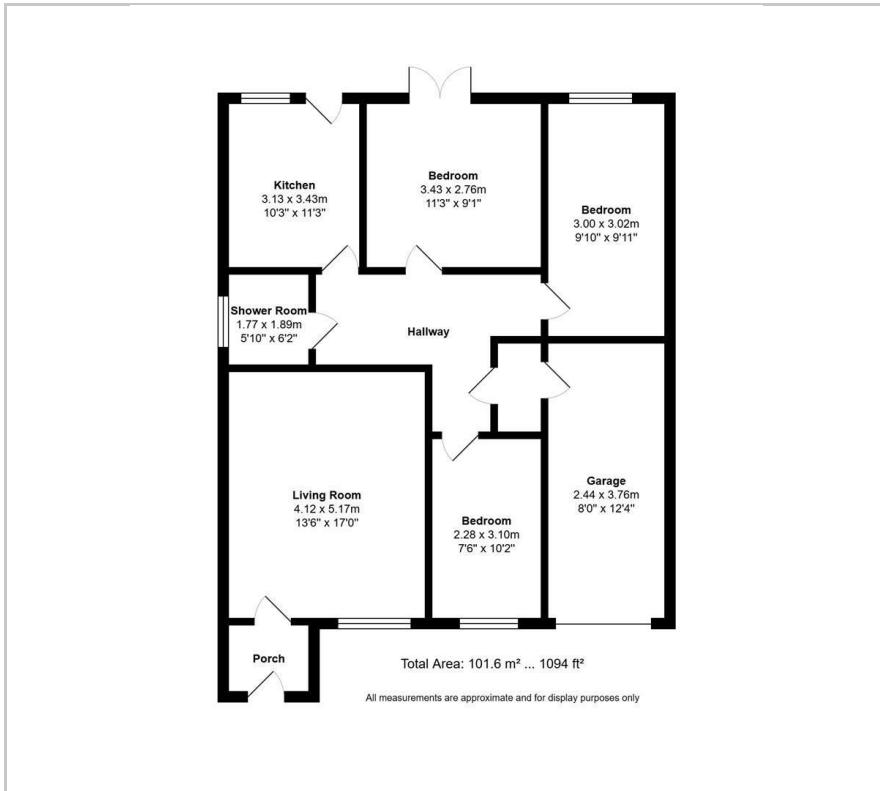

Area Map



Energy Efficiency Graph

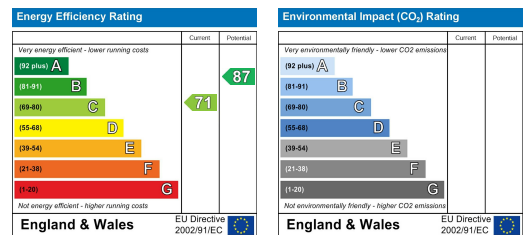

These particulars, whilst believed to be accurate are set out as a general outline only for guidance and do not constitute any part of an offer or contract. Intending purchasers should not rely on them as statements of representation of fact, but must satisfy themselves by inspection or otherwise as to their accuracy. No person in this firm's employment has the authority to make or give any representation or warranty in respect of the property.