



FLEXIAGENT

Market Leading, Independent Estate Agents



Park Road

Southport, PR9 9JP

Offers In Excess Of £115,000

Flexi-Agent are delighted to present this spacious first floor two bedroom apartment to the open market. Located in Southport, it is surrounded by a wealth of local amenities, has easy access to local transport links and the A565 leading in and out of the town centre and is a stones throw from the beautiful Marina Lake, Hesketh Park and Southport sea front.

This would make an ideal first-time buy or investment opportunity and briefly comprises; Communal entrance hall, private entrance, spacious living room with a central fireplace, modern fitted kitchen, Two bedrooms and a good sized bathroom suite.

Externally, there are well kept communal lawned gardens and there is an allocated garage and parking to the rear.

NO CHAIN

Viewing

Please contact our Flexi Agent Southport Office on 01704 889455 if you wish to arrange a viewing appointment for this property or require further information.

- Apartment
- Two double bedrooms
- White gloss fitted kitchen
- Modern fitted bathroom
- Spacious lounge
- Well kept communal gardens
- Allocated garage & parking to the rear
- Ideal investment opportunity
- Ideal first time buy
- Viewings available upon request



2



1



1



D

Floor Plan

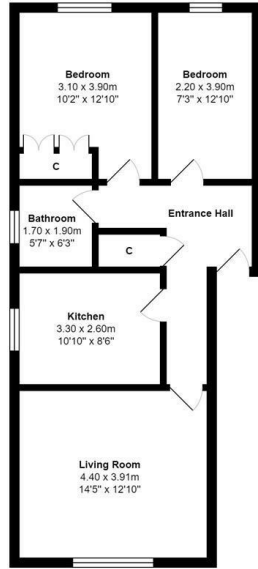

Total Area: 62.6 m² ... 674 ft²

All measurements are approximate and for display purposes only

Area Map



Energy Efficiency Graph

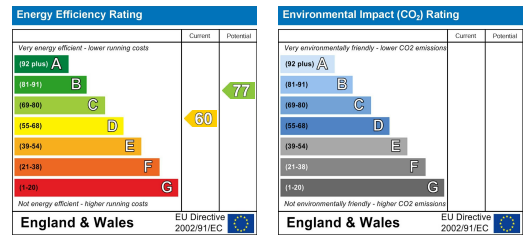

These particulars, whilst believed to be accurate are set out as a general outline only for guidance and do not constitute any part of an offer or contract. Intending purchasers should not rely on them as statements of representation of fact, but must satisfy themselves by inspection or otherwise as to their accuracy. No person in this firm's employment has the authority to make or give any representation or warranty in respect of the property.