



FLEXIAGENT

Market Leading, Independent Estate Agents



Compton Road

Southport, PR8 4HA

£1,200 Per Month

Flexi-Agent are proud to present this three bedroom, semi-detached property, situated in a sought after residential location. Compton Road is situated in the sought after district of Birkdale, and is within walking distance of the village, amongst a host of other amenities.

The property briefly comprises: Entrance hallway, spacious living room, open plan kitchen diner with patio door leading to the generous rear garden and a modern downstairs shower room.

To the first floor three well-proportioned bedrooms.

Externally the property benefits from ample driveway parking a a generous south facing garden to the rear,

Council Tax Band B
Deposit £1384.61

Viewing

Please contact our Flexi Agent Southport Office on 01704 889455 if you wish to arrange a viewing appointment for this property or require further information.

- Three bedrooms
- Modern throughout
- Recently refurbished
- Semi detached
- Sought after location
- Generous garden
- Driveway parking
- Two reception rooms
- Deposit £1471.15
- Council tax band B



Floor Plan

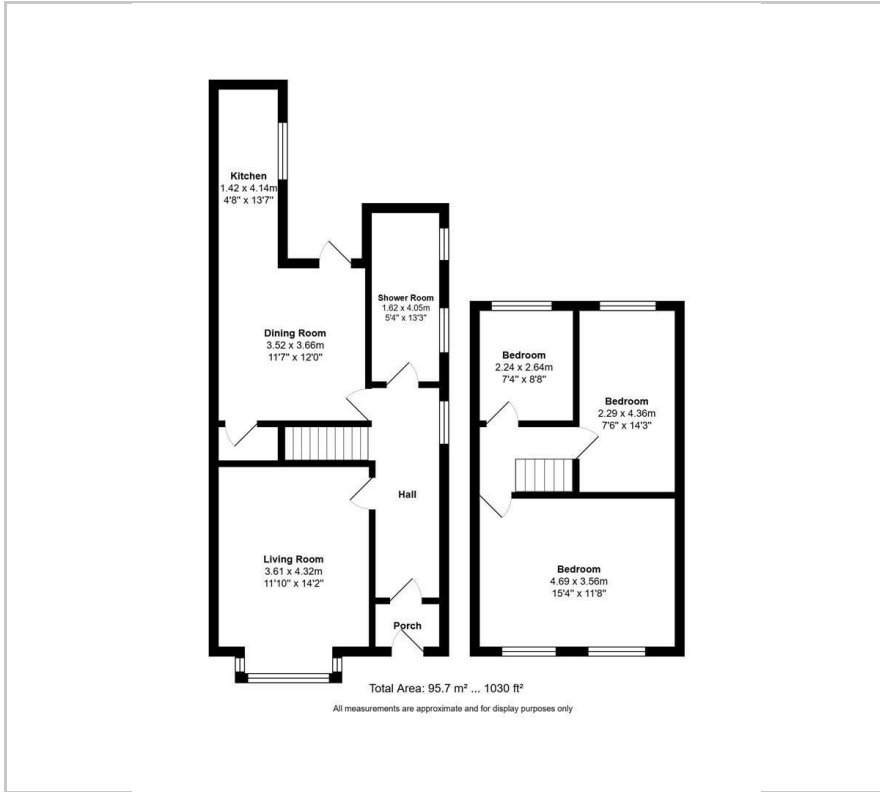

Area Map

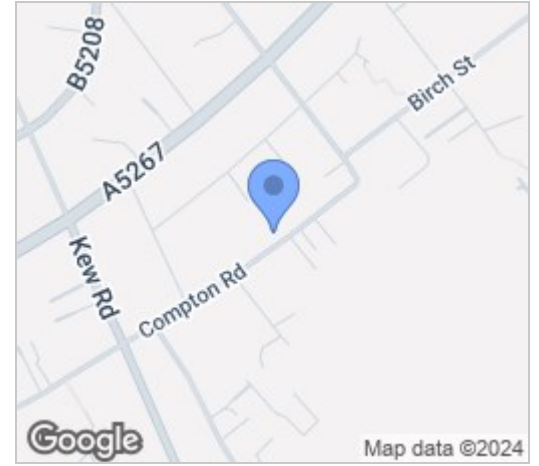

Energy Efficiency Graph

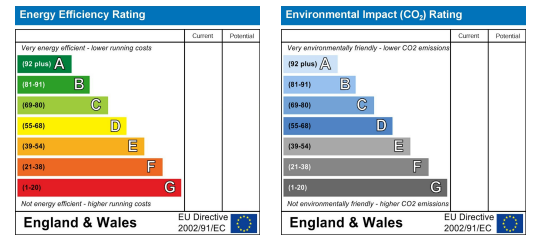

These particulars, whilst believed to be accurate are set out as a general outline only for guidance and do not constitute any part of an offer or contract. Intending purchasers should not rely on them as statements of representation of fact, but must satisfy themselves by inspection or otherwise as to their accuracy. No person in this firm's employment has the authority to make or give any representation or warranty in respect of the property.