



FLEXIAGENT

Market Leading, Independent Estate Agents



Bedford Road

Southport, PR8 4HJ

Offers In The Region Of £190,000

Flexi-Agent are delighted to present this TWO DOUBLE BEDROOM semi detached property to the open market. Located a short distance from the vibrant Birkdale Village with its plethora of shops, restaurants and bars, it is surrounded by a wealth of local amenities and local transport links. Ideal first time buy / investment property. Available for purchase with NO ONWARD CHAIN.

The property briefly comprises of; front lounge with bay window, spacious lounge diner, galley style kitchen with storage cupboard.

The first floor briefly comprises of; two double bedrooms & nicely presented three piece bathroom.

Externally the property offers driveway parking to the front, to the rear offers a spacious sun catching garden.

Viewings available upon request.

NO CHAIN
Freehold
Council tax band: B

Viewing

Please contact our Flexi Agent Southport Office on 01704 889455 if you wish to arrange a viewing appointment for this property or require further information.

- TWO DOUBLE BEDROOM
- Semi detached
- Close to Birkdale village
- NO CHAIN
- Front lounge with bay window
- Galley style kitchen with storage cupboard
- Nicely presented three piece bathroom
- Driveway parking
- Spacious sun catching garden
- Viewings available upon request



2



1



2



Floor Plan

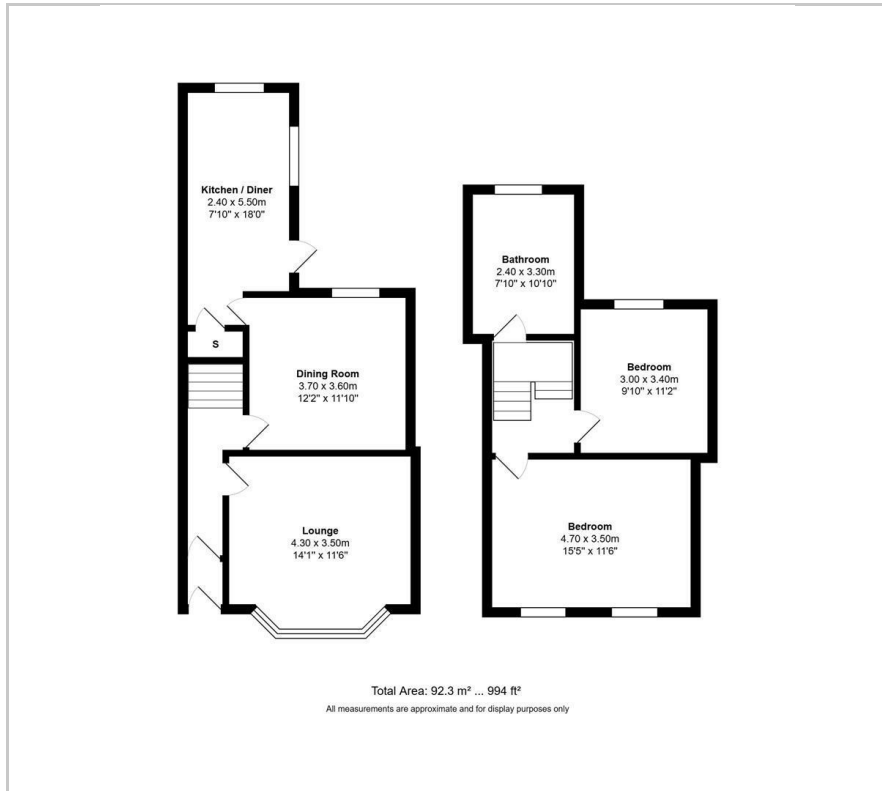

Area Map



Energy Efficiency Graph

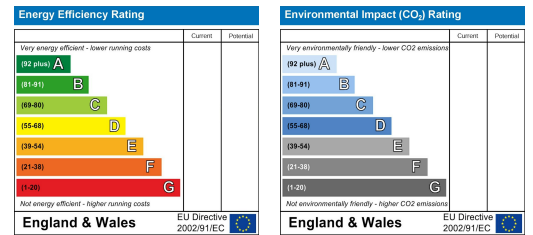

These particulars, whilst believed to be accurate are set out as a general outline only for guidance and do not constitute any part of an offer or contract. Intending purchasers should not rely on them as statements of representation of fact, but must satisfy themselves by inspection or otherwise as to their accuracy. No person in this firm's employment has the authority to make or give any representation or warranty in respect of the property.