



FLEXIAGENT

Market Leading, Independent Estate Agents



The Ridings

Southport, PR9 8NG

Offers In The Region Of £110,000

Flexi-Agent are delighted to present this two bedroom ground floor retirement apartment to the open market, residents to be fifty five and above. Located in the sought after residential area of Churchtown, it's within a short walk to Churchtown Village, Botanic Gardens & has easy access in and out of Southport Town Centre via the A565 with a brilliant bus route service. The location is also surrounded by a wealth of local amenities including many shops, restaurants and bars.

The property briefly comprises of; spacious lounge, nicely presented kitchen, two bedrooms, four piece bathroom>

Externally the property offers resident parking & beautifully maintained communal gardens.

Viewings available upon request.

Leasehold details TBC
Council tax band: C
EPC: C

Viewing

Please contact our Flexi Agent Southport Office on 01704 889455 if you wish to arrange a viewing appointment for this property or require further information.

- Two bedroom
- Ground floor
- Apartment
- Spacious lounge
- Nicely presented kitchen
- Four piece bathroom
- Close to Birkdale Village
- Communal gardens
- Resident parking
- Viewings available upon request



Floor Plan

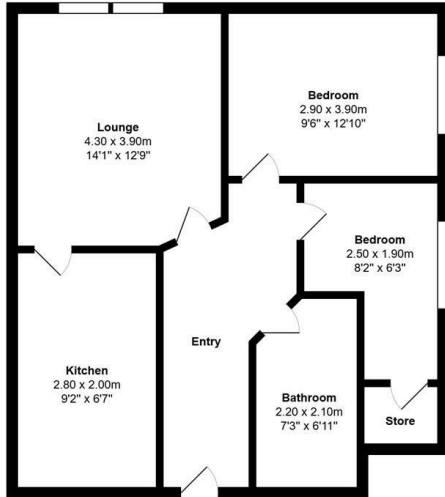

Total Area: 82.8 m² ... 892 ft²
All measurements are approximate and for display purposes only

Area Map



Energy Efficiency Graph

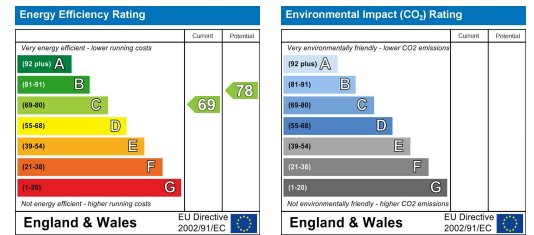

These particulars, whilst believed to be accurate are set out as a general outline only for guidance and do not constitute any part of an offer or contract. Intending purchasers should not rely on them as statements of representation of fact, but must satisfy themselves by inspection or otherwise as to their accuracy. No person in this firm's employment has the authority to make or give any representation or warranty in respect of the property.