



FLEXIAGENT

Market Leading, Independent Estate Agents



Hart Street

Southport, PR8 6BT

Offers Over £160,000

Flexi-Agent are pleased to welcome this two bedroom semi-detached property situated in a popular residential location situated close to amenities and rail links. This property is an ideal first time purchase and is well presented throughout.

The property briefly comprises: entrance hall, entrance hallway, an open plan living diner and extended kitchen to the ground floor. The first floor offers two well proportioned double bedrooms and a family bathroom.

Externally, this stylish home offers driveway parking to the front and a well presented, sun-catching private garden to the rear.

Viewing is available immediately by appointment.

FREEHOLD
Council Tax Band B

Viewing

Please contact our Flexi Agent Southport Office on 01704 889455 if you wish to arrange a viewing appointment for this property or require further information.

- Two bedrooms
- Semi-detached
- Circa 924 square feet
- Open plan living diner
- Well presented
- Ideal first time purchase
- Excellent residential location
- Driveway parking
- Sun-catching rear garden
- Viewing is available immediately by appointment



Floor Plan

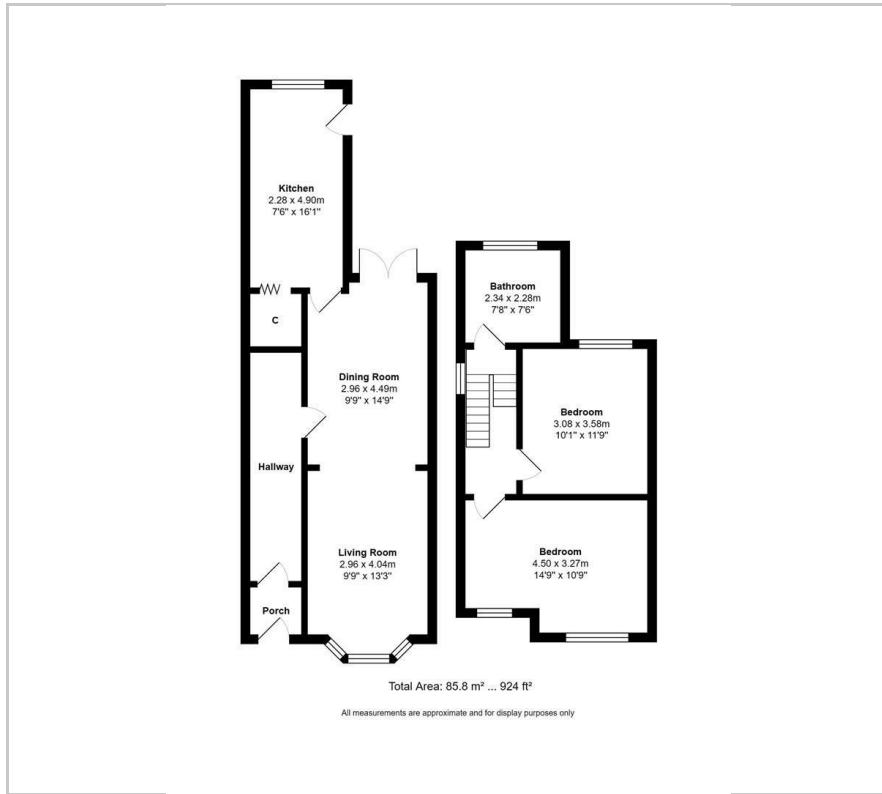

Area Map

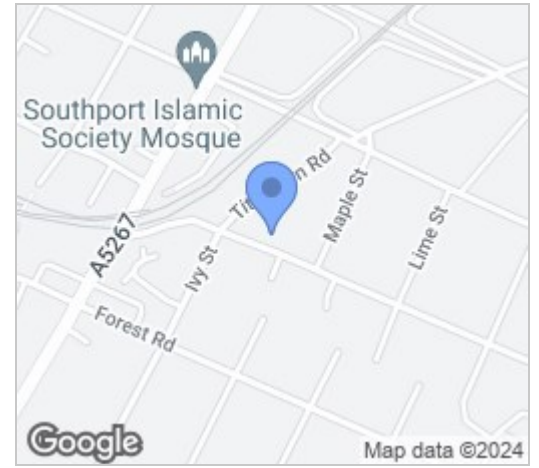

Energy Efficiency Graph

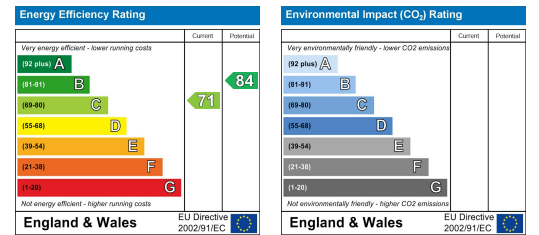

These particulars, whilst believed to be accurate are set out as a general outline only for guidance and do not constitute any part of an offer or contract. Intending purchasers should not rely on them as statements of representation of fact, but must satisfy themselves by inspection or otherwise as to their accuracy. No person in this firm's employment has the authority to make or give any representation or warranty in respect of the property.