



FLEXIAGENT

Market Leading, Independent Estate Agents



Leyland Road

Southport, PR9 0JL

Offers In Excess Of £100,000

Flexi-Agent are proud to present this modern, ground floor, DOUBLE bedroom apartment within walking distance from Hesketh Park, Ocean Plaza and the Southport Town Centre. This property is an ideal first time/investment purchase. The area is well sought after with wide open streets and well looked after establishments.

This apartment briefly comprises; A DOUBLE bedroom, a contemporary kitchen with integrated appliances, a welcoming hallway, an airy lounge, white three-piece bathroom and a storage cupboard.

Externally, the property offers a parking space for the tenant and a communal garden to the rear.

NO CHAIN

Viewing available upon request.

Viewing

Please contact our Flexi Agent Southport Office on 01704 889455 if you wish to arrange a viewing appointment for this property or require further information.

- Apartment, Circa 766ft
- Single DOUBLE bedroom
- Contemporary kitchen/diner
- Airy lounge
- White three-piece bathroom
- Welcoming hallway
- Parking to the front
- Walking distance from Hesketh Park, Ocean Plaza and the Southport Town Centre
- NO CHAIN
- Viewings are available upon request.



Floor Plan

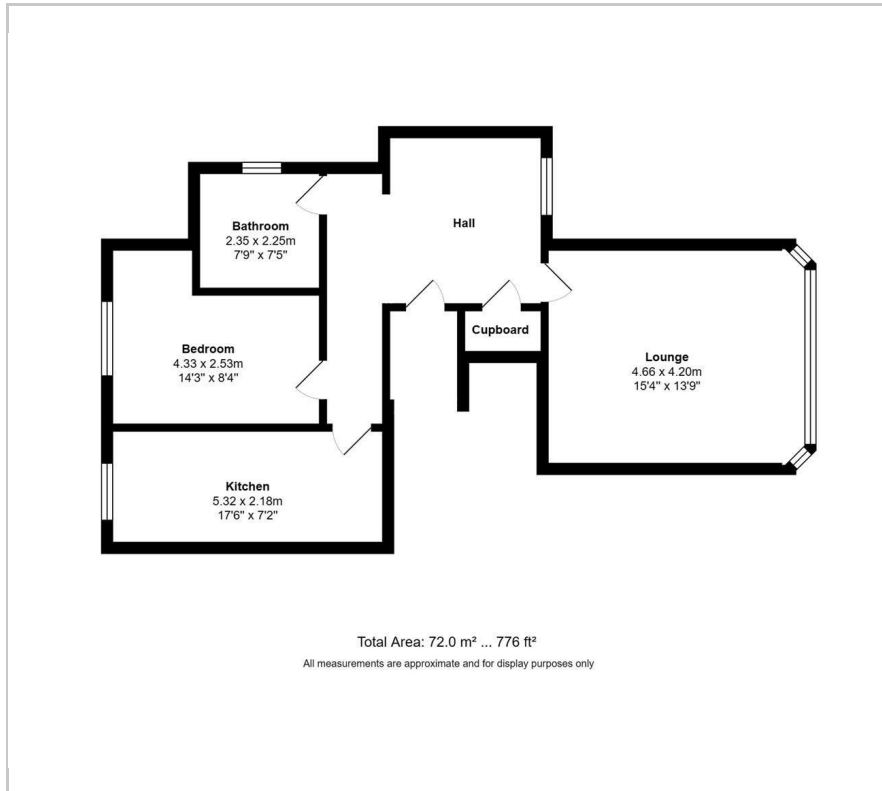

Area Map



Energy Efficiency Graph

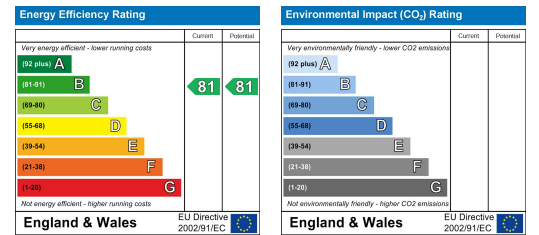

These particulars, whilst believed to be accurate are set out as a general outline only for guidance and do not constitute any part of an offer or contract. Intending purchasers should not rely on them as statements of representation of fact, but must satisfy themselves by inspection or otherwise as to their accuracy. No person in this firm's employment has the authority to make or give any representation or warranty in respect of the property.