



FLEXIAGENT

Market Leading, Independent Estate Agents



Eastbourne Road

Southport, PR8 4DT

£240,000

Flexi-Agent is delighted to present this four bedroom semi-detached property to the open market. Located in the sought after area of Birkdale the property is surrounded by a plethora of amenities, excellent local schools and great transport links into Southport Town Centre.

The property briefly comprises a welcoming entrance hall, a spacious lounge with a feature bay window, an airy dining room and a modern shaker style kitchen with integrated appliances and breakfast bar.

The first floor presents four generous bedrooms and a fully tiled three-piece family bathroom.

Externally the property benefits from ample driveway for two cars to the front of the property and a sun-catching rear garden with patio area to the rear.

Early inspection of the property is highly recommended to fully appreciate the accommodation on offer.

Viewings available upon request.

Freehold

Viewing

Please contact our Flexi Agent Southport Office on 01704 889455 if you wish to arrange a viewing appointment for this property or require further information.

- Semi-detached house Circa 1165sqft
- Four generous bedrooms
- Spacious lounge
- Modern Shaker style kitchen
- Airy dining room
- Fully tiled three-piece family bathroom
- Ample driveway parking
- Sun-catching rear garden with patio
- Located in the sought after area of Birkdale
- Viewings are available upon request



4



1



2



Floor Plan

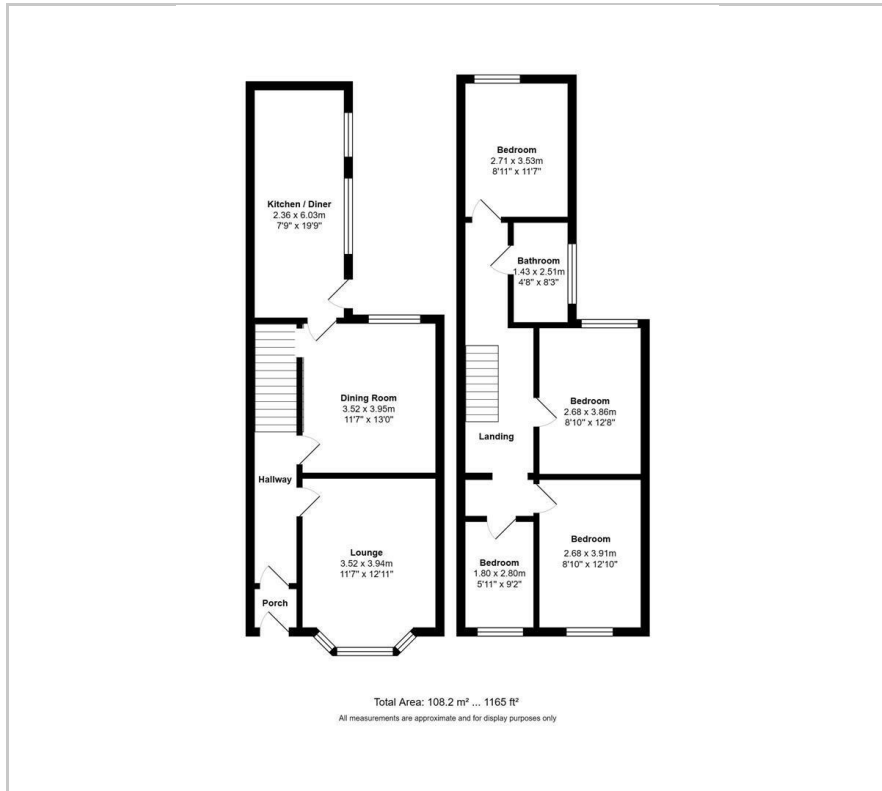

Area Map



Energy Efficiency Graph

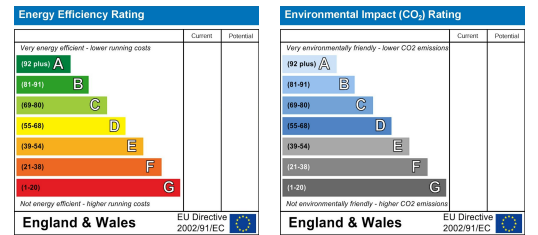

These particulars, whilst believed to be accurate are set out as a general outline only for guidance and do not constitute any part of an offer or contract. Intending purchasers should not rely on them as statements of representation of fact, but must satisfy themselves by inspection or otherwise as to their accuracy. No person in this firm's employment has the authority to make or give any representation or warranty in respect of the property.