



FLEXIAGENT

Market Leading, Independent Estate Agents



20 Park Road Southport, PR9 9LA £650 Per Month

Flexi-Agent are delighted to offer this one double bedroomed apartment located on the second floor, situated in the highly sought after Hesketh Park district. Churchtown Village, Hesketh Park, Hesketh Golf Club & Southport Town Centre are all within walking distance.

The property briefly comprises; Communal entrance hall with an intercom entry system, brand new composite front entrance door, private entrance hall with two useful storage cupboards, open plan living diner, fitted kitchen, one double bedroom and a fitted three-piece bathroom with floor to wall tiling.

Externally the development boasts beautifully maintained gardens and private residents parking

Viewings available upon request.

Council Tax Band: A

Viewing

Please contact our Flexi Agent Southport Office on 01704 889455 if you wish to arrange a viewing appointment for this property or require further information.

- Apartment
- DOUBLE bedroom
- Situated on the second floor
- Open plan living diner
- Three-piece bathroom
- Private residential parking
- Walking distance from Hesketh Park & Lord St which offers a wealth of amenities from shops, bars, boutiques and many more
- Sought after residential location
- Viewings available upon request.



Floor Plan

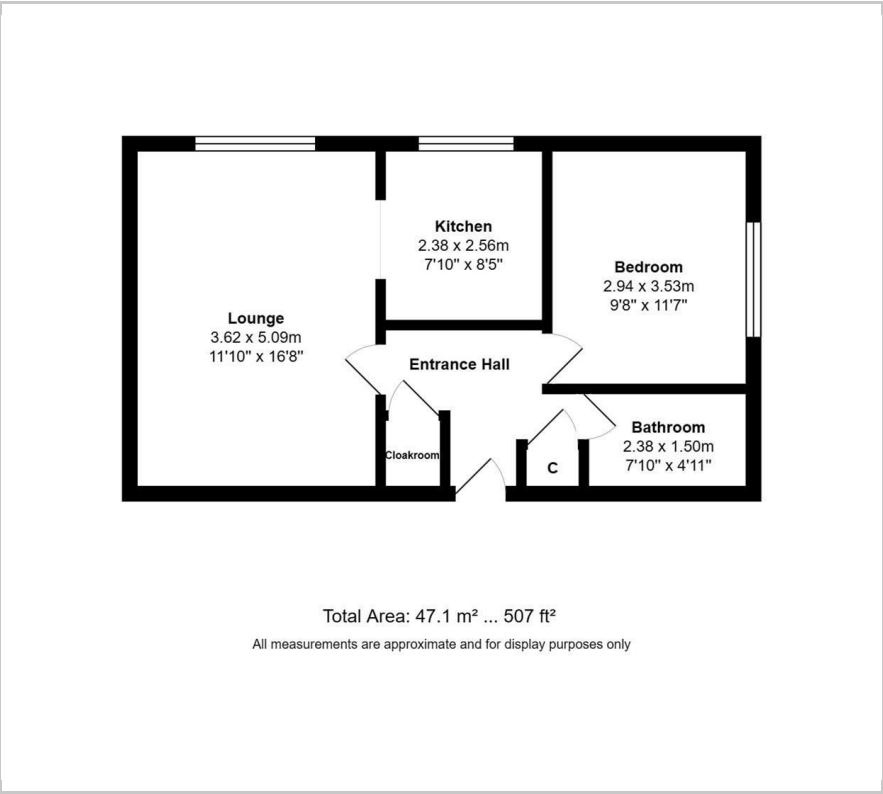

Area Map



Energy Efficiency Graph

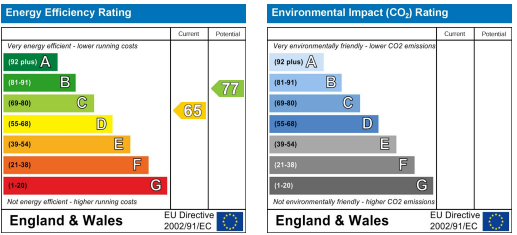

These particulars, whilst believed to be accurate are set out as a general outline only for guidance and do not constitute any part of an offer or contract. Intending purchasers should not rely on them as statements of representation of fact, but must satisfy themselves by inspection or otherwise as to their accuracy. No person in this firms employment has the authority to make or give any representation or warranty in respect of the property.