

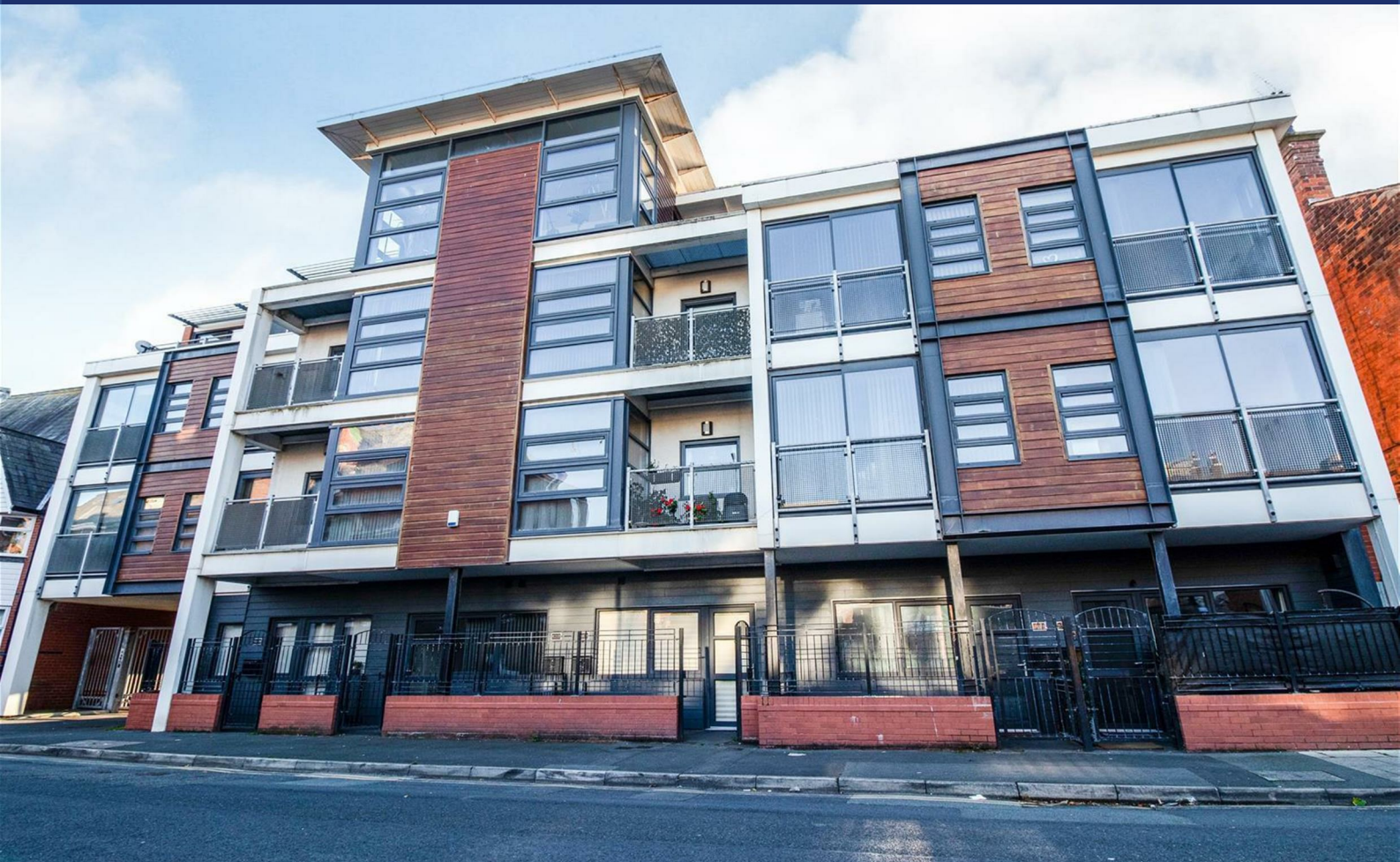

FLEXIAGENT

Market Leading, Independent Estate Agents



Market Street

Southport, PR8 1HJ

Offers In Excess Of £150,000

Flexi-Agent are proud to present this two DOUBLE bedroom, first floor apartment in a modern purpose built block to the open market. Located in the heart of Southport town centre, it is surrounded by a wealth of amenities including shops, restaurants and bars as well as excellent transport links to both Southport, Liverpool and Preston. Available to purchase with NO ONWARDS CHAIN!

The property briefly comprises: Communal entrance hallway, private entrance hallway with useful storage cupboard, a spacious open plan lounge/diner with Juliet balcony, an open aspect modern high gloss fitted kitchen with built-in appliances, two DOUBLE bedrooms both with storage cupboards and the master with a good size en-suite and a fully tiled, white three piece shower room.

Externally, the property benefits from one allocated parking space at the rear.

Leasehold - 999 years - 974 remaining
Service charge £1,200 p.a. (approx)
Ground rent £200 p.a.
Council tax band B
EPC C

Viewings available upon request.

Viewing

Please contact our Flexi Agent Southport Office on 01704 889455 if you wish to arrange a viewing appointment for this property or require further information.



Floor Plan

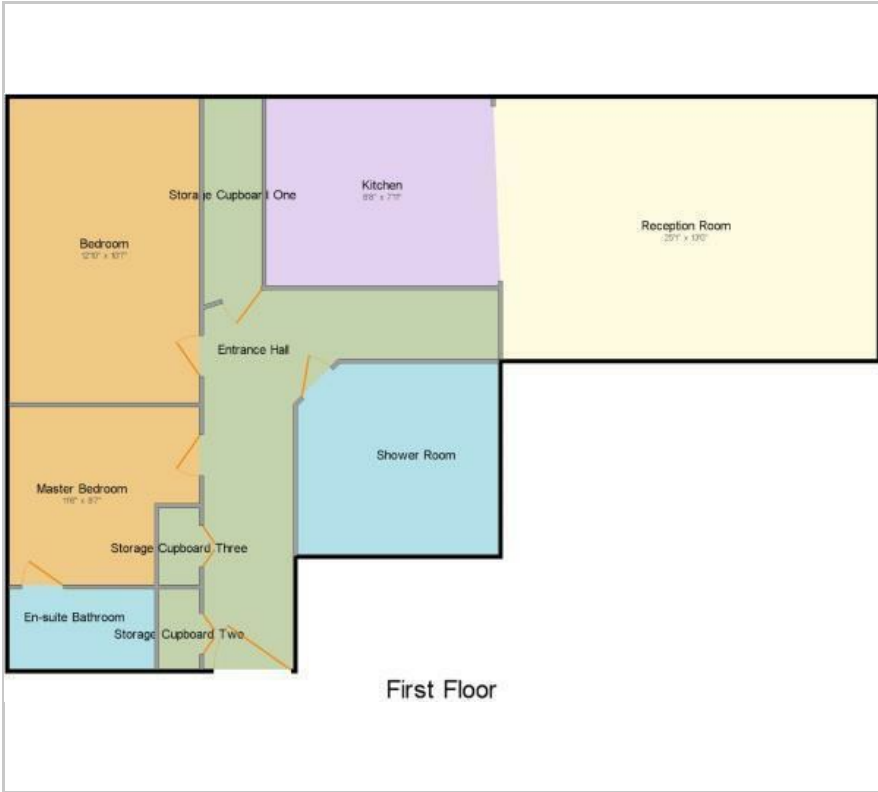

Area Map



Energy Efficiency Graph

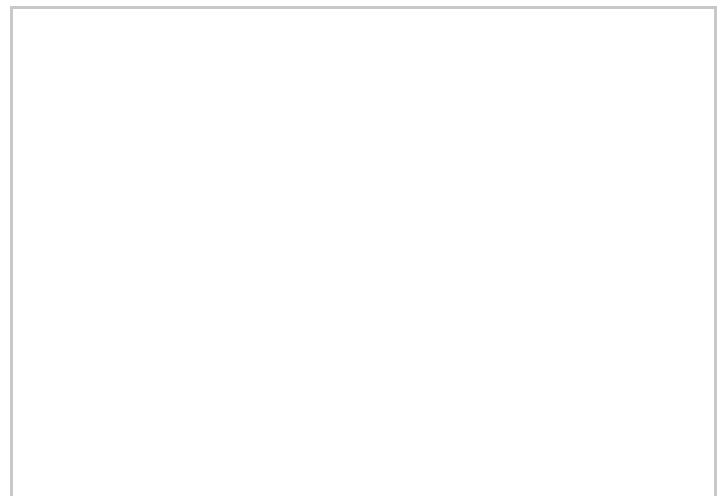
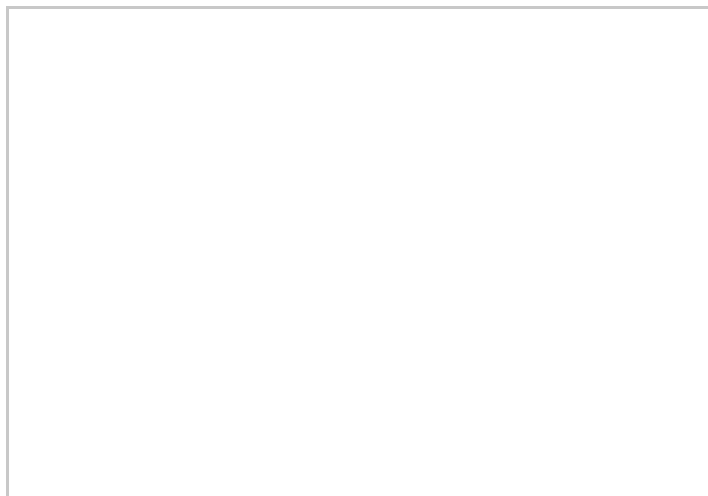
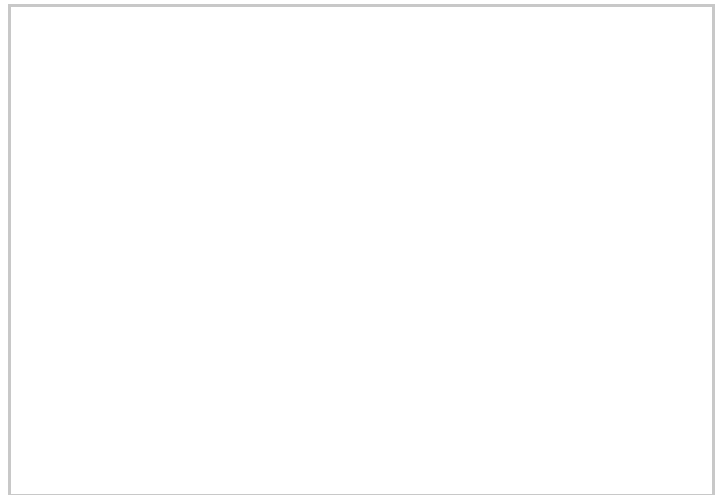
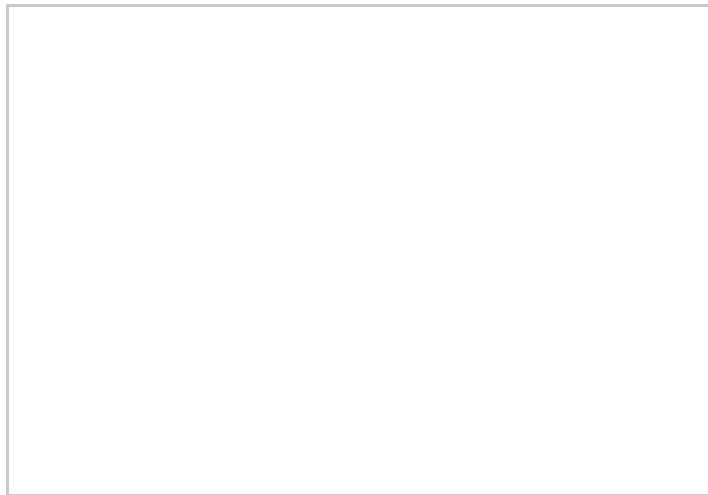
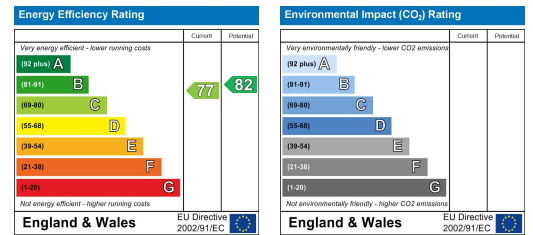

These particulars, whilst believed to be accurate are set out as a general outline only for guidance and do not constitute any part of an offer or contract. Intending purchasers should not rely on them as statements of representation of fact, but must satisfy themselves by inspection or otherwise as to their accuracy. No person in this firm's employment has the authority to make or give any representation or warranty in respect of the property.