



CREST
NICHOLSON

THE KESWICK

Set over two-storeys, the Keswick is a spacious and intelligently laid-out family home. Its open-plan kitchen-dining area forms the heart of the house and a generous living room looks out over the private garden through full height patio doors. The ground floor study with its bay window also benefits from considerable natural light, providing a private space for homeworking. Upstairs, the large master bedroom has the benefit of an en suite bathroom and three further bedrooms share a family bathroom.

4 BEDROOM HOME





**CREST
NICHOLSON**

THE KESWICK

4 Bedroom Home

Total Area: 1222 sq ft

crestnicholson.com

GROUND FLOOR

DINING AREA

3.61m x 2.91m 11'10" x 9'6"

KITCHEN

3.09m x 3.03m • 10'1" x 9'11" •

LIVING ROOM

4.81m x 3.35m 15'9" x 11'0"

STUDY

3.41m • x 2.47m 11'2" • x 8'1"



FIRST FLOOR

BEDROOM 1

4.38m • x 3.48m • 14'4" • x 11'5" •

BEDROOM 2

3.13m x 3.01m 10'3" x 9'10"

BEDROOM 3

3.38m • x 2.91m • 11'1" • x 9'6" •

BEDROOM 4

3.23m • x 2.49m • 10'7" • x 8'2" •

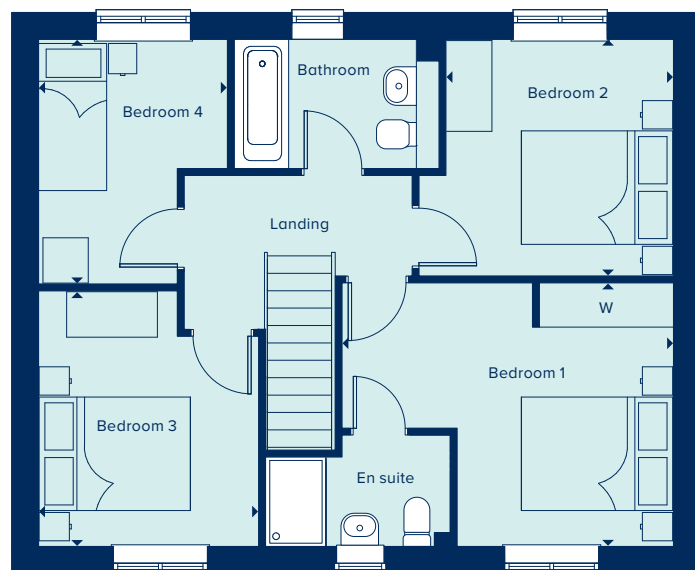

C Cupboard W Wardrobe • Max Dimension

All images are used for illustrative purposes only and are not necessarily a precise representation. Images may be of a slightly different model of home and may include different specifications for example in respect of brick colour and options which involve additional cost. Individual features such as window, brick, carpets, paint and other material colours may vary and the specification of fittings may vary. Any furnishings and furniture are not included in any sale. Please check with our sales representatives for details of the exact specifications available at the development for each type of home. STU8637/October 2020.

