



15 Cooper Road, Guildford GU1 3LY



COLLINS
Independent Estate Agent





15 Cooper Road Guildford GU1 3LY

Asking price £530,000
Freehold

A classic cream painted Victorian terraced house in the sought after Charlotteville district of Guildford town centre. The property has been well cared for with significant improvements made in recent times to include a new roof in 2020 and the conversion of the loft space. The front elevation has new sash style windows installed in 2023 and a smart red painted front door. Both the kitchen and bathroom are refitted with the kitchen being a long galley style with a window over looking the gardens. The bathroom is very tastefully fitted and ensuite to the rear double bedroom. The property has many original features including fireplaces combined with recent upgrades, best displayed in the sitting room that features a new solid oak wooden floor and a log burner to the dining room. Outside the pretty cottage garden is lawned with a large storage area, side access and wood block terrace.



- Victorian Charlotteville home
- Unique town centre location
- Two bedrooms and a loft room
- Two receptions
- Gas central heating
- Lovely peaceful garden
- EPC - C
- Council tax band - D





Cooper Rd is a truly unique place to settle in Guildford town with its strong Charlotteville community spirit, proud heritage and most convenient position for excellent schooling, commuting, leisure and the High Street. Miles of beautiful protected countryside walks and spectacular views are found a few minutes away by foot on Pewley Down. From this location you can walk to school, the shops, the station, restaurants and bars. This is a very special place to live.



COLLINS

Independent Estate Agent

Parallel House, 32 London Road
Guildford, Surrey GU1 2AB

Telephone | 01483 230 473
info@collinsguildford.co.uk

www.collinsguildford.co.uk



Cooper Road, Guildford, GU1

Approximate Area = 818 sq ft / 75.9 sq m

Limited Use Area(s) = 122 sq ft / 11.3 sq m

Total = 940 sq ft / 87.2 sq m

For identification only - Not to scale

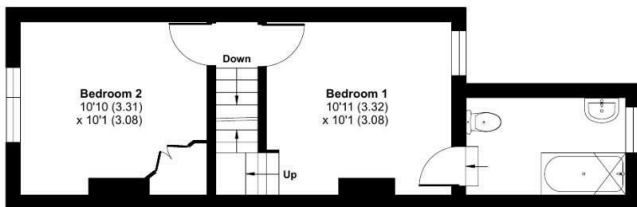

FIRST FLOOR

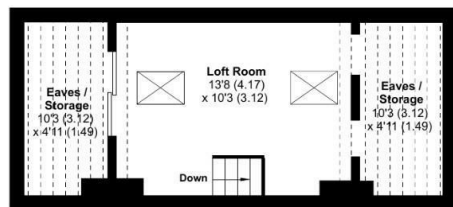

SECOND FLOOR

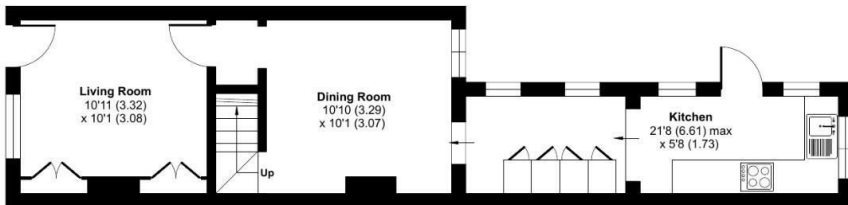

GROUND FLOOR



Floor plan produced in accordance with RICS Property Measurement 2nd Edition, Incorporating International Property Measurement Standards (IPMS2 Residential). © nchecom 2025. Produced for Mark Collins (Guildford) Limited. REF: 1359371



Important Notice To Purchasers : We endeavour to make our sales particulars accurate and reliable, however they do not constitute or form part of an offer or any contract and none is to be relied upon as statements of representation or fact. The services and appliances listed in this specification have not been tested by us and no guarantees as to their operating ability or efficiency are given. All measurements have been taken as a guide to prospective buyers only, and are not precise. If you require clarification on further information on any points, please contact us, especially if you are travelling some distance to view.