



Land at Bulbourne Road, Tring, HP23 5HF
Offers In Excess Of £450,000



LAND FOR SALE. ****OFFERS REQUIRED BY 31ST JULY 2024**** A very unique opportunity to purchase approximately 0.231 Acres / 0.093 Hectares, with potential for residential development, subject to planning and other consents.

Located in the historic market town of Tring. The town centre offers a host of independent shops catering for all needs and the nearby train station provides a fast and frequent service to London Euston (approximately 35 minutes) as well as the A41 which offers quick access to the M25. Tring provides excellent schooling for all age groups and also a wide range of excellent sporting facilities.

Freehold Tenure.

- LAND FOR SALE
- FREEHOLD
- APPROXIMATLY 0.231 Acres / 0.093 Hectares
- POTENTIAL DEVELOPMENT OPPORTUNITY



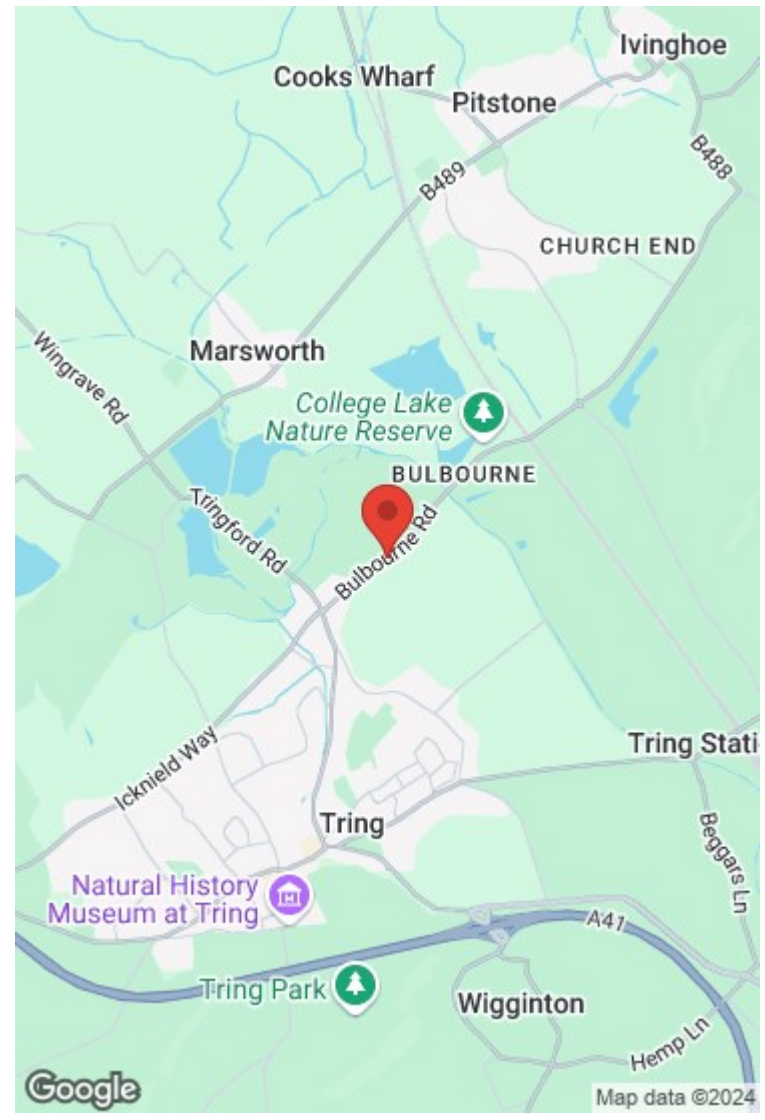
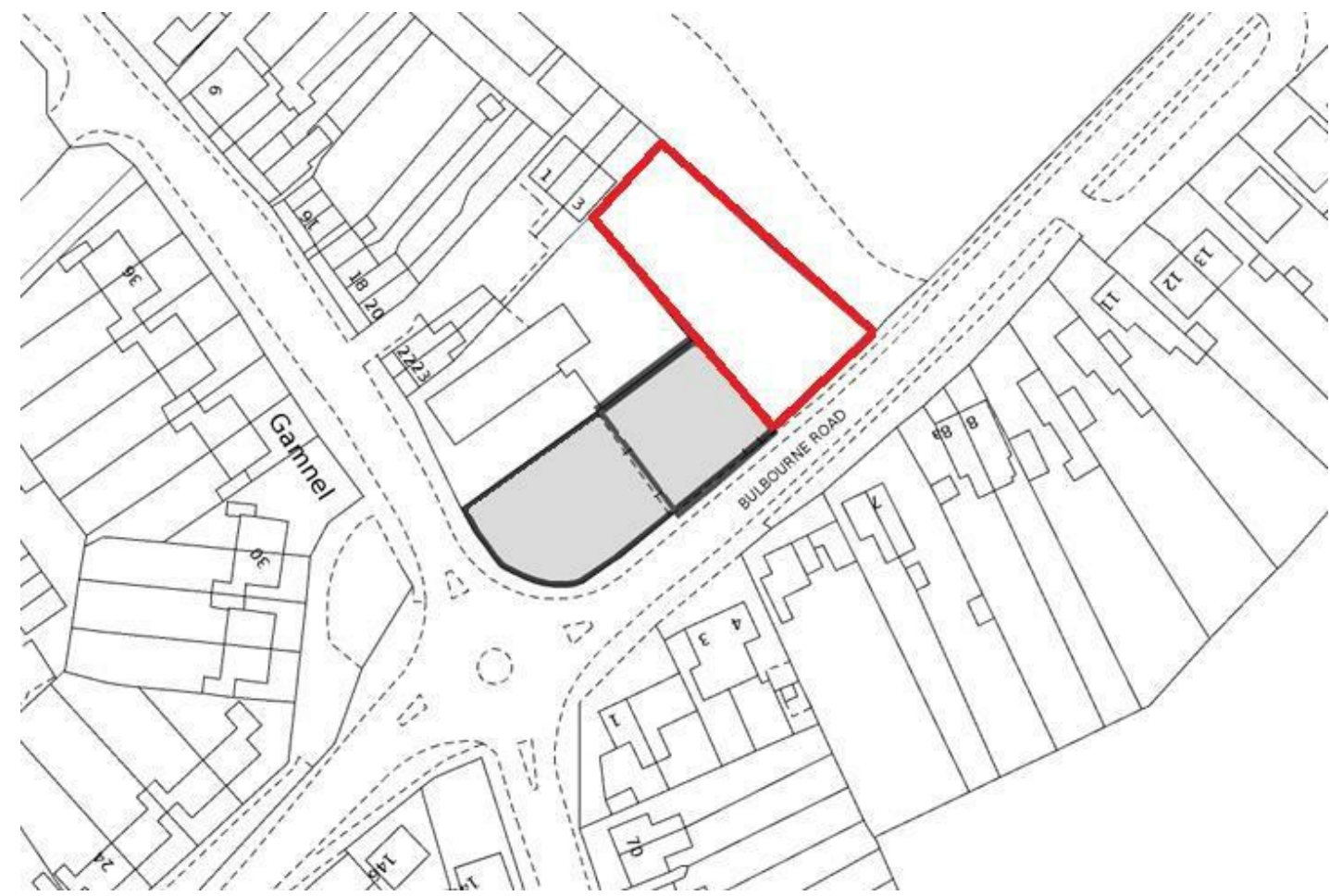



These particulars, whilst believed to be accurate are set out as a general outline only for guidance and do not constitute any part of an offer or contract. Intending purchasers should not rely on them as statements of representation of fact, but must satisfy themselves by inspection or otherwise as to their accuracy. No person in this company's employment has the authority to make or give any representation or warranty in respect of the property.

16 London Road, St Albans, Hertfordshire, AL1 1NG
Tel: 01727 581239 Email: sales@spaceestates.com
www.spaceestates.com