



PROPERTY
BUREAU
LETTING & ESTATE AGENTS



Goldcrest Court
Wishaw
ML2 0JE

2 
1 
1 

Offers Over £79,995

A well-presented two-bedroom first-floor flat situated in a quiet, purpose-built development.

The property is finished in low-maintenance facing brick and pebble-dashed render, set beneath a concrete tiled roof with brown fascia, soffits and guttering. Access is via a secure communal entrance serving all apartments.

Surrounding the development are near-level pavements, well-maintained garden areas, and ample resident and visitor parking.

Internally, the flat is in good order throughout and would make an ideal first home.

The accommodation comprises a hallway with a built-in cupboard. The spacious living room features a large window, creating a bright and airy space.



**Home Report Valuation
£85,000**



The modern kitchen is fitted with units along two walls, providing ample worktop space, an integrated hob, oven, fridge, freezer and a stainless steel sink. A washing machine is also included.

There are two double bedrooms, both with modern mirrored sliding wardrobes and large windows.



The bathroom is fitted with a modern white three-piece suite comprising a panelled bath, wash hand basin and W.C., with white tiling and an opaque window.



The property further benefits from gas central heating and quality double-glazed windows.

Vendor Comments

Quiet and handy place to live.

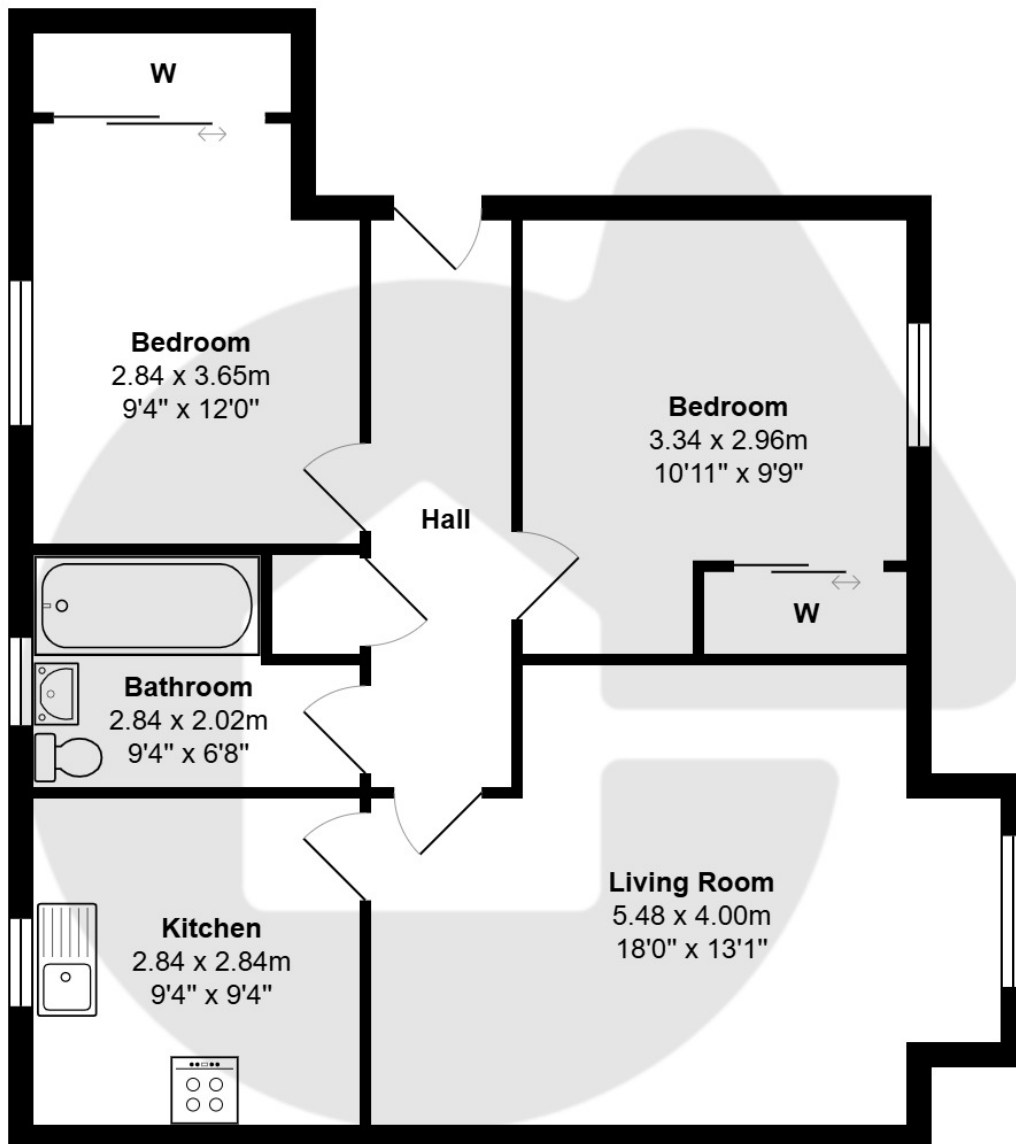

Total Area: 65.2 m² ... 702 ft²

All measurements are approximate and for display purposes only

Location

31 Goldcrest Court is in the popular Coltness area of Wishaw, just a short distance from the town centre with its shops, cafes, and local amenities. It's well connected, with regular trains from Wishaw Station to Glasgow and easy access to the A71, A73, and M74. Nearby parks like Belhaven offer great outdoor space to enjoy





www.propertybureau.co.uk

Glasgow Stirling Helensburgh **Lanarkshire**

13 Broomknoll Street, Lanarkshire, ML6 6BN

enquiries@propertybureau.co.uk
01236 758111

Whilst this brochure has been prepared with care, it is not a report on the condition of the property. Its terms are not warranted and do not constitute an offer to sell. All area and room measurements are approximate only. Floorplans may not be to scale.

