





Millgate Road

ML3 8JX

2 
1 
1 

Offers Over £69,995

An impressive and well presented two bedroom upper cottage flat in Hamilton.

The property itself is finished with low-maintenance pebble dashed render and red facing bricks at the base, set beneath a concrete tiled roof with black guttering and white PVC fascia and soffits. The property is accessible via a main PVC door.

Surrounding the property are near-level pavements, lawned areas and ample resident and visitor parking spaces on the main road.

Internally the flat is in fantastic condition and would make an ideal home for a small family or couple.



Home Report Valuation
£75,000

Council Tax Band A

EPC Rating D



The accomodation comprises a hallway with a large walk in cupboard.

The living room is spacious with a large window making it a very bright room. There is also an electric fire.

Modern kitchen with units along two walls, ample worktop space, integrated hob oven and stainless steel sink.



Bedroom with a large window, with two cupboards for storage.

The second bedroom also has a large window.



The property further benefits from double glazing windows, gas central heating and a large back garden,

Vendor Comments

I will miss this house as it is located in a great area.

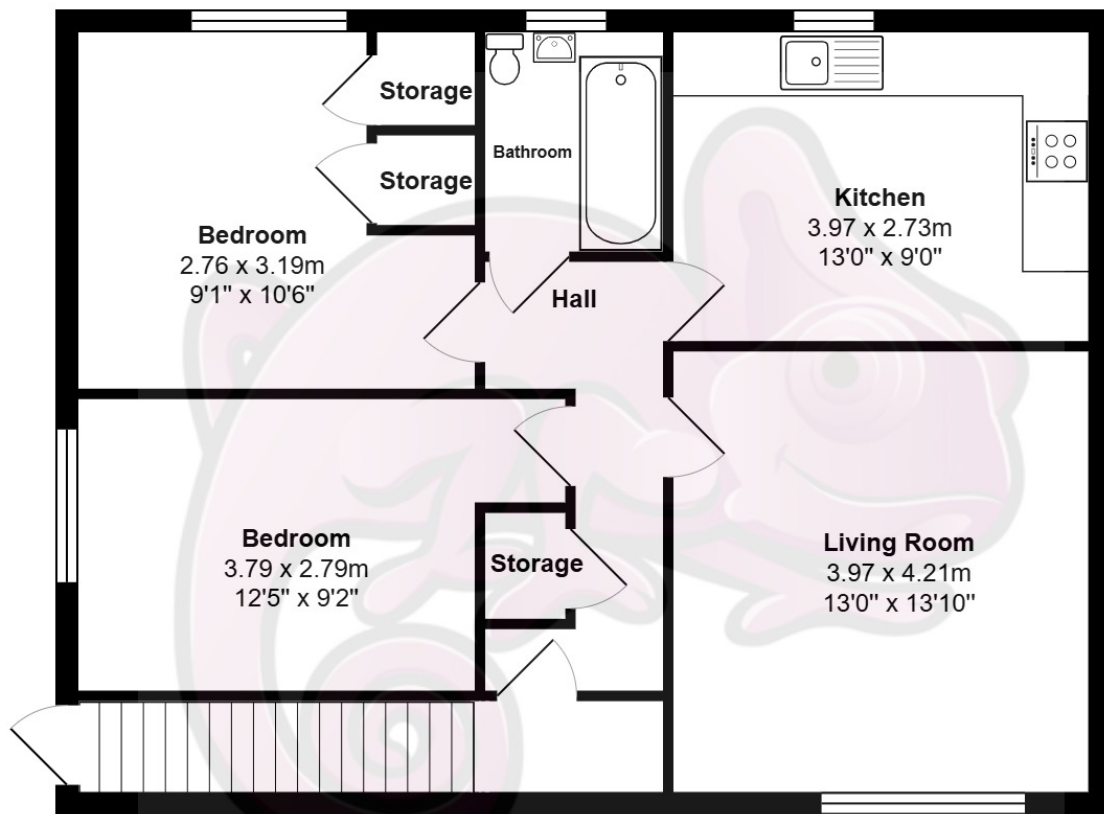

Total Area: 70.1 m² ... 755 ft²

All measurements are approximate and for display purposes only

Location

The property is conveniently located just a ten minute drive from the M74 providing easy access to Glasgow and beyond. The property is also nearby local ammenities such as bars, restraunts and supermarket. Woodhead primary school is a 15 minute walk from the property.





www.propertybureau.co.uk

Glasgow Stirling Helensburgh **Lanarkshire**

13 Broomknoll Street, Lanarkshire, ML6 6BN

enquiries@propertybureau.co.uk
01236 758111

Whilst this brochure has been prepared with care, it is not a report on the condition of the property. Its terms are not warranted and do not constitute an offer to sell. All area and room measurements are approximate only. Floorplans may not be to scale.

