



Craigdhu Avenue
Airdrie
ML6 8EN

2 
1 
1 

Offers Over £152,000

Property Bureau are delighted to bring to the market this fantastic two bedroom semi-detached house, situated within the ever popular Craigdhu Ave Airdrie.

Internally the property comprises of entrance vestibule, bright spacious lounge with street facing views, modern kitchen/diner which includes a range of base and wall mounted units, with contemporary work surfaces and integrated Under Counter Fridge and Freezer.

The kitchen allows access to low maintenance rear garden.

An open plan staircase from the lounge grants access to the upper level which consists of two tastefully decorated double bedrooms, also on the upper level you will find a modern shower room.



Home Report Valuation
£155,000



Heating is provided by a gas central heating system and UPVC double glazing is installed throughout.

The property benefits from a large driveway and garage with electric door which provides off street parking.

To the front of the property you will find a manageable well maintained garden .

This property would make an ideal purchase for any first time buyer or someone looking to downsize. Viewing strictly by appointment only.



Vendor Comments

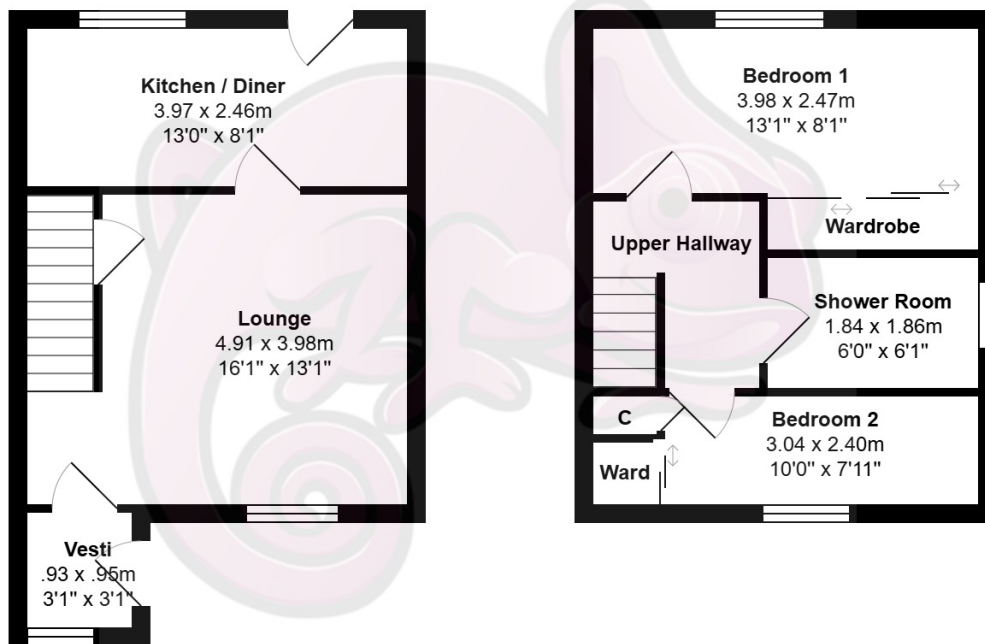

Location

Criagdhu Ave is well positioned for primary & secondary schools, Drumgelloch train station is a short walk away which allows travel both east and west to Edinburgh & Glasgow.

The property is located within easy access to the M8 motorway providing a gateway to the busy central belt link.

Airdrie Town Centre is a short drive /bus ride away where you will find a wealth of bars, restaurants, shopping and leisure facilities.



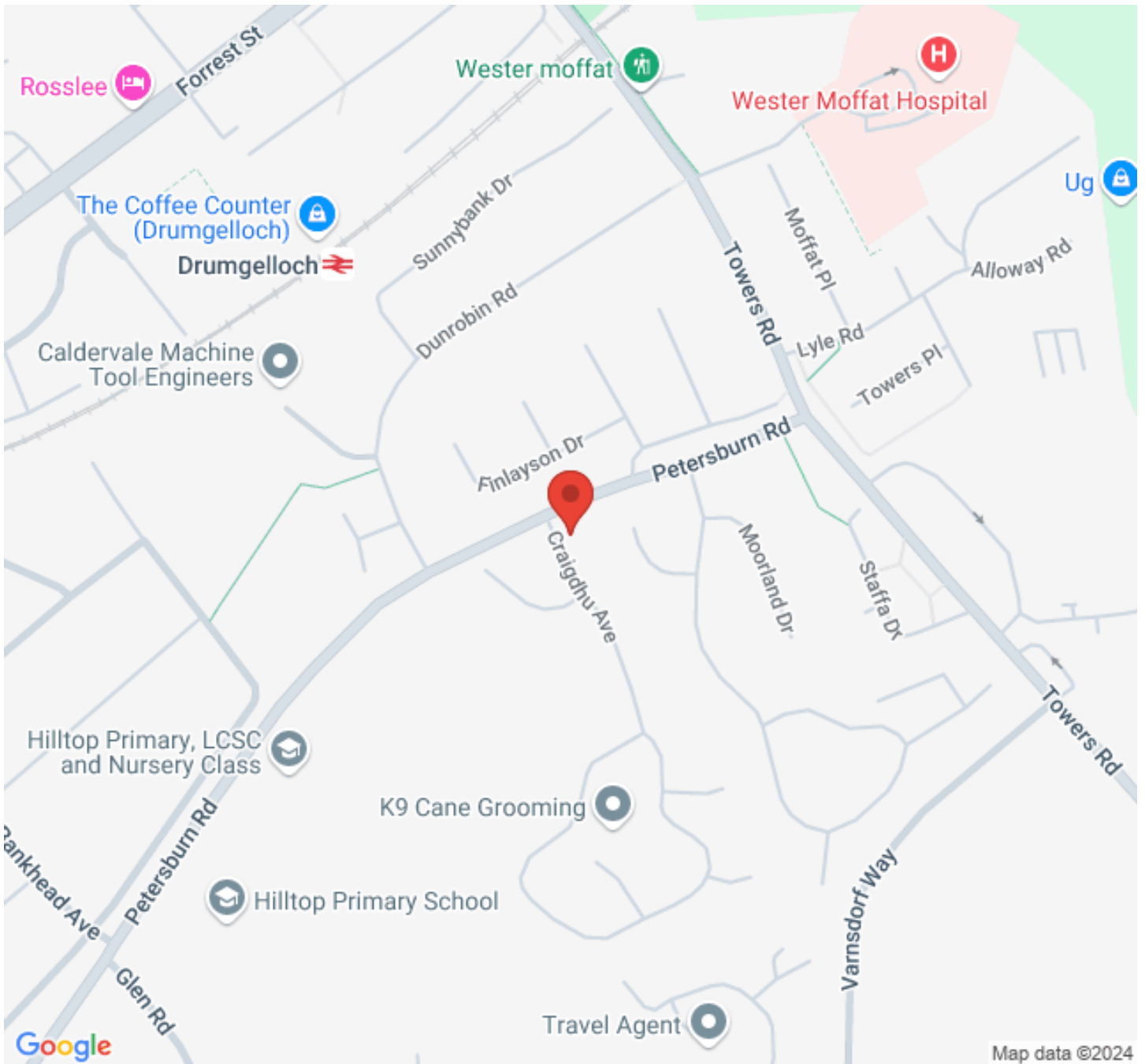

www.propertybureau.co.uk

Glasgow Stirling Helensburgh **Lanarkshire**

13 Broomknoll Street, Lanarkshire, ML6 6BN

**enquiries@propertybureau.co.uk
01236 758111**

Whilst this brochure has been prepared with care, it is not a report on the condition of the property. Its terms are not warranted and do not constitute an offer to sell. All area and room measurements are approximate only. Floorplans may not be to scale.

