



Craigmill Place
Motherwell
ML1 2GD

4 
1 
3 

Offers Over £284,995

Property Bureau are delighted to offer this spacious four bedroom detached family home within the popular Ravenscraig area of Motherwell to the market.

With accommodation to include, lounge, kitchen, utility area and cloakroom on the ground floor the upper accommodation is accessed via an open stairway to an upper hall with storage space and attic access.

This area provides access to the four bedrooms with master en suite and bathroom.



Home Report Valuation
£290,000

Council Tax Band E

EPC Rating B



The property further offers a wide driveway to an integral garage.

Transport.

Both motorways of the M74, Glasgow to The South and the M8 Glasgow to Edinburgh are but a short drive away. There are park and ride facilities at both Motherwell and Wishaw train stations.

A front garden and good sized enclosed rear garden.

The property is completed with gas central heating and double glazing throughout.



Vendor Comments

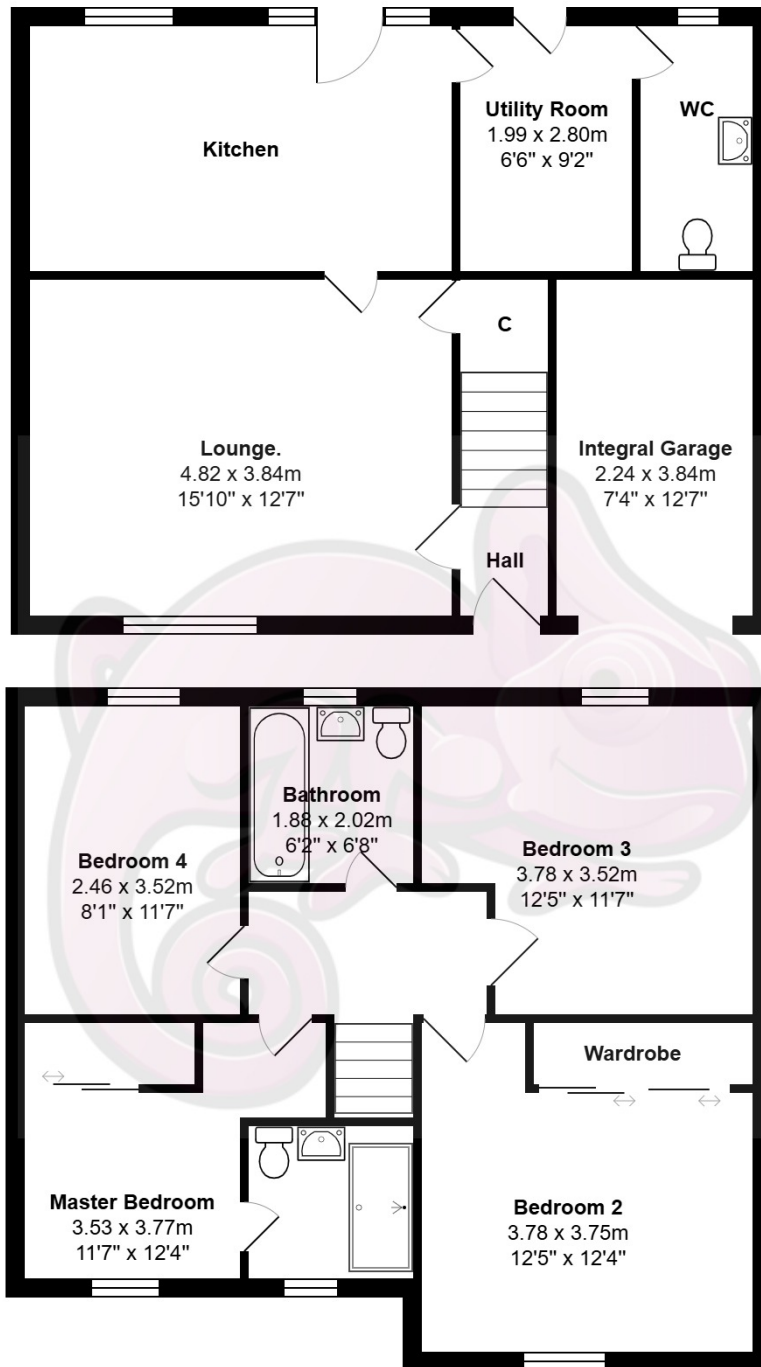

Location

The property is located within the Barratt development within the Ravenscraig district of Motherwell. Close to the regional sports facility of Ravenscraig sports hall. The Motherwell College is but a five-minute drive away with the towns of both Motherwell and Wishaw easily accessible.



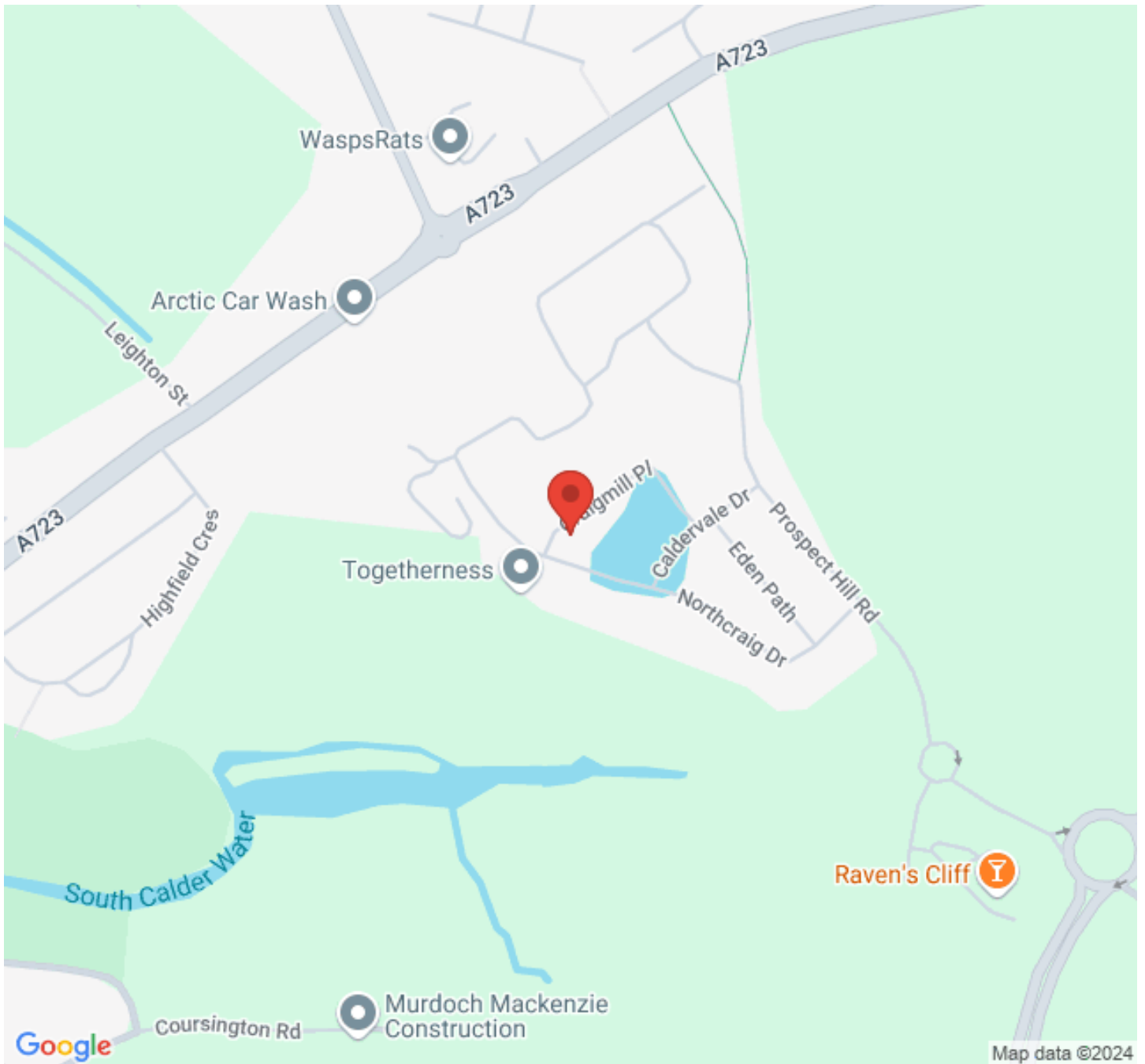

www.propertybureau.co.uk

Glasgow Stirling Helensburgh **Lanarkshire**

13 Broomknoll Street, Lanarkshire, ML6 6BN

**enquiries@propertybureau.co.uk
01236 758111**

Whilst this brochure has been prepared with care, it is not a report on the condition of the property. Its terms are not warranted and do not constitute an offer to sell. All area and room measurements are approximate only. Floorplans may not be to scale.

