





11 Iddesleigh Avenue  
Glasgow  
G62 8NT

1   
1   
1 



## Offers Over £84,995

Property Bureau are delighted to offer to the open market a spacious first floor apartment located within the extremely popular village of Milngavie. The property is located within walking distance of all the social and civil amenities that the area has to offer.

The accommodation on offer is located at the end of a cul de sac within a quiet area.



Home Report Valuation  
£90,000

Council Tax Band C

EPC Rating C





Located on the first floor the apartment offers a communal stairway up a well-lit area to the property.

Accessed via a timber doorway to a spacious hallway with a large walk-in cupboard, lounge, bathroom, double bedroom, kitchen, and bathroom.

The property offers gas central heating and double glazing throughout with on street parking and a well-maintained communal garden.

The property does require a degree of modernisation throughout and is reflected in the asking price.



## Vendor Comments

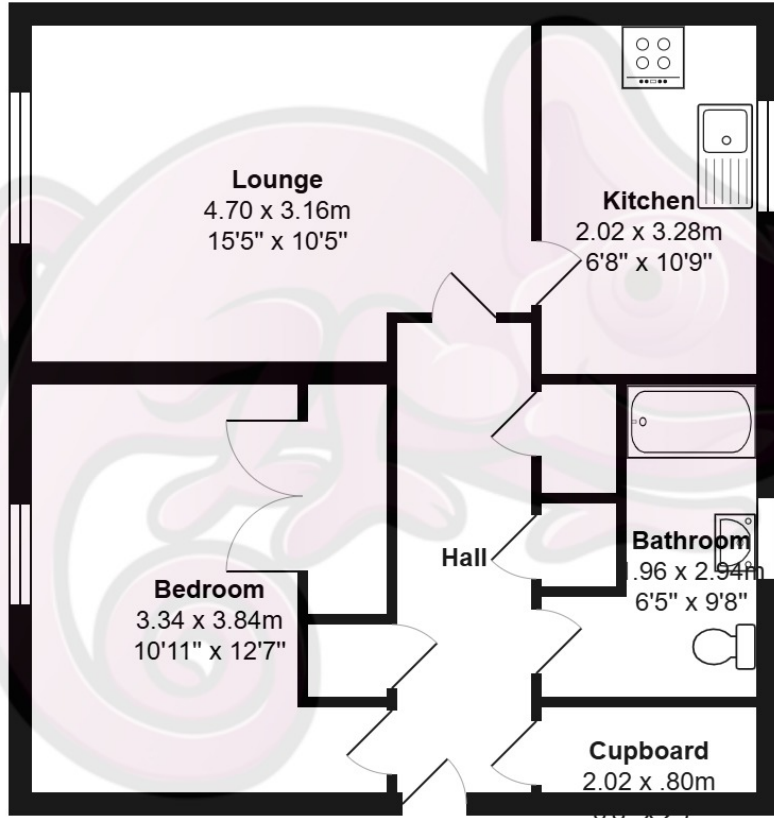

Location





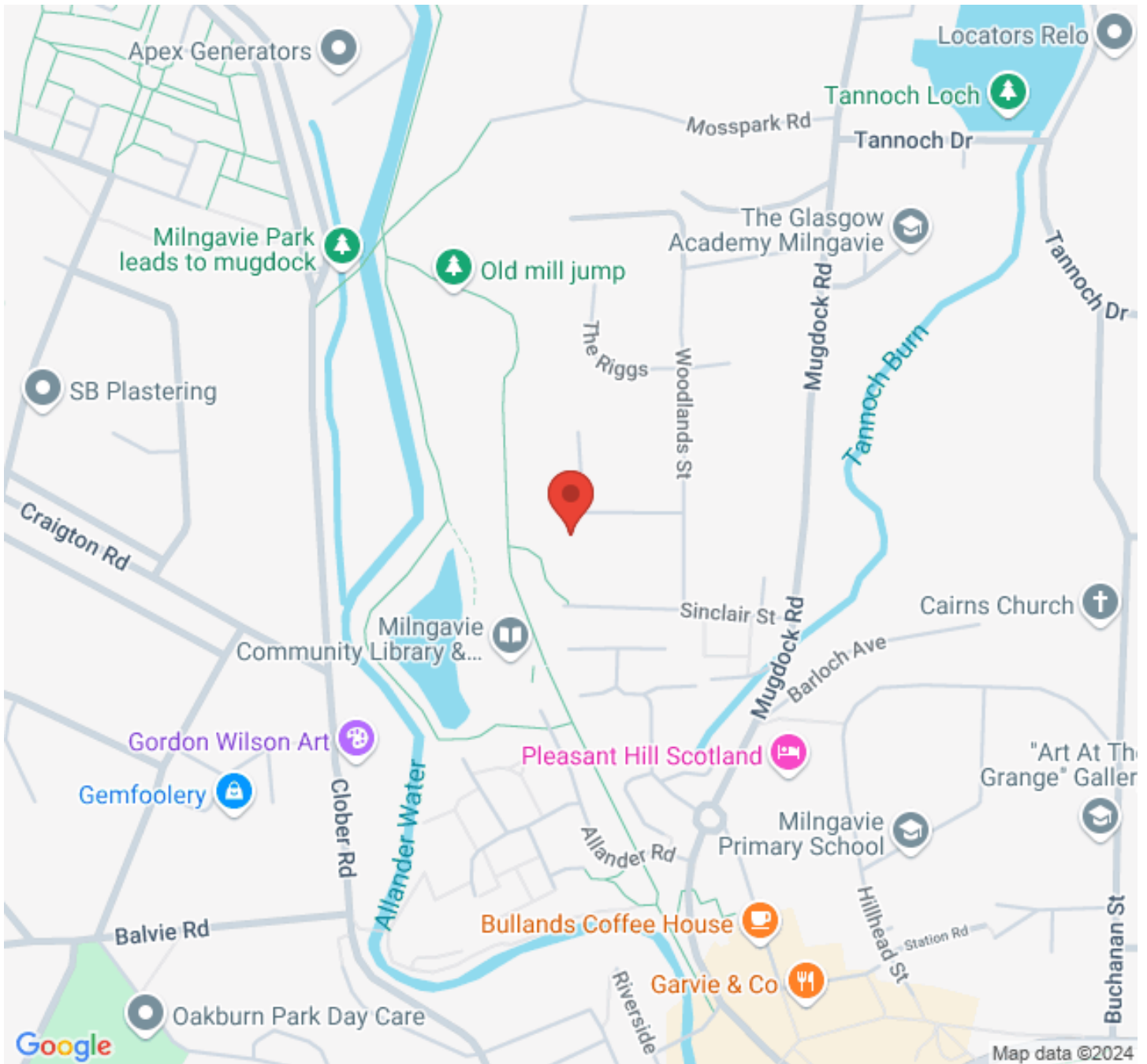

[www.propertybureau.co.uk](http://www.propertybureau.co.uk)

Glasgow   Stirling   Helensburgh   **Lanarkshire**

**13 Broomknoll Street, Lanarkshire, ML6 6BN**

**[enquiries@propertybureau.co.uk](mailto:enquiries@propertybureau.co.uk)  
01236 758111**

Whilst this brochure has been prepared with care, it is not a report on the condition of the property. Its terms are not warranted and do not constitute an offer to sell. All area and room measurements are approximate only. Floorplans may not be to scale.

